

**PLEASE CHECK WWW.MOLEX.COM FOR LATEST PART INFORMATION**

**Part Number:** [62201-8672](#)  
**Status:** **Active**  
**Description:** Vertical Receptacle Press-In Tool

**Documents:**  
[RoHS Certificate of Compliance \(PDF\)](#)

**General**

Product Family	Application Tooling
Series	T9999
Comments	See Tooling Specification (PDF) Above, Press-In Tool
Function	Insertion
Geographic Area	Global
Level of Automation	Manual
More Detailed Tech Information	<a href="mailto:applicationtooling@molex.com">applicationtooling@molex.com</a>
Product Name	PremiumGrade™
Survey	<a href="http://www.molex.com//review/apptool_survey.html">www.molex.com//review/apptool_survey.html</a>
Tool Type	Handtool
UPC	883906174828

**Physical**

Net Weight 38.900/g

**Material Info**

**Reference - Drawing Numbers**

Application Tooling Documents [ATS-622018672, TM-622022099](#)

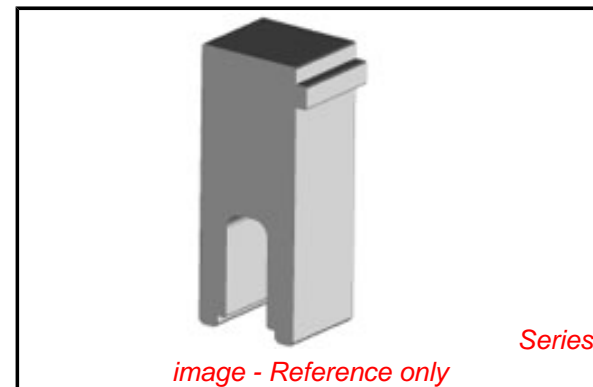

*image - Reference only*

**EU RoHS**

**ELV and RoHS  
Compliant**

**REACH SVHC**

Not Reviewed

**Low-Halogen Status**

Not Reviewed

**China RoHS**



**Need more information on product  
environmental compliance?**

Email [productcompliance@molex.com](mailto:productcompliance@molex.com)  
 For a multiple part number RoHS Certificate of  
 Compliance, [click here](#)

Please visit the [Contact Us](#) section for any  
 non-product compliance questions.

**Search Parts in this Series**

[T9999Series](#)

**Use With**

[LPH Vertical Receptacle 46114 Series](#)

**Application Tooling | FAQ**

Description	Product #
1.27mm, 12.00mm Pitch, EXTreme LPHPower™ Receptacle Header, Vertical, 10 Power Contacts, 12 Signal Contacts, Select Gold (Au) Plating, with BMI Guides	0461141012
1.27mm, 12.00mm Pitch, EXTreme LPHPower™ Receptacle Header, Vertical, 10 Power Contacts, 12 Signal Contacts, Select	0461141013

Gold (Au) Plating, without BMI Guides 1.27mm, 12.00mm Pitch, EXTreme LPHPower™ Receptacle Header, Vertical, 10 Power Contacts, 16 Signal Contacts, Select Gold (Au) Plating, with BMI Guides 1.27mm, 12.00mm Pitch, EXTreme LPHPower™ Receptacle Header, Vertical, 10 Power Contacts, 16 Signal Contacts, Select Gold (Au) Plating, without BMI Guides 1.27mm, 12.00mm Pitch, EXTreme LPHPower™ Receptacle Header, Vertical, 10 Power Contacts, 38 Signal Contacts, Select Gold (Au) Plating, with BMI Guides 1.27mm, 12.00mm Pitch, EXTreme LPHPower™ Receptacle Header, Vertical, 10 Power Contacts, 38 Signal Contacts, Select Gold (Au) Plating, without BMI Guides 1.27mm, 12.00mm Pitch, EXTreme LPHPower™ Receptacle Header, Vertical, 10 Power Contacts, 36 Signal Contacts, Select Gold (Au) Plating, with BMI Guides 1.27mm, 12.00mm Pitch, EXTreme LPHPower™ Receptacle Header, Vertical, 10 Power Contacts, 36 Signal Contacts, Select Gold (Au) Plating, without BMI Guides 1.27mm, 12.00mm Pitch, EXTreme LPHPower™ Receptacle Header, Vertical, Compliant Pin, 12 Power Contacts, 12 Signal Contacts, Select	0461141016 0461141017 0461141032 0461141033 0461141036 0461141037 0461141212
--	--

Gold (Au) Plating,  
with BMI Guides  
1.27mm, 12.00mm 0461141213  
Pitch, EXTreme  
LPHPower™  
Receptacle Header,  
Vertical, Compliant  
Pin, 12 Power  
Contacts, 12 Signal  
Contacts, Select  
Gold (Au) Plating,  
without BMI Guides  
1.27mm, 12.00mm 0461141216  
Pitch, EXTreme  
LPHPower™  
Receptacle Header,  
Vertical, Compliant  
Pin, 12 Power  
Contacts, 16 Signal  
Contacts, Select  
Gold (Au) Plating,  
with BMI Guides  
1.27mm, 12.00mm 0461141217  
Pitch, EXTreme  
LPHPower™  
Receptacle Header,  
Vertical, Compliant  
Pin, 12 Power  
Contacts, 16 Signal  
Contacts, Select  
Gold (Au) Plating,  
without BMI Guides  
1.27mm, 12.00mm 0461141232  
Pitch, EXTreme  
LPHPower™  
Receptacle Header,  
Vertical, Compliant  
Pin, 12 Power  
Contacts, 32 Signal  
Contacts, Select  
Gold (Au) Plating,  
with BMI Guides  
1.27mm, 12.00mm 0461141233  
Pitch, EXTreme  
LPHPower™  
Receptacle Header,  
Vertical, Compliant  
Pin, 12 Power  
Contacts, 32 Signal  
Contacts, Select  
Gold (Au) Plating,  
without BMI Guides  
1.27mm, 12.00mm 0461141236  
Pitch, EXTreme  
LPHPower™  
Receptacle Header,  
Vertical, Compliant  
Pin, 12 Power  
Contacts, 36 Signal  
Contacts, Select  
Gold (Au) Plating,  
with BMI Guides  
1.27mm, 12.00mm 0461141237  
Pitch, EXTreme  
LPHPower™

Receptacle Header,  
Vertical, Compliant  
Pin, 12 Power  
Contacts, 36 Signal  
Contacts, Select  
Gold (Au) Plating,  
without BMI Guides  
1.27mm, 12.00mm 0461141412  
Pitch, EXTreme  
LPHPower™

Receptacle Header,  
Vertical, Compliant  
Pin, 14 Power  
Contacts, 12 Signal  
Contacts, Select  
Gold (Au) Plating,  
with BMI Guides  
1.27mm, 12.00mm 0461141413  
Pitch, EXTreme  
LPHPower™

Receptacle Header,  
Vertical, Compliant  
Pin, 14 Power  
Contacts, 12 Signal  
Contacts, Select  
Gold (Au) Plating,  
without BMI Guides  
1.27mm, 12.00mm 0461141416  
Pitch, EXTreme  
LPHPower™

Receptacle Header,  
Vertical, Compliant  
Pin, 14 Power  
Contacts, 16 Signal  
Contacts, Select  
Gold (Au) Plating,  
with BMI Guides  
1.27mm, 12.00mm 0461141417  
Pitch, EXTreme  
LPHPower™

Receptacle Header,  
Vertical, Compliant  
Pin, 14 Power  
Contacts, 16 Signal  
Contacts, Select  
Gold (Au) Plating,  
without BMI Guides  
1.27mm, 12.00mm 0461141432  
Pitch, EXTreme  
LPHPower™

Receptacle Header,  
Vertical, Compliant  
Pin, 14 Power  
Contacts, 32 Signal  
Contacts, Select  
Gold (Au) Plating,  
with BMI Guides  
1.27mm, 12.00mm 0461141433  
Pitch, EXTreme  
LPHPower™

Receptacle Header,  
Vertical, Compliant  
Pin, 14 Power  
Contacts, 32 Signal  
Contacts, Select





1.27mm, 12.00mm	0461144320
Pitch, EXTreme	
LPHPower™	
Receptacle Header,	
Vertical, 4 Power	
Contacts, 32 Signal	
Contacts, Select	
Gold (Au) Plating,	
with BMI Guides	
1.27mm, 12.00mm	0461144321
Pitch, EXTreme	
LPHPower™	
Receptacle Header,	
Vertical, 4 Power	
Contacts, 32 Signal	
Contacts, Select	
Gold (Au) Plating,	
without BMI Guides	
1.27mm, 12.00mm	0461144360
Pitch, EXTreme	
LPHPower™	
Receptacle Header,	
Vertical, 4 Power	
Contacts, 36 Signal	
Contacts, Select	
Gold (Au) Plating,	
with BMI Guides	
1.27mm, 12.00mm	0461144361
Pitch, EXTreme	
LPHPower™	
Receptacle Header,	
Vertical, 4 Power	
Contacts, 36 Signal	
Contacts, Select	
Gold (Au) Plating,	
without BMI Guides	
1.27mm, 12.00mm	0461146120
Pitch, EXTreme	
LPHPower™	
Receptacle Header,	
Vertical, 6 Power	
Contacts, 12 Signal	
Contacts, Select	
Gold (Au) Plating,	
with BMI Guides	
1.27mm, 12.00mm	0461146121
Pitch, EXTreme	
LPHPower™	
Receptacle Header,	
Vertical, 6 Power	
Contacts, 12 Signal	
Contacts, Select	
Gold (Au) Plating,	
without BMI Guides	
1.27mm, 12.00mm	0461146160
Pitch, EXTreme	
LPHPower™	
Receptacle Header,	
Vertical, 6 Power	
Contacts, 16 Signal	
Contacts, Select	
Gold (Au) Plating,	
with BMI Guides	
1.27mm, 12.00mm	0461146161
Pitch, EXTreme	

LPHPower™  
Receptacle Header,  
Vertical, 6 Power  
Contacts, 16 Signal  
Contacts, Select  
Gold (Au) Plating,  
without BMI Guides  
1.27mm, 12.00mm 0461146320  
Pitch, EXTreme

LPHPower™  
Receptacle Header,  
Vertical, 6 Power  
Contacts, 32 Signal  
Contacts, Select  
Gold (Au) Plating,  
with BMI Guides  
1.27mm, 12.00mm 0461146321  
Pitch, EXTreme

LPHPower™  
Receptacle Header,  
Vertical, 6 Power  
Contacts, 32 Signal  
Contacts, Select  
Gold (Au) Plating,  
without BMI Guides  
1.27mm, 12.00mm 0461146360  
Pitch, EXTreme

LPHPower™  
Receptacle Header,  
Vertical, 6 Power  
Contacts, 36 Signal  
Contacts, Select  
Gold (Au) Plating,  
with BMI Guides  
1.27mm, 12.00mm 0461146361  
Pitch, EXTreme

LPHPower™  
Receptacle Header,  
Vertical, 6 Power  
Contacts, 36 Signal  
Contacts, Select  
Gold (Au) Plating,  
without BMI Guides  
1.27mm, 12.00mm 0461148120  
Pitch, EXTreme

LPHPower™  
Receptacle Header,  
Vertical, Compliant  
Pin, 8 Power  
Contacts, 12 Signal  
Contacts, Select  
Gold (Au) Plating,  
with BMI Guides  
1.27mm, 12.00mm 0461148121  
Pitch, EXTreme

LPHPower™  
Receptacle Header,  
Vertical, Compliant  
Pin, 8 Power  
Contacts, 12 Signal  
Contacts, Select  
Gold (Au) Plating,  
without BMI Guides

This document was generated on 05/20/2013

**PLEASE CHECK [WWW.MOLEX.COM](http://WWW.MOLEX.COM) FOR LATEST PART INFORMATION**