

Actuator

61-1300.0



<https://eao.com/p/61-1300.0>

Your product:



61-1300.0 Actuator

OPERATING-/INDICATION PART

Lens illumination: illuminative

MECHANICAL CHARACTERISTIC

Operating Travel: 3 mm

Weight: 0.005 kg

Switching action: Maintained or momentary

Mechanical lifetime: According to DIN/IEC 60512-5-6 and EN/IEC 60947-5-1, 1 Mio. cycles of operation (maintain), 2 Mio. cycles of operation (momentary)

Operating force: 3 N ... 5 N snap-action switching element, 3.5 ... 11 N slow-make switching element

Tightening torque: Max. 0.5 Nm

AMBIENT CONDITION

IP Protection: IP40 rear side, according to EN IEC 60529, IP67 front side, according to EN IEC 60529

Storage temperature: - 40 °C ... + 85 °C

OTHER

Short Description: Actuator, illuminative, Maintained or momentary

Housing colour: Black

Housing material: Plastic, according to UL 94 V0, self-extinguishing

Dimension drawings:

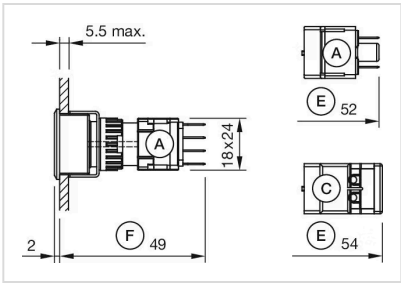

Wiring diagrams:

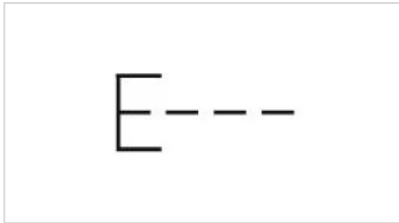

Mounting cut-outs:

