

Actuator

61-1140.0



<https://eao.com/p/61-1140.0>

Your product:



61-1140.0 Actuator

FRONT

Front bezel colour: Black

Front bezel material: Plastic

OPERATING-/INDICATION PART

Lens illumination: illuminative

MECHANICAL CHARACTERISTIC

Operating Travel: 3 mm

Weight: 0.005 kg

Switching action: Momentary

Mechanical lifetime: According to DIN/IEC 60512-5-6 and EN/IEC 60947-5-1, 2 Mio. cycles of operation

Operating force: 3 N ... 5 N snap-action switching element, 3.5 ... 11 N slow-make switching element

Tightening torque: Max. 0.5 Nm

AMBIENT CONDITION

IP Protection: IP40 rear side, according to EN IEC 60529, IP67 front side, according to EN IEC 60529

Storage temperature: - 40 °C ... + 85 °C

OTHER

Housing colour: Black

Housing material: Plastic, according to UL 94 V0, self-extinguishing

Short Description:

Actuator, illuminative, Black, Plastic, Momentary

Dimension drawings:

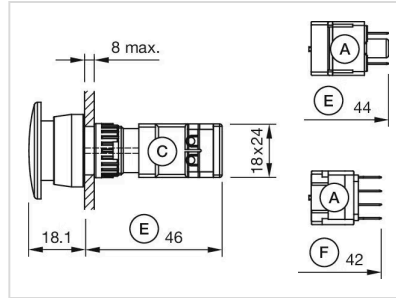

Mounting cut-outs:

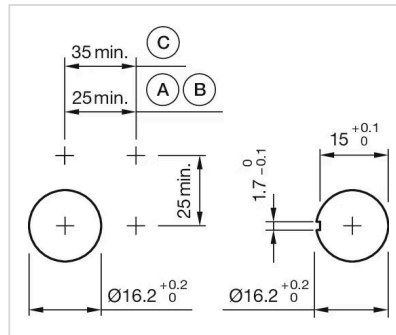

Wiring diagrams:

