



Einsatzbereich: - 723 htec
- 740 htec

TE Teile Nr.: 60-0279-011-P00
IC Ref. Nr.: 60.279.11
SEW-Nr.: 19053959

Elektrische Werte

Bemessungsstrom max. 7 A*
Durchgangswiderstand < 5 mOhm

Werkstoff

Kontakt Messing, vergoldet

Anschluss

Anschlussart/-bereich Crimp/ 0,14 - 1,0 mm²
max. Litzenaußendurchmesser ø2,1 mm
Abisolierlänge 4 mm
Crimpeinstellungen sind individuell zu wählen

Mechanische Werte

Steckzyklen 500

Werkzeuge (nicht im Lieferumfang enthalten)

digitale Crimpzanger TE Teile Nr.: C0-0324-000-P00
IC Ref. Nr.: C0.324.00

Crimpen -kraftunterstützt

Crimpmaschine TE Teile Nr.: WA-1672-000-000
IC Ref. Nr.: WA10672

digitaler Crimpeinsatz, klein TE Teile Nr.: C0-0372-000-P00
IC Ref. Nr.: C0.372.00

Locator für TE Teile Nr.: C0-0372-000-000 TE Teile Nr.: C0-0265-000-P00
IC Ref. Nr.: C0.372.00 IC Ref. Nr.: C0.265.00

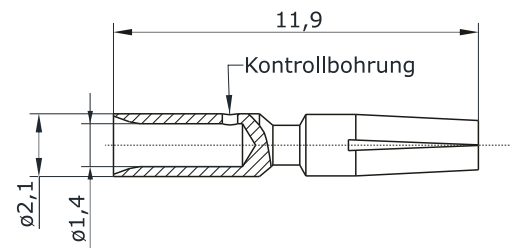

Hauptabmessungen
Kontaktbuchse





Contact Socket 1 mm

for: - 723 htec
- 740 htec

TE part number: 60-0279-011-P00
IC reference number: 60.279.11
SEW code: 19053959

Electrical Data

rated current max. 7 A*
contact resistance < 5 mOhm

Material

contact brass, gold plated

Termination

cross-section crimp/ 0.14 - 1.0 mm²
max. outer wire diameter \varnothing 2.1 mm
stripping length 4 mm
crimp settings select individually

Mechanical Data

mating cycles 500

Tools (not part of product contents)

digital crimping tool TE part no.: C0-0324-000-P00
IC ref. no.: C0.324.00

power crimping

crimping machine TE part no.: WA-1672-000-000
IC ref. no.: Wa10672

digital crimp insert, small TE part no.: C0-0372-000-P00
IC ref. no.: C0.372.00

locator for TE part no.: C0-0372-000-000 TE part no.: C0-0265-000-P00
IC ref. no.: C0.372.00 IC ref. no.: C0.265.00

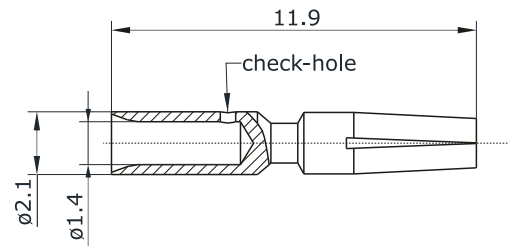

Main Dimensions
contact socket

Y6-D784-000-0EN issued: 02.10.2012/FS; modified: 15.05.2020/VK

© 2020 TE Connectivity

TE Connectivity, TE connectivity (logo), intercontec (logo) and speedtec are trademarks.

While TE Connectivity (TE) has made every reasonable effort to ensure the accuracy of the information in this presentation, TE does not guarantee that it is error-free, nor does TE make any other representation, warranty or guarantee that the information is accurate, correct, reliable or current. TE reserves the right to make any adjustments to the information contained herein at any time without notice. TE expressly disclaims all implied warranties regarding the information contained herein, including, but not limited to, any implied warranties of merchantability or fitness for a particular purpose. The dimensions in this article are for reference purposes only and are subject to change without notice. Specifications are subject to change without notice. Consult TE for the latest dimensions and design specifications.



* for max. wire cross-section