

5550 3200	DATA SHEET	
Valid from: 25.05.2018	SILVYN® LGEF-M	

SILVYN® LGEF-M is a conduit gland made of nickel plated brass and stainless steel and has an integrated sleeve for fixed applications. The gland is suitable for SILVYN® SSUE and can be used in offshore applications and in demanding mechanical environments.



Material:

Stainless steel, AISI 316
Brass, nickel plated

Technical Features:

Connecting thread
Nominal wide
Protection class

M12x1,5 up to M75x1,5 acc. to EN 60423
NW 10 up to NW 75
IP40 acc. to EN 60529
Depending on the used conduit

Temperature range

SILVYN® LGEF-M (Stainless steel) -100°C up to +400°C
SILVYN® LGEF-M (Brass) -50°C up to +300°C

Additional features:

Corrosion resistant



Approbation:

Reference standards:

EN 61386-1

Suitable conduits:

SILVYN® SSUE



For more information please see our current catalogue. Please do not hesitate to contact our laboratory if there are any questions regarding resistance against aggressive agents and special oil.

Creator: MAU1/PDP Released: DAMU1/PDP	Document: DB55503200EN Version: 02	Page 1 of 2
--	---------------------------------------	-------------

5550 3200	DATA SHEET	
Valid from: 25.05.2018	SILVYN® LGEF-M	

Product drawing:

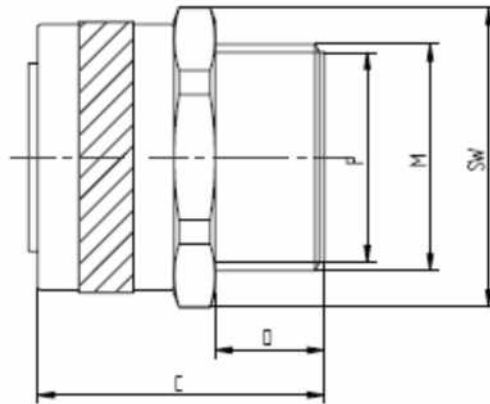

Dimension table:

Part No.	Nominal Wide NW	Thread M	Thread length D mm	Length C mm	Inner Diameter F mm	Wrench size SW
SILVYN® LGEF-M (Stainless steel)						
5550 3200	10	M12x1,5	8,0	21,0	5,6	14
5550 3201	12	M16x1,5	8,0	23,0	8,5	19
5550 3202	16	M16x1,5	10,0	25,0	11,5	19
5550 3203	20	M20x1,5	10,0	26,3	15,3	24
5550 3204	25	M25x1,5	10,0	32,5	19,1	29
5550 3205	32	M32x1,5	13,0	36,8	26,2	38
5550 3206	40	M40x1,5	14,0	39,0	34,6	48
5550 3207	50	M50x1,5	15,0	44,5	44,7	58
SILVYN® LGEF-M (Brass)						
5550 3168	10	M12x1,5	7,0	21,0	5,6	13
5550 3169	12	M16x1,5	10,0	23,0	8,5	17
5550 3170	16	M16x1,5	10,0	25,0	11,5	20
5550 3171	16	M20x1,5	10,0	25,0	11,5	22
5550 3172	20	M20x1,5	10,0	26,3	15,3	24
5550 3173	25	M25x1,5	10,0	29,5	19,1	29
5550 3174	32	M32x1,5	13,0	36,8	26,2	36
5550 3175	40	M40x1,5	14,0	39,0	34,6	48
5550 3176	50	M50x1,5	15,0	42,0	44,7	58
5550 3177	63	M63x1,5	18,0	50,0	54,1	70
5550 3178	75	M75x1,5	20,0	60,0	66,4	84