

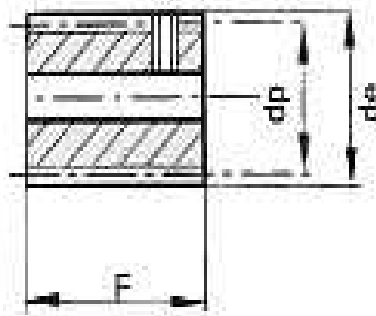

Metric Worms 0.8 Mod – 1 Mod

Steel – En8 or equivalent
 Single (1R) & Double (2R) Start Right Hand
 20 degree p.a.
 Bore Tolerance H7

TYPE D



All Dimensions in mm

Standard tolerances, unless otherwise stated + - 0.25mm

All worms are supplied black oxide finish

They are supplied with a M4 G/S fitted (5mm from one end)

1R = Single Start

2R = Double Start

RS Article no.	Code	Pitch	dp	de	Bore	F	Type
		Module					
5218559	SWB08/1R	0.8	14	15.6	6	30	D
5216812	SWB08/2R	0.8	14	15.6	6	30	D
5216990	SWB10/1R	1	16	18	6	32	D
5216907	SWB10/2R	1	16	18	6	32	D