

Micro-D Backshells Split EMI Backshell

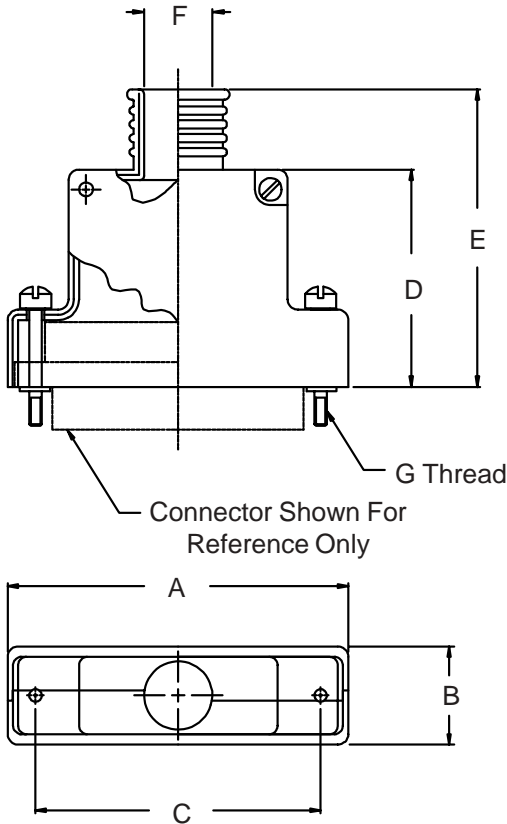

HOW TO ORDER				
Basic Part Number	Shell Plating *	Shell Size (Table I)	Hardware Options *	Band Option
507-145	C – Black Anodize	09	Omit for (2) male fillister head	B 600-057 Band Supplied - (Omit if Not Required)
	E – Chem. Film	15		
	J – Gold Iridite Over Cadmium Over	21	E – (2) extended jackscrew	
	Electroless Nickel	25		
	M – Electroless Nickel	31	H – (2) male hex socket	
	NF – Cadmium, Olive Drab Over	37		
	Electroless Nickel	51	F – (2) female jackpost	
Z2 – Gold	100			
Sample Part Number:				
507-145	M	21	H	B

* SEE PAGE C-2 FOR COMPLETE INFORMATION

TABLE I - DIMENSIONS

SHELL SIZE	A		B		C		D		E		F		G THREAD
	Max		Max		±.005 (0.1)		±.010 (0.3)		±.020 (.5)		±.005 (0.1)		
09	.915	(23.2)	.450	(11.4)	.565	(14.4)	.656	(16.7)	.968	(24.6)	.160	(4.1)	2-56 UNC-2
15	1.065	(27.1)	.450	(11.4)	.715	(18.2)	.718	(18.2)	1.031	(26.2)	.190	(4.8)	2-56 UNC-2
21	1.215	(30.9)	.450	(11.4)	.865	(22.0)	.750	(19.1)	1.062	(27.0)	.220	(5.6)	2-56 UNC-2
25	1.315	(33.4)	.450	(11.4)	.965	(24.5)	.812	(20.6)	1.125	(28.6)	.260	(6.6)	2-56 UNC-2
31	1.465	(37.2)	.450	(11.4)	1.115	(28.3)	.843	(21.4)	1.156	(29.4)	.275	(7.0)	2-56 UNC-2
37	1.615	(41.0)	.450	(11.4)	1.265	(32.1)	.906	(23.0)	1.218	(30.9)	.285	(7.2)	2-56 UNC-2
51	1.565	(39.8)	.495	(12.6)	1.215	(30.9)	.968	(24.6)	1.281	(32.5)	.350	(8.9)	2-56 UNC-2
100	2.305	(58.5)	.540	(13.7)	1.800	(45.7)	1.031	(26.2)	1.343	(34.1)	.490	(12.4)	4-40 UNC-2

Metric dimensions (mm) are indicated in parentheses.