

“Stay Connected” with



Liquid Tight Cordgrips

a PennEngineering® Company



Heyco® -Tite Brass Liquid Tight Cordgrips

Straight-Thru, Pg Hubs

The Ultimate in Liquid Tight Strain Relief Protection

- Nickel plated brass construction for superior protection of flexible cables.
- Nickel-plated finish over brass provides excellent corrosion resistance and durability.
- IP 68 rated.
- For use in clearance or threaded holes.
- Long PG threads provide additional threads for easy locknut assembly.
- Multiple sizes for flexible cord diameters ranging from .138" (3,5 mm) to 1.378" (35,0 mm).
- We recommend using the smallest cordgrip that accommodates your cable size.
- Sealing gland is molded in Thermoplastic Polymer Elastomer (TPE) Material.
- **Locknuts not included.** For metal locknut specifications or to order locknuts separately, see page 3-48.
- DFARS Compliant

| CABLE DIA. RANGE | | | | PART NO. | THREAD SIZE | UL or IEC | PART DIMENSIONS | | | | | | | |
|------------------|-----|---------|-----|----------|-------------|-----------|-----------------------|--------------------|-----|-----------------|-----|---------------------------|--|--|
| Minimum | | Maximum | | | | | A Clearance Hole Dia. | B Max. O.A. Length | | C Thread Length | | D Wrenching Nut Flat Size | | |
| in. | mm. | in. | mm. | | in. | mm. | in. | mm. | in. | mm. | in. | mm. | | |

Standard Thread

| | | | | | | | | | | | | | | |
|-------|------|-------|------|-------------|---------|-------|-------|------|-------|------|-----|------|------|------|
| .138 | 3,5 | .197 | 5,0 | 4530 | PG 7 | cULUS | .492 | 12,5 | 1.063 | 27,0 | .39 | 10,0 | .59 | 15,0 |
| .197 | 5,0 | .256 | 6,5 | 4531 | | | | | | | | | | |
| .256 | 6,5 | .315 | 8,0 | 4532 | | | | | | | | | | |
| .138 | 3,5 | .177 | 4,5 | 4533 | PG 9 | cULUS | .598 | 15,2 | 1.18 | 30,0 | .39 | 10,0 | .71 | 18,0 |
| .177 | 4,5 | .236 | 6,0 | 4534 | | | | | | | | | | |
| .236 | 6,0 | .315 | 8,0 | 4535 | | | | | | | | | | |
| .315 | 8,0 | .413 | 10,5 | 4536 | PG 9 | cULUS | .598 | 15,2 | 1.26 | 32,0 | | | | |
| .157 | 4,0 | .217 | 5,5 | 4537 | PG 11 | cULUS | .732 | 18,6 | 1.22 | 31,0 | .39 | 10,0 | .83 | 21,0 |
| .217 | 5,5 | .335 | 8,5 | 4538 | | | | | | | | | | |
| .335 | 8,5 | .472 | 12,0 | 4539 | | | | | | | | | | |
| .236 | 6,0 | .315 | 8,0 | 4540 | PG 13.5 | cULUS | .827 | 21,0 | 1.22 | 31,0 | .39 | 10,0 | .94 | 24,0 |
| .315 | 8,0 | .433 | 11,0 | 4541 | | | | | | | | | | |
| .433 | 11,0 | .591 | 15,0 | 4542 | | | | | | | | | | |
| .236 | 6,0 | .315 | 8,0 | 4543 | PG 16 | cULUS | .886 | 22,5 | 1.30 | 33,0 | .39 | 10,0 | .94 | 24,0 |
| .315 | 8,0 | .433 | 11,0 | 4544 | | | | | | | | | | |
| .433 | 11,0 | .591 | 15,0 | 4545 | | | | | | | | | | |
| .374 | 9,5 | .492 | 12,5 | 4546 | PG 21 | cULUS | 1.114 | 28,3 | 1.57 | 40,0 | .47 | 12,0 | 1.18 | 30,0 |
| .492 | 12,5 | .630 | 16,0 | 4547 | | | | | | | | | | |
| .630 | 16,0 | .807 | 20,5 | 4548 | | | | | | | | | | |
| .630 | 16,0 | .748 | 19,0 | 4549 | PG 29 | cULUS | 1.469 | 37,3 | 1.57 | 40,0 | .47 | 12,0 | 1.50 | 38,0 |
| .748 | 19,0 | .905 | 23,0 | 4550 | | | | | | | | | | |
| .906 | 23,0 | 1.083 | 27,5 | 4551 | | | | | | | | | | |
| .846 | 21,5 | 1.024 | 26,0 | 4552 | PG 36 | cULUS | 1.874 | 47,6 | 1.85 | 47,0 | .59 | 15,0 | 1.97 | 50,0 |
| 1.024 | 26,0 | 1.201 | 30,5 | 4553 | | | | | | | | | | |
| 1.201 | 30,5 | 1.378 | 35,0 | 4554 | | | | | | | | | | |

Short Thread

ALL NEW PRODUCTS

| | | | | | | | | | | | | | | |
|-------|------|-------|------|--------------|---------|-------|-------|------|------|------|-----|-----|------|------|
| .138 | 3,5 | .197 | 5,0 | 14530 | PG 7 | cULUS | .492 | 12,5 | .91 | 23,0 | .24 | 6,0 | .59 | 15,0 |
| .197 | 5,0 | .256 | 6,5 | 14531 | | | | | | | | | | |
| .256 | 6,5 | .315 | 8,0 | 14532 | | | | | | | | | | |
| .177 | 4,5 | .236 | 6,0 | 14534 | PG 9 | cULUS | .598 | 15,2 | 1.02 | 26,0 | .24 | 6,0 | .71 | 18,0 |
| .236 | 6,0 | .315 | 8,0 | 14535 | | | | | | | | | | |
| .315 | 8,0 | .413 | 10,5 | 14536 | | | | | | | | | | |
| .157 | 4,0 | .217 | 5,5 | 14537 | PG 11 | cULUS | .732 | 18,6 | 1.06 | 27,0 | .24 | 6,0 | .83 | 21,0 |
| .217 | 5,5 | .335 | 8,5 | 14538 | | | | | | | | | | |
| .335 | 8,5 | .472 | 12,0 | 14539 | | | | | | | | | | |
| .236 | 6,0 | .315 | 8,0 | 14540 | PG 13.5 | cULUS | .803 | 20,4 | 1.06 | 27,0 | .24 | 6,0 | .94 | 24,0 |
| .315 | 8,0 | .433 | 11,0 | 14541 | | | | | | | | | | |
| .433 | 11,0 | .591 | 15,0 | 14542 | | | | | | | | | | |
| .236 | 6,0 | .315 | 8,0 | 14543 | PG 16 | cULUS | .886 | 22,5 | 1.14 | 29,0 | .24 | 6,0 | .94 | 24,0 |
| .315 | 8,0 | .433 | 11,0 | 14544 | | | | | | | | | | |
| .433 | 11,0 | .591 | 15,0 | 14545 | | | | | | | | | | |
| .374 | 9,5 | .492 | 12,5 | 14546 | PG 21 | cULUS | 1.114 | 28,3 | 1.40 | 35,5 | .30 | 7,5 | 1.18 | 30,0 |
| .492 | 12,5 | .630 | 16,0 | 14547 | | | | | | | | | | |
| .630 | 16,0 | .807 | 20,5 | 14548 | | | | | | | | | | |
| .748 | 19,0 | .906 | 23,0 | 14550 | PG 29 | cULUS | 1.469 | 37,3 | 1.42 | 36,0 | .32 | 8,0 | 1.50 | 38,0 |
| .906 | 23,0 | 1.083 | 27,5 | 14551 | | | | | | | | | | |
| 1.024 | 26,0 | 1.201 | 30,5 | 14553 | | | | | | | | | | |
| 1.201 | 30,5 | 1.378 | 35,0 | 14554 | PG 36 | cULUS | 1.874 | 47,6 | 1.85 | 47,0 | .32 | 8,0 | 1.97 | 50,0 |

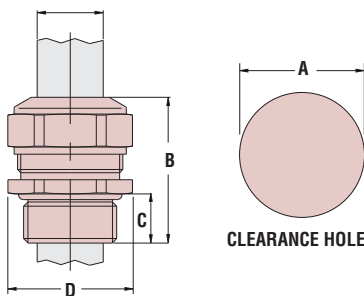

Quick Specs

| | |
|-------------------|--|
| Material | Nickel-Plated Brass w/TPE Sealing Gland |
| Certifications | cULUS Certified by UL for Compliance with both Canadian and U.S. requirements under File E51579. |
| | cULUS Recognized under the Component Program of Underwriters' Laboratories File E51579 to both Canadian and U.S. requirements. |
| Temperature Range | -40°F (-40°C) to 212°F (100°C) |
| IP Rating | IP 68, IP 69K |