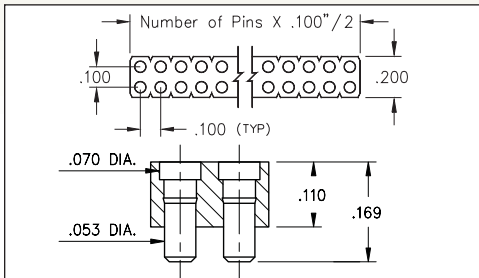


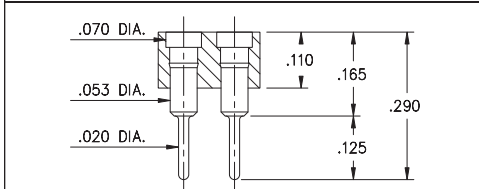
# SPRING-LOADED CONNECTORS

## SERIES 419, 430, 499 • .100" GRID TARGET CONNECTORS FOR SPRING-LOADED ASSEMBLIES • DOUBLE ROW STRIPS

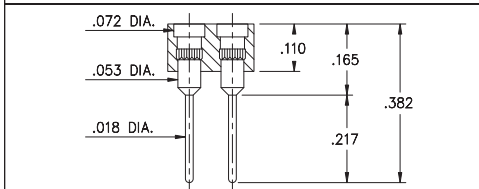


Coplanarity .005". For Pin counts >20 positions, consult Technical Support.

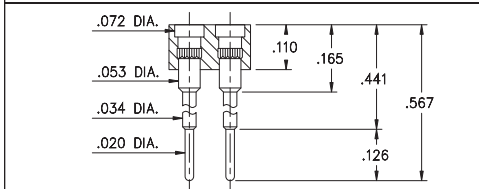
**FIG. 1**



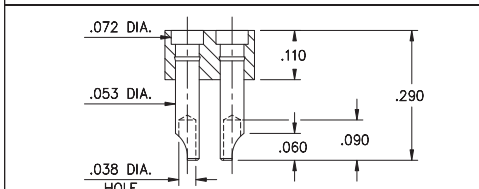
**FIG. 2**



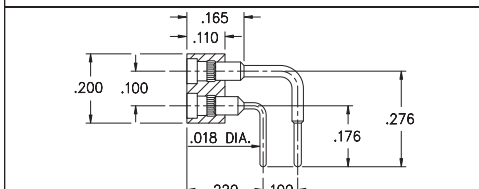
**FIG. 3**



**FIG. 4**

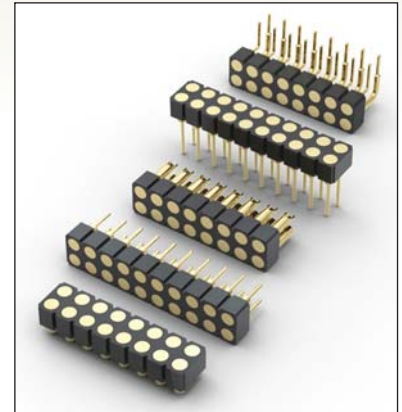


**FIG. 5**



**FIG. 6**

- Series 419, 430 and 499 Spring Target Connectors, supplied in double row strips
- Spring Target Connectors present a large flat surface for making contact with our standard .042" dia. spring pin plungers. The target connectors provide an excellent gold-plated conductive path back to the board mounted spring pin connector
- Target connectors use MM #1938, #1940, #1941, #1942 and #3024 pins. See page 218 for details
- Insulators are high temperature thermoplastic



### ORDERING INFORMATION

<b>FIG. 1</b>	<b>Series 419...041</b> <span style="float: right;"><b>Surface Mount</b></span>
	419-10-2-__-30-041000 Specify number of pins    ↑    04-64
<b>FIG. 2</b>	<b>Series 419...001</b> <span style="float: right;"><b>Standard Solder Tails</b></span>
	419-10-2-__-00-001000 Specify number of pins    ↑    04-64
<b>FIG. 3</b>	<b>Series 419...002</b> <span style="float: right;"><b>Long Solder Tails</b></span>
	419-10-2-__-00-002000 Specify number of pins    ↑    04-64
<b>FIG. 4</b>	<b>Series 419...005</b> <span style="float: right;"><b>Elevated with Solder Tails</b></span>
	419-10-2-__-00-005000 Specify number of pins    ↑    04-64
<b>FIG. 5</b>	<b>Series 430...240</b> <span style="float: right;"><b>Solder Cups</b></span>
	430-10-2-__-00-240000 Specify number of pins    ↑    04-64
<b>FIG. 6</b>	<b>Series 499...008</b> <span style="float: right;"><b>Right Angle Solder Tails</b></span>
	499-10-2-__-10-008000 Specify number of pins    ↑    04-64
<div style="display: flex; justify-content: space-around; align-items: center;"> <div style="border: 1px solid black; padding: 5px; background-color: #90EE90;">RoHS-2 2011/65/EU</div> <div style="border: 1px solid black; border-radius: 50%; padding: 5px;">XX=Plating Code See Below</div> <div style="border: 1px solid black; border-radius: 50%; padding: 5px;">For Electrical, Mechanical &amp; Enviromental Data, See page 264</div> </div>	
<b>SPECIFY PLATING CODE XX=</b>	10 <span style="color: green;">◆</span>
Pin Plating	10 μ" Au