

Position switch in compact design 40 mm wide with connector plug
M12 Snap-action contacts 1 NO+1 NC with twist lever



Product brand name	SIRIUS
Product designation	Mechanical position switches
Product type designation	3SE5
Suitability for use safety switch	Yes

General technical data	
Product function	
• positive opening	Yes
Insulation voltage	
• rated value	400 V
Degree of pollution	3
Surge voltage resistance rated value	4 kV
Protection class IP	IP67
Shock resistance	
• acc. to IEC 60068-2-27	30 g / 11 ms
Vibration resistance	
• acc. to IEC 60068-2-6	0.35 mm/5g
Mechanical service life (switching cycles)	
• typical	5 000 000
Electrical endurance (switching cycles)	

<ul style="list-style-type: none"> • at AC-15 at 230 V typical 	100 000
Electrical endurance (switching cycles) with contactor 3RH11, 3RT1016, 3RT1017, 3RT1024, 3RT1025, 3RT1026 typical	500 000
Electrical operating cycles in one hour with contactor 3RH11, 3RT1016, 3RT1017, 3RT1024, 3RT1025, 3RT1026	1 800
Thermal current	10 A
Material of the enclosure of the switch head	metal
Reference code acc. to DIN EN 81346-2	B
Reference code acc. to DIN EN 61346-2	B
Active principle	mechanical
Repeat accuracy	0.05 mm
Minimum actuating torque in activation direction	0.2 N·m
Length of the sensor	95 mm
Width of the sensor	40 mm
Design of the switching contact	mechanical
Operating frequency rated value	50 ... 60 Hz
Number of NC contacts for auxiliary contacts	1
Number of NO contacts for auxiliary contacts	1
Operating current at AC-15	
<ul style="list-style-type: none"> • at 125 V rated value • at 230 V rated value 	6 A 3 A
Operating current at DC-13	
<ul style="list-style-type: none"> • at 125 V rated value • at 230 V rated value 	0.55 A 0.27 A
Design of the interface for safety-related communication	without

Enclosure

Design of the housing	block
Material of the enclosure	metal
Coating of the enclosure	painted
Design of the housing acc. to standard	No

Drive Head

Design of the operating mechanism	twist lever
Shape of the switch head	lever
Design of the switching function	snap-action contact
Circuit principle	snap-action contacts
Number of switching contacts safety-related	1

Connections/ Terminals

Type of electrical connection	M12 plug, fixed, 5-pole
Design of plug-in connection	M12 connector, 5-pole: pin 1= terminal BK, pin 2= BK/WH, pin 3= BU, pin 4= BN, pin 5= GN/YE

Communication/ Protocol

Design of the interface without

Ambient conditions

Ambient temperature

- during operation -25 ... +85 °C
- during storage -25 ... +85 °C

Explosion protection category for dust none

Installation/ mounting/ dimensions

Mounting position any

Mounting type screw fixing

Certificates/ approvals

General Product Approval



CCC



UR



EG-Konf.

Declaration of Conformity

[Miscellaneous](#)

other

[Confirmation](#)

Further information

Information- and Downloadcenter (Catalogs, Brochures,...)

<https://www.siemens.com/ic10>

Industry Mall (Online ordering system)

<https://mall.industry.siemens.com/mall/en/en/Catalog/product?mlfb=3SE5423-0CN20-1EB1>

Cax online generator

<http://support.automation.siemens.com/WW/CAXorder/default.aspx?lang=en&mlfb=3SE5423-0CN20-1EB1>

Service&Support (Manuals, Certificates, Characteristics, FAQs,...)

<https://support.industry.siemens.com/cs/ww/en/ps/3SE5423-0CN20-1EB1>

Image database (product images, 2D dimension drawings, 3D models, device circuit diagrams, EPLAN macros, ...)

http://www.automation.siemens.com/bilddb/cax_de.aspx?mlfb=3SE5423-0CN20-1EB1&lang=en

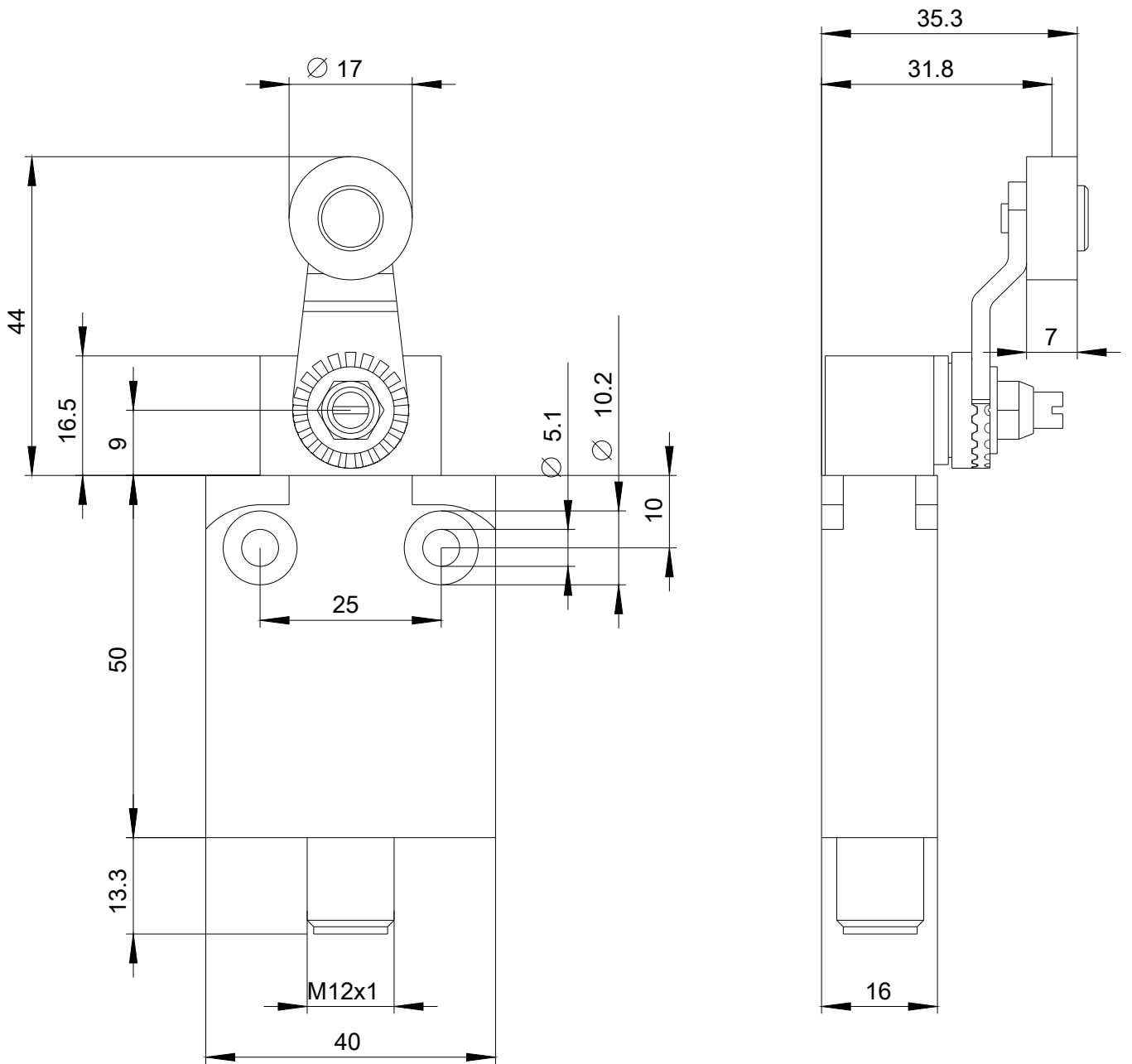

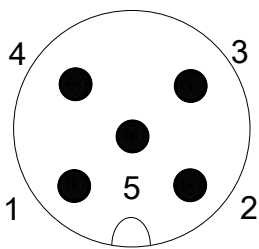

1	BK = Black	→	22
2	BK/WH = Black/White	→	21
3	BU = Blue	→	14
4	BN = Brown	→	13
5	GY/YE = Grey/Yellow	→	PE

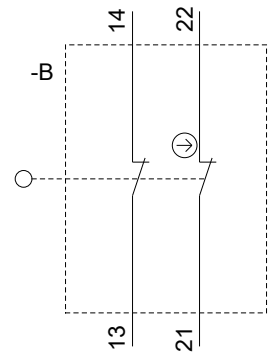

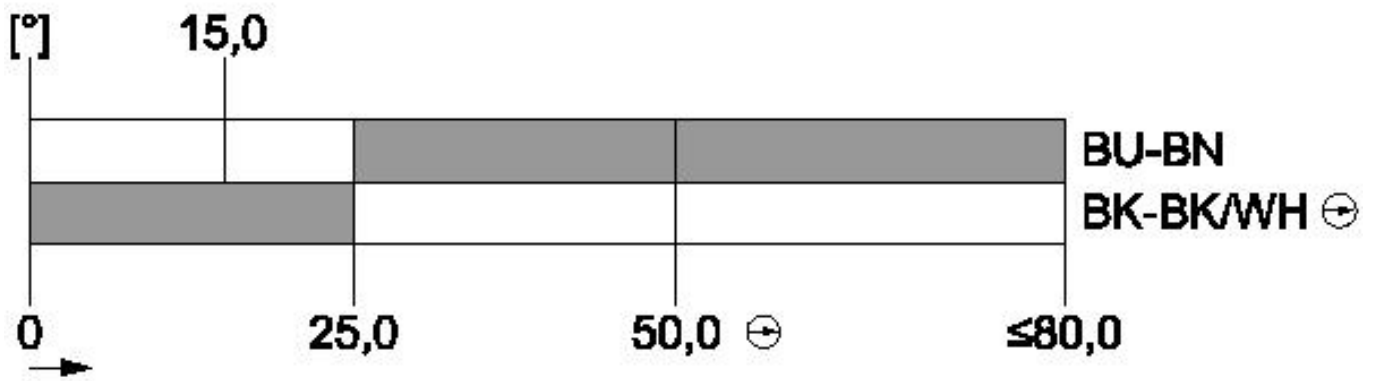

last modified:

03/10/2020