

communication module PROFINET High-Feature with integrated switch



Figure similar

product brand name	SIRIUS
product category	Communication modules
product designation	Communication module
design of the product	PROFINET High Feature with integrated switch
manufacturer's article number	
<ul style="list-style-type: none"> of soft starter 	3RW55

General technical data

protection class IP	IP20
reference code acc. to IEC 81346-2	A

Installation/ mounting/ dimensions

mounting position	any
fastening method	screw fixing
height	126 mm
width	28 mm
depth	82 mm
weight without packaging	0.1 kg

Ambient conditions

installation altitude at height above sea level <ul style="list-style-type: none"> • maximum 	5 000 m; Derating as of 1000 m, see catalog
ambient temperature <ul style="list-style-type: none"> • during operation • during storage and transport 	-25 ... +60 °C; observe derating of basic unit above 40 °C -40 ... +80 °C
environmental category <ul style="list-style-type: none"> • during operation acc. to IEC 60721 • during storage acc. to IEC 60721 • during transport acc. to IEC 60721 	3K6 (no ice formation, only occasional condensation), 3C3 (no salt mist), 3S2 (sand must not get into the devices), 3M6 1K6 (only occasional condensation), 1C2 (no salt mist), 1S2 (sand must not get inside the devices), 1M4 2K2, 2C1, 2S1, 2M2 (max. height of fall 0.8 m)

Certificates/ approvals

General Product Approval	Declaration of Conformity
 CSA  CCC  UL  EAC  CE EG-Konf.	Miscellaneous

Test Certificates	Marine / Shipping	other
Type Test Certificates/Test Report	 ABS  LRS  PRS  DNV-GL <small>DNVGL.COM/AF</small>	Confirmation

other
 Profibus

Further information

Information- and Downloadcenter (Catalogs, Brochures,...)

<https://www.siemens.com/ic10>

Industry Mall (Online ordering system)

<https://mall.industry.siemens.com/mall/en/en/Catalog/product?mfb=3RW5950-0CH00>

Cax online generator

<http://support.automation.siemens.com/WW/CAXorder/default.aspx?lang=en&mfb=3RW5950-0CH00>

Service&Support (Manuals, Certificates, Characteristics, FAQs,...)

<https://support.industry.siemens.com/cs/ww/en/ps/3RW5950-0CH00>

Image database (product images, 2D dimension drawings, 3D models, device circuit diagrams, EPLAN macros, ...)

http://www.automation.siemens.com/bilddb/cax_de.aspx?mfb=3RW5950-0CH00&lang=en

Characteristic: Tripping characteristics, I_{th}, Let-through current

<https://support.industry.siemens.com/cs/ww/en/ps/3RW5950-0CH00/char>

Characteristic: Installation altitude

<http://www.automation.siemens.com/bilddb/index.aspx?view=Search&mlfb=3RW5950-0CH00&objecttype=14&gridview=view1>

Simulation Tool for Soft Starters (STS)

<https://support.industry.siemens.com/cs/ww/en/view/101494917>

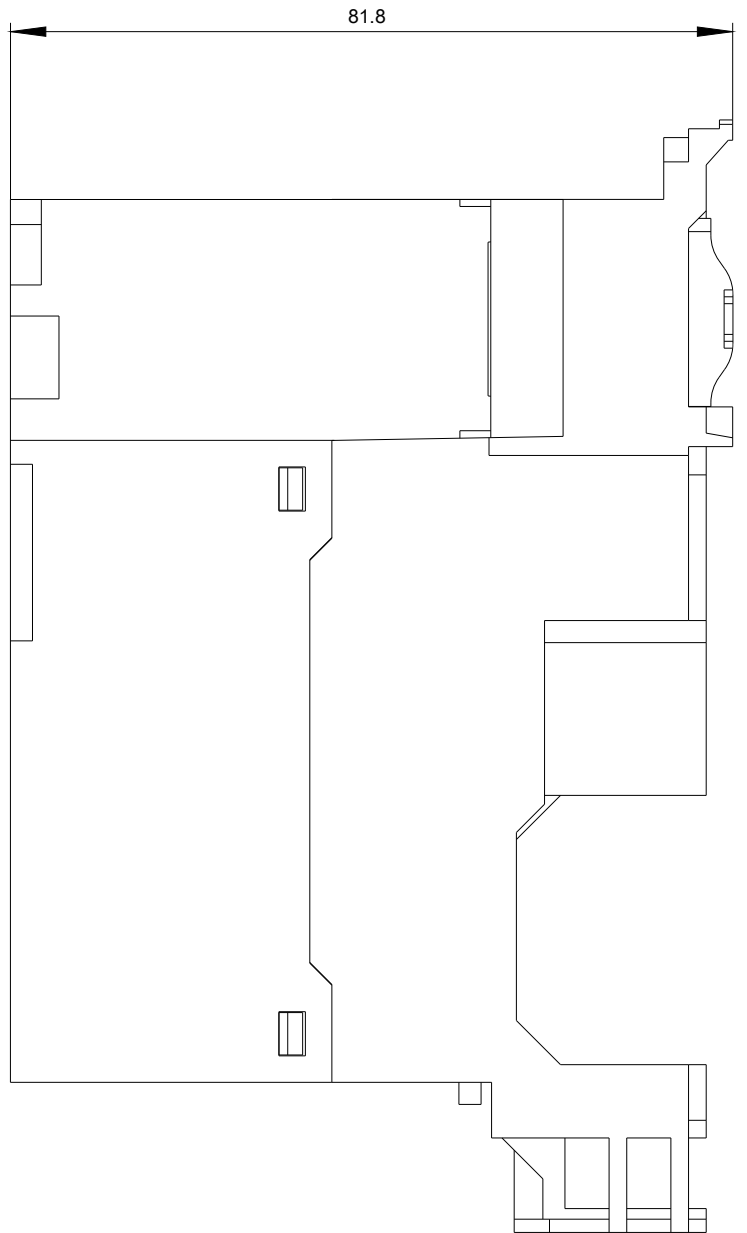
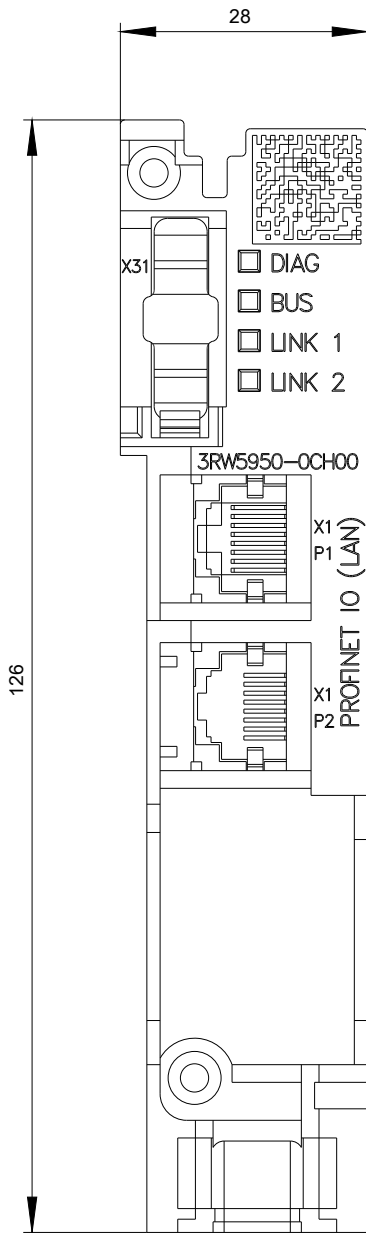

-A

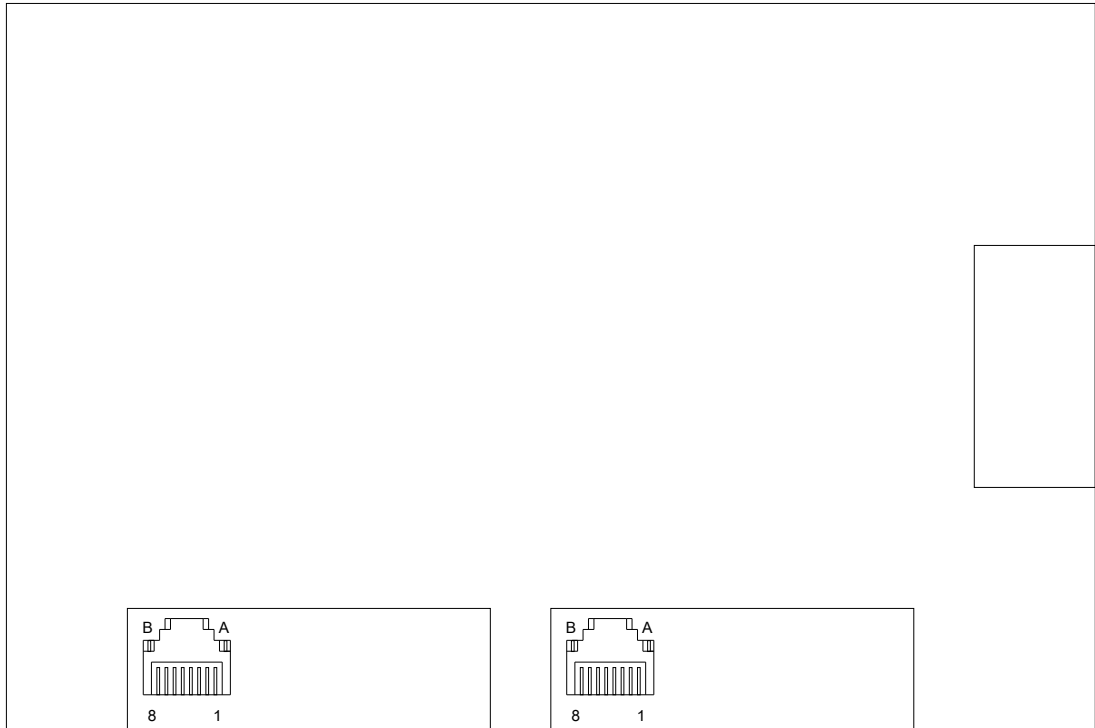

-X1:P1

-X1:P2

-X31

last modified:

11/25/2020