

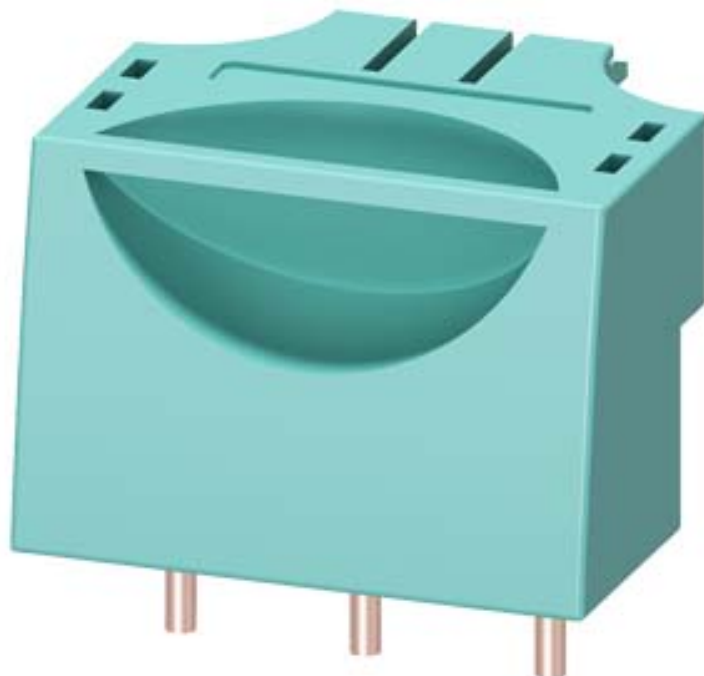









Cable connector size S00 screw terminal



General technical data		
Product brand name		SIRIUS
Product designation		Connection plug
Design of the product		Size S00
Size of the circuit-breaker		S00
Protection class IP on the front		IP20
Ambient temperature		
• during storage	°C	-50 ... +80
• during operation	°C	-20 ... +60
Ampacity maximum	A	16
Installation/ mounting/ dimensions		
Width	mm	44.8
Height	mm	42
Depth	mm	54
Certificates/ approvals		
Certificate of suitability		CE / UL / CSA / CCC

General Product Approval	Test Certificates	Shipping Approval
 CSA  EAC	Special Test Certificate	 ABS  BUREAU VERITAS  Lloyd's Register LRS

Shipping Approval	other	Railway
 PRS  RINA  RMRS	Confirmation	 VDE Vibration and Shock

Further information

Information- and Downloadcenter (Catalogs, Brochures,...)

<https://www.siemens.com/ic10>

Industry Mall (Online ordering system)

<https://mall.industry.siemens.com/mall/en/en/Catalog/product?mlfb=3RV2917-5CA00>

Cax online generator

<http://support.automation.siemens.com/WW/CAXorder/default.aspx?lang=en&mlfb=3RV2917-5CA00>

Service&Support (Manuals, Certificates, Characteristics, FAQs,...)

<https://support.industry.siemens.com/cs/ww/en/ps/3RV2917-5CA00>

Image database (product images, 2D dimension drawings, 3D models, device circuit diagrams, EPLAN macros, ...)

http://www.automation.siemens.com/bilddb/cax_de.aspx?mlfb=3RV2917-5CA00&lang=en

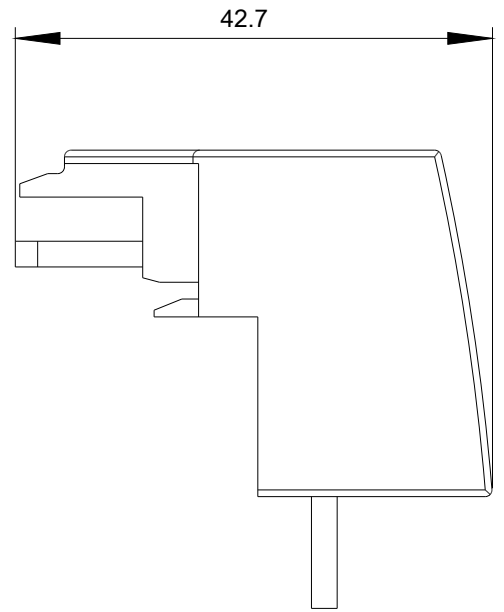
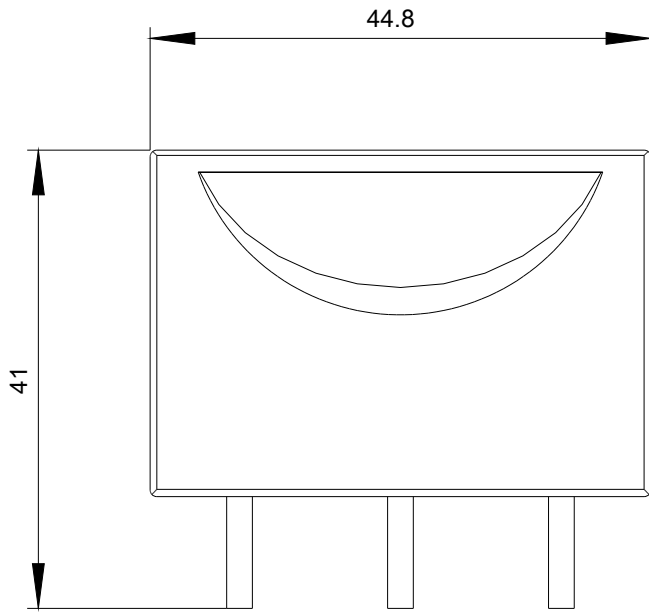

last modified:

03/09/2020