

LV HRC fuse element, NH3, In: 500 A, gG, Un AC: 690 V, Un DC: 440 V, Front indicator, live grip lugs



Model	
Product brand name	SETRON
Product designation	LV HRC fuse link
Design of the product	With blade contacts
Design of an identification indicator	Front indicators
Design of the switching contact	Non-corroding, silver-plated
Design of the fuse link	LV HRC fuse link
General technical data	
Size of fuse system / acc. to DIN EN 60269-1	NH3
Operating class of the fuse link	gG
circuit-breaker / Design	3NA3
Type of voltage	AC/DC
Operating current / at AC / rated value	500 A
Supply voltage	
• at AC / rated value	690 V
• at DC	440 V
Protection class	
Protection class IP	IP20, with connected conductors

## Switching capacity

Switching capacity current	
• at DC / acc. to IEC 60947-2 / rated value	25 kA
• acc. to IEC 60947-2 / rated value	120 kA

## Dissipation

Power loss [W]	47.38 W
Power loss [W] / for rated value of the current / at AC / in hot operating state / per pole	47.38 W

## Current

Tripping residual / rated value / derated current / at 40 Cel	475 A
Diken-export / Let-through energy	DE_3NA_3_690_gG_500

## Mechanical Design



Width	
• of the enclosure	71.2 mm
Mounting position	Any, preferably vertical
Net weight	1 049 g

## Environmental conditions

Ambient temperature	
• minimum	-5 °C
• maximum	40 °C
Ambient temperature / during storage	Air humidity 90% at 20 °C
Environmental category	-20 to +50 at 95% relative humidity

## Certificates

Reference code	
• acc. to DIN EN 61346-2	F
• acc. to DIN EN 81346-2	F

General Product Approval	Declaration of Conformity	Test Certificates
 CCC	 VDE	 EG-Konf.
		<a href="#">Type Test Certificates/Test Report</a>
		<a href="#">Special Test Certificate</a>
		<a href="#">Miscellaneous</a>

Shipping Approval	other
 GL	<a href="#">Environmental Conformations</a>
	<a href="#">Miscellaneous</a>

### Further information

**Information- and Downloadcenter (Catalogs, Brochures,...)**

<http://www.siemens.com/lowvoltage/catalogs>

**Industry Mall (Online ordering system)**

<https://mall.industry.siemens.com/mall/en/en/Catalog/product?mlfb=3NA3365-6>

**Service&Support (Manuals, Certificates, Characteristics, FAQs,...)**

<https://support.industry.siemens.com/cs/ww/en/ps/3NA3365-6>

**Image database (product images, 2D dimension drawings, 3D models, device circuit diagrams, ...)**

[http://www.automation.siemens.com/bilddb/cax\\_en.aspx?mlfb=3NA3365-6](http://www.automation.siemens.com/bilddb/cax_en.aspx?mlfb=3NA3365-6)

**CAX-Online-Generator**

<http://www.siemens.com/cax>

**Tender specifications**

<http://www.siemens.com/specifications>

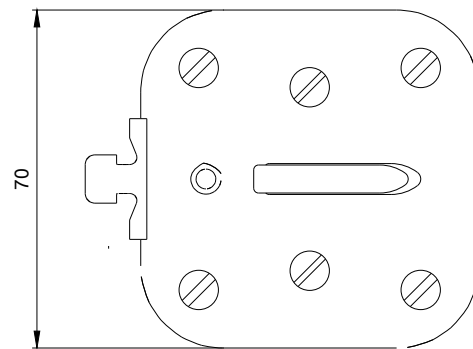
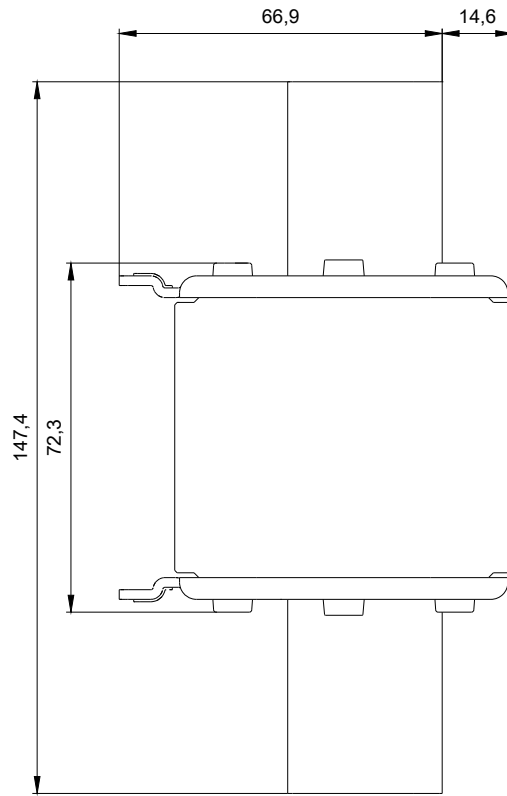

1

-F1

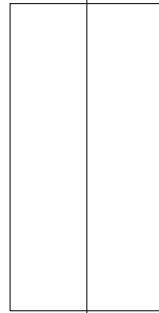

2