

# .156" (3.96mm) Wire-To-Board Headers

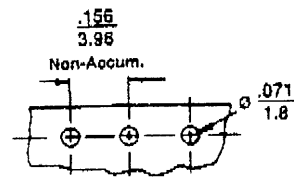

## 5414 Series Square Pin Friction Lock Header

- 94V-2 nylon 6/6
- .045" (1.14mm) square wire pins
- 2-12 circuits
- Mates with 2139-NR, 2145-NA and 2145-NC

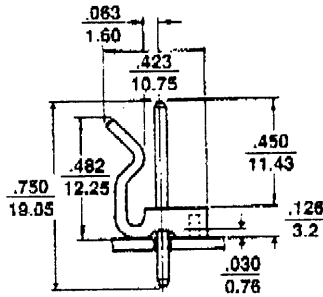
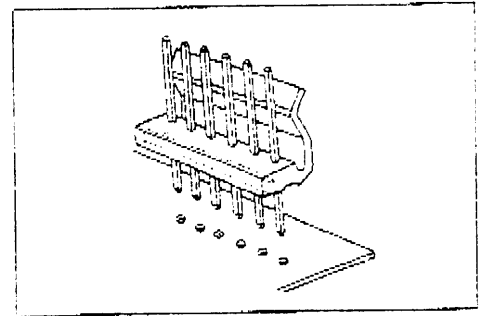
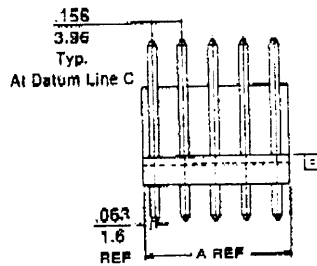

Recommended P.C. Board Hole Dimensions

\* 3926-3060 \*

### Ordering and Dimensional Information

Circuits	Tin	Gold	Dim. A	Circuits	Tin	Gold	Dim. A
2	5414-02A	5414-02AG	.282/ 7.16	8	5414-08A	5414-08AG	1.217/30.92
3	5414-03A	5414-03AG	.438/11.12	9	5414-09A	5414-09AG	1.373/34.88
4	5414-04A	5414-04AG	.594/15.08	10	5414-10A	5414-10AG	1.529/38.84
5	5414-05A	5414-05AG	.750/19.04	11	5414-11A	5414-11AG	1.685/42.80
* 6	5414-06A *	5414-06AG	.906/23.00	12	5414-12A	5414-12AG	1.841/46.76
7	5414-07A	5414-07AG	1.061/26.96				

## 5238 Series Round Pin Friction Lock Header

- 94V-2 nylon 6/6
- .045" (1.14mm) round wire pins
- 2-12 circuits
- Mates with 2139-NR, 2145-NA and 2145-NC

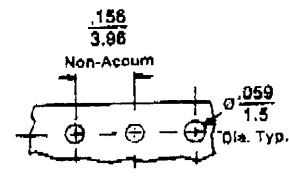
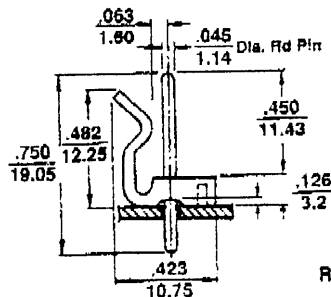
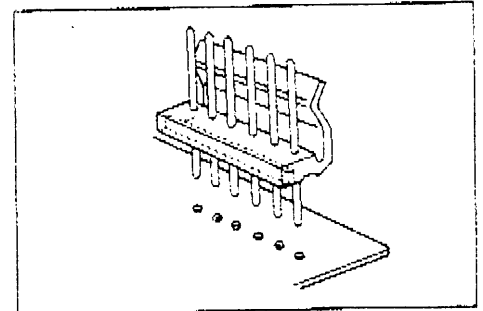
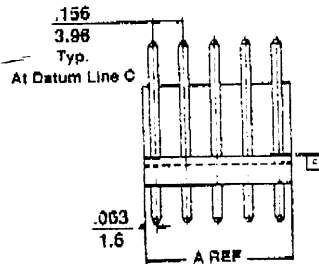

Recommended P.C. Board Hole Dimensions

### Ordering and Dimensional Information

Circuits	Tin	Gold	Dim. A	Circuits	Tin	Gold	Dim. A
2	5238-02D	5238-02DG	.282/ 7.16	8	5238-08D	5238-08DG	1.217/30.92
3	5238-03D	5238-03DG	.438/11.12	9	5238-09D	5238-09DG	1.373/34.88
4	5238-04D	5238-04DG	.594/15.08	10	5238-10D	5238-10DG	1.529/38.84
5	5238-05D	5238-05DG	.750/19.04	11	5238-11D	5238-11DG	1.685/42.80
6	5238-06D	5238-06DG	.906/23.00	12	5238-12D	5238-12DG	1.841/46.76
7	5238-07D	5238-07DG	1.061/26.96				