

Steckzungen für gedruckte Schaltungen

Masse im Steckbereich
DIN 46342, Teil 1

Languettes plates pour circuits imprimés

Dimensions zone d'emboîtement selon
DIN 46342, partie 1

Mounting tabs for printed circuitry

Dimensions in the tab sector
DIN 46342, part 1

6,3 mm

Werkstoff:

BZ = Bronze
MS = Messing
NS = Neusilber

Matière:

BZ = bronze
MS = laiton
NS = maillechort

Material:

BZ = bronze
MS = brass
NS = german silver

Oberflächenbehandlung: Code

bl = blank (0)
ag = versilbert (1)
au = vergoldet (2)
sn = verzinkt (8)

Traitements de surface: Code

bl = brut (0)
ag = argenté (1)
au = doré (2)
sn = étamé (8)

Surface-plating: Code

bl = clean (0)
ag = silver-plated (1)
au = gold-plated (2)
sn = tin-plated (8)

Bestellbeispiel:
Exemple de commande:
Example of order:

3866P.68 lose / en vrac / in bulk
(3866P MS sn)

03866P.68 magaziniert / emmagasiné / wired
(03866P MS sn)

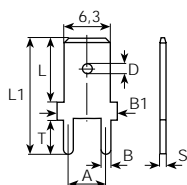

lose
en vrac
in bulk

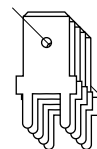

magaziniert
emmagasiné
wired

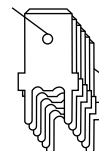
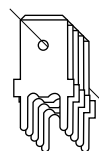
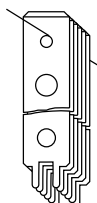
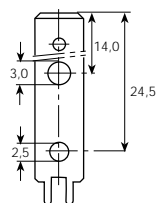

Artikel-Nr. Numéro d'article Part-No.	3866P.6() MS	03866P.6() MS	3866U.6() MS	03866U.6() MS	3866R.6() MS	3866Z.6() MS	03866Z.6() MS
Print Bohrung Trou Hole	Ø 0.95 T 3 L - L1 31.5 B1 6.3 A 2.5 D 1.65 B 0.8 S 0.8	Ø 0.95 T 3 L - L1 31.5 B1 6.3 A 2.5 D 1.65 B 0.8 S 0.8	Ø 0.9 T 4.5 L 8.5 L1 15.3 B1 8 A 5 D 1.65 B 1 S 0.4	Ø 0.9 T 4.5 L 8.5 L1 15.3 B1 8 A 5 D 1.65 B 1 S 0.4	Ø 1.1 T 3 L - L1 35.5 B1 6.3 A 5 D 1.8 B 1 S 0.8	Ø 1.1 T 3.5 L 8.5 L1 14.3 B1 8 A 5 D 1.65 B 1 S 0.8	Ø 1.1 T 3.5 L 8.5 L1 14.3 B1 8 A 5 D 1.65 B 1 S 0.8
Stand.-Packg.	1000	2000	2000	3750	1000	1000	2000
Werkzeuge Outils / Tools	1037/38	1046P	1037/40	1046U	1037/38	1037/23	1046

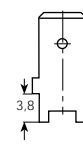
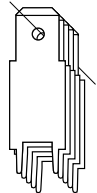
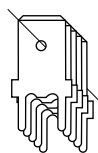

Artikel-Nr. Numéro d'article Part-No.	3866G.6() MS	03866G.6() MS	3865T.7() NS	03865T.7() NS	3865F.7() NS	3865S.7() NS	3866T.6() MS
Print Bohrung Trou Hole	Ø 1.1 T 4.5 L 8.5 L1 15.3 B1 8 A 5 D 1.65 B 1 S 0.8	Ø 1.1 T 4.5 L 8.5 L1 15.3 B1 8 A 5 D 1.65 B 1 S 0.8	Ø 1.15 T 3.6 L 8 L1 24.8 B1 8 A 5 D 1.65 B 1 S 0.8	Ø 1.15 T 3.6 L 8 L1 24.8 B1 8 A 5 D 1.65 B 1 S 0.8	Ø 1.2 T 3 L 8 L1 38.2 B1 7.5 A 6.5 D 1.7x3.9 B 1 S 0.8	Ø 1.2 T 3 L 8 L1 38.2 B1 7.5 A 6.5 D 1.7 B 1 S 0.8	Ø 1.3 T 1.5 L 8.5 L1 14.4 B1 8 A 5 D 1.65 B 1.3 S 0.8
Stand.-Packg.	1000	2000	1000	2000	1000	1000	1000
Werkzeuge Outils / Tools	1037/23	1046	1037/23	1046T	1037/23	1037/23	1037/23