

PART NUMBER: 356-22

CUSTOMER PRINT

NOTES:

1. MATERIAL: STAINLESS STEEL
2. ALL DIMENSION FOR REFERENCE ONLY

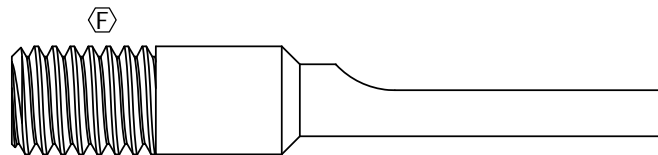
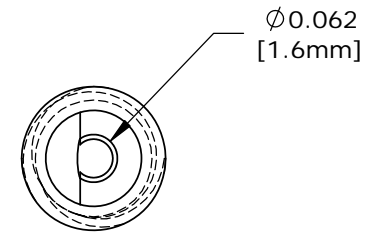
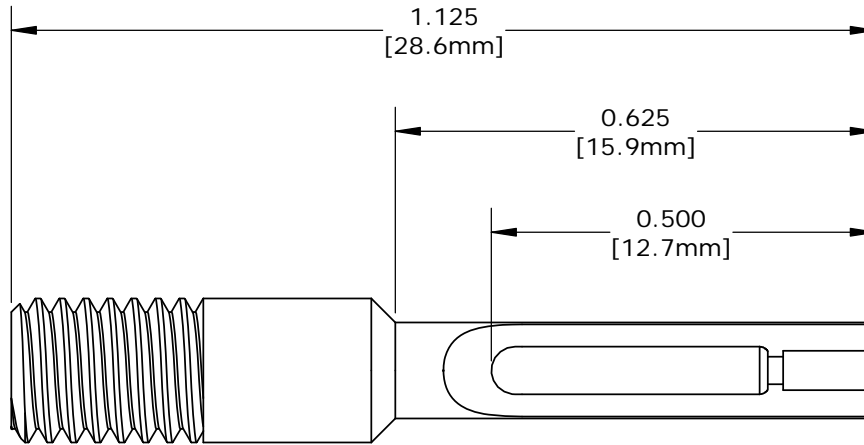

10-32 UNF-2A THREAD

PROPRIETARY

THIS DOCUMENT CONTAINS CONFIDENTIAL INFORMATION PROPRIETARY TO CONXALL CORPORATION. ANY REPRODUCTION, DISCLOSURE, OR USE OF THIS DOCUMENT /INFORMATION IS EXPRESSLY PROHIBITED UNLESS AUTHORIZED IN WRITING BY CONXALL CORPORATION.

DIMENSIONS IN BRACKETS [] ARE METRIC

F	SS	03-10-20	ADDED PROJECTED VIEW AND UPDATED MFG DRAWING PER ECR 9509
E	SS	07-16-19	UPDATED MATERIAL FOR NOTE 1 PER ECR 9429
D	AN	06-19-17	CREATED SHEET PER DOR 17-7819JS
REV.	INIT.	DATE	DESCRIPTION
<small>ALL INFORMATION ILLUSTRATED IS THE PROPERTY OF "CONXALL CORPORATION." UNAUTHORIZED DUPLICATION OR DISTRIBUTION OF THIS DOCUMENT IS PROHIBITED.</small>			<small>ORIG. DRAWN BY:</small> TAG <small>DATE:</small> 12-14-00
<small>ALL UNITS ARE IN FEET, INCHES, FRACTION OF INCHES AND DECIMALS.</small>			<small>CHECKED BY:</small> <small>APPROVED BY:</small>
<small>△ = CRITICAL CHARACTERISTIC FLAG PER SPEC. XXXX</small>		<small>SCALE</small> NTS A	<small>SHEET</small> 1 OF 1
<small>FILE:</small> 356-22		<small>DIRECTORY:</small> SLW	<small>TITLE:</small> CONTACT INSERTION BIT FOR SIZE #20 PIN-SOCKET 20 AWG TO 24 AWG <small>CUSTOMER:</small> STANDARD PRODUCT
<small>PART NUMBER:</small> 356-22		<small>REV</small> F	<small>REV</small> F

