



PowerTube | PowerTube HVP-HD 1000

TE Internal #: 2407805-1

Cap, PC/PET, Natural - Translucent, PowerTube HVP-HD 1000,
Other Automotive Connector Accessories

[View on TE.com >](#)

Connectors > Automotive Connectors > Automotive Connector Accessories > Other Automotive Connector Accessories >

Power Tube HVP-HD 1000 Accessories

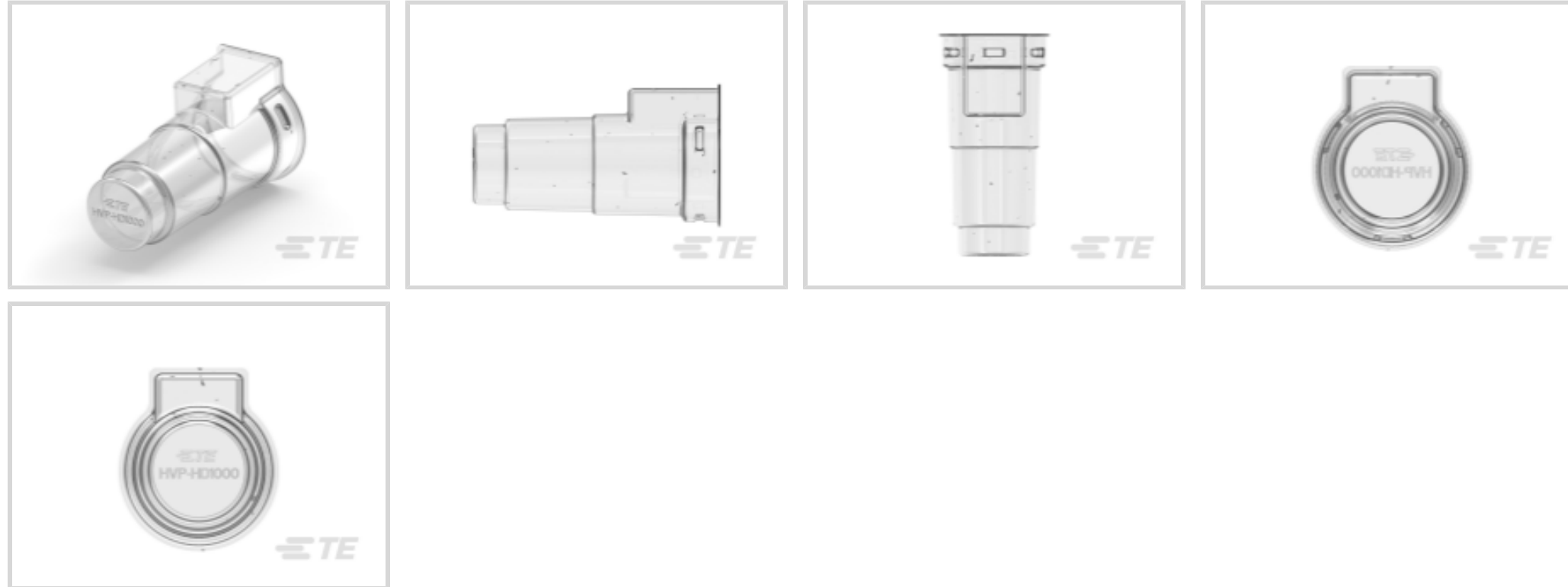

Automotive Connector Accessory Type: **Cap**

Primary Product Material: **PC/PET**

Primary Product Color: **Natural - Translucent**

[All Power Tube HVP-HD 1000 Accessories \(29\)](#)

Features

Product Type Features

Automotive Connector Accessory Type	Cap
-------------------------------------	-----

Configuration Features

Number of Positions	1
---------------------	---

Body Features

Primary Product Material	PC/PET
Primary Product Color	Natural - Translucent

Product Compliance

[For compliance documentation, visit the product page on TE.com>](#)

EU RoHS Directive 2011/65/EU	Compliant
EU ELV Directive 2000/53/EC	Compliant
China RoHS 2 Directive MIIT Order No 32, 2016	No Restricted Materials Above Threshold
EU REACH Regulation (EC) No. 1907/2006	Current ECHA Candidate List: JUNE 2024 (241)



Candidate List Declared Against: JUNE 2023 (235)

Does not contain REACH SVHC

Halogen Content	Low Halogen - Br, Cl, F, I < 900 ppm per homogenous material. Also BFR/CFR/PVC Free
Solder Process Capability	Not reviewed for solder process capability

Product Compliance Disclaimer

This information is provided based on reasonable inquiry of our suppliers and represents our current actual knowledge based on the information they provided. This information is subject to change. The part numbers that TE has identified as EU RoHS compliant have a maximum concentration of 0.1% by weight in homogenous materials for lead, hexavalent chromium, mercury, PBB, PBDE, DBP, BBP, DEHP, DIBP, and 0.01% for cadmium, or qualify for an exemption to these limits as defined in the Annexes of Directive 2011/65/EU (RoHS2). Finished electrical and electronic equipment products will be CE marked as required by Directive 2011/65/EU. Components may not be CE marked. Additionally, the part numbers that TE has identified as EU ELV compliant have a maximum concentration of 0.1% by weight in homogenous materials for lead, hexavalent chromium, and mercury, and 0.01% for cadmium, or qualify for an exemption to these limits as defined in the Annexes of Directive 2000/53/EC (ELV). Regarding the REACH Regulations, TE's information on SVHC in articles for this part number is still based on the European Chemical Agency (ECHA) 'Guidance on requirements for substances in articles' (Version: 2, April 2011), applying the 0.1% weight on weight concentration threshold at the finished product level. TE is aware of the European Court of Justice ruling of September 10th, 2015 also known as O5A (Once An Article Always An Article) stating that, in case of 'complex object', the threshold for a SVHC must be applied to both the product as a whole and simultaneously to each of the articles forming part of its composition. TE has evaluated this ruling based on the new ECHA "Guidance on requirements for substances in articles" (June 2017, version 4.0) and will be updating its statements accordingly.

Compatible Parts



Also in the Series | PowerTube HVP-HD 1000

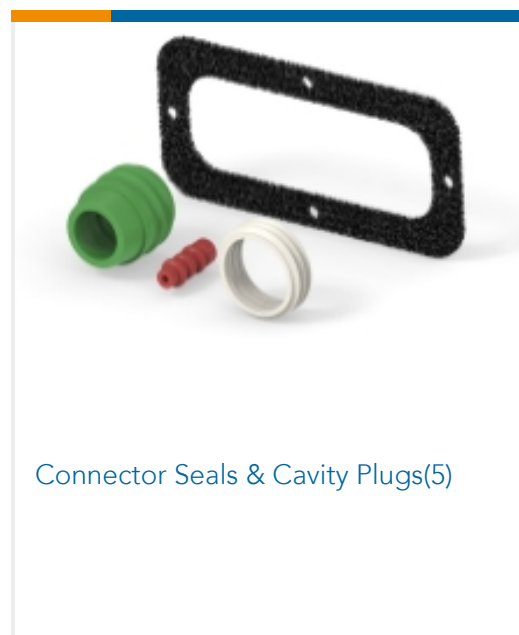
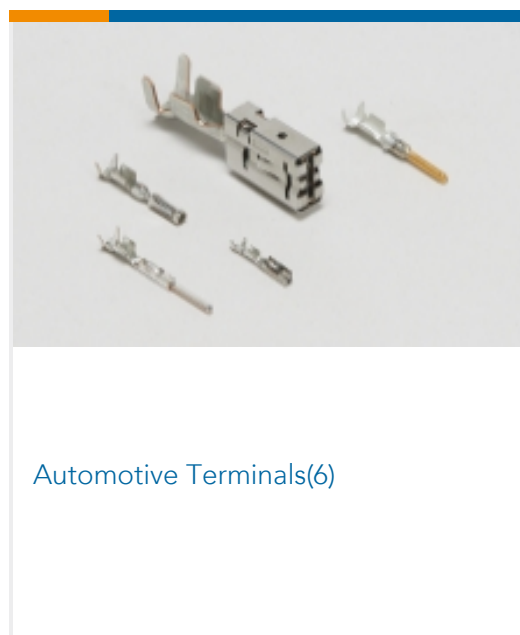
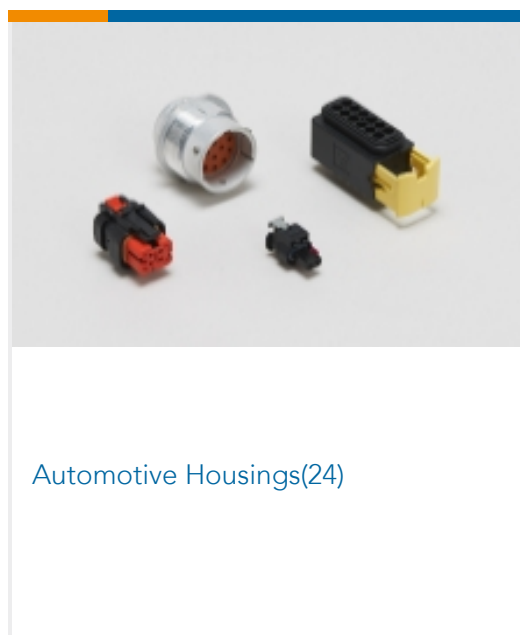
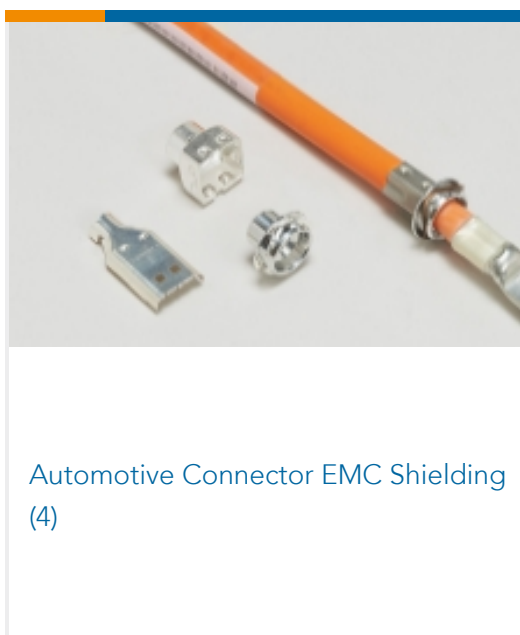



Other Automotive Connector Accessories(29)

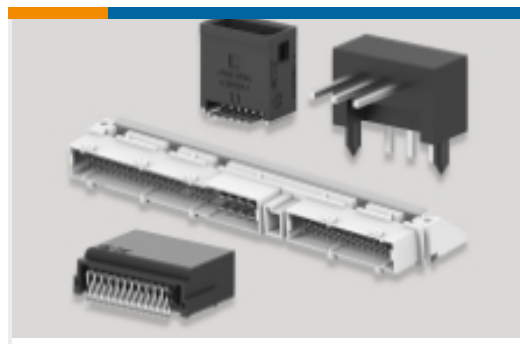

PCB Headers & Receptacles(180)

Customers Also Bought



TE Part #2112295-1
PROTECTION CAP, GROUP D, ASSY



TE Part #2394113-2
H&S 50mm, Cable cover



TE Part #2392553-4
STEEL, INNER FERRULE, HVA HD400



TE Part #2394085-8
Pre-ASSY, Finger Access, Code H



TE Part #2399610-2
2POS, HVP1400, ASSY, 90DEG, COD C/D



TE Part #2399679-7
Plug TPA Code G



TE Part #1-2392563-1
3POS, SOC INNER HSG, DIA 4MM, COD A, CVE

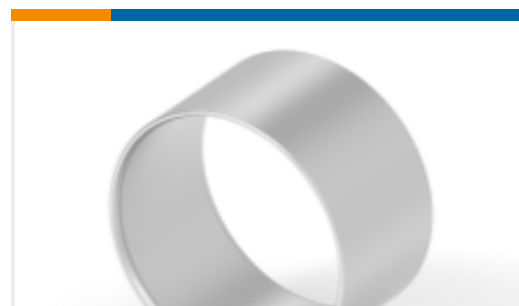

TE Part #2392553-3
STEEL, INNER FERRULE, HVA HD400



TE Part #2392559-3
SOC CONN CVR, 3POS, DIA 4MM, ICT CVE



TE Part #2392559-4
SOC CONN CVR, 3POS, DIA 4MM, ICT CVE

Documents

Product Drawings

[COVER, SHIPPING CAP FOR HD1000 PLUG](#)

English

CAD Files

[Customer View Model](#)

[ENG_CVM_CVM_2407805-1_B.3d_igs.zip](#)

English

[3D PDF](#)



3D

Customer View Model

[ENG_CVM_CVM_2407805-1_B.2d_dxf.zip](#)

English

Customer View Model

[ENG_CVM_CVM_2407805-1_B.3d_stp.zip](#)

English

By downloading the CAD file I accept and agree to the [Terms and Conditions](#) of use.

Datasheets & Catalog Pages

[HIVONEX CONNECTORS & CHARGING SOLUTIONS](#)

English