

LOC	DIST	REV	DATE	BY	CHK	APP'D
-	-	4	22JAN2018	JY	SH	
-	-	5	07FEB2018	JY	SH	

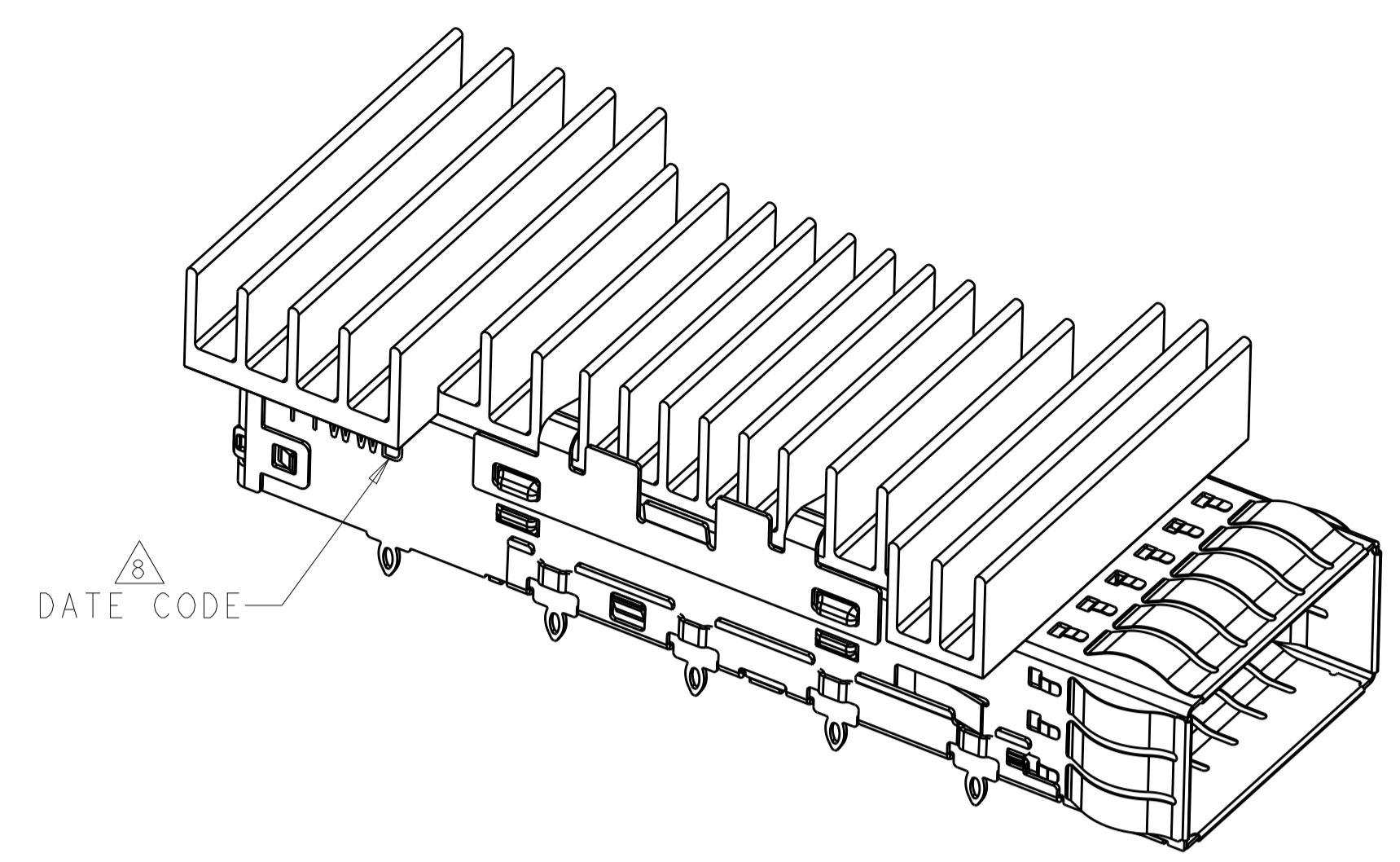

SCALE 3:1

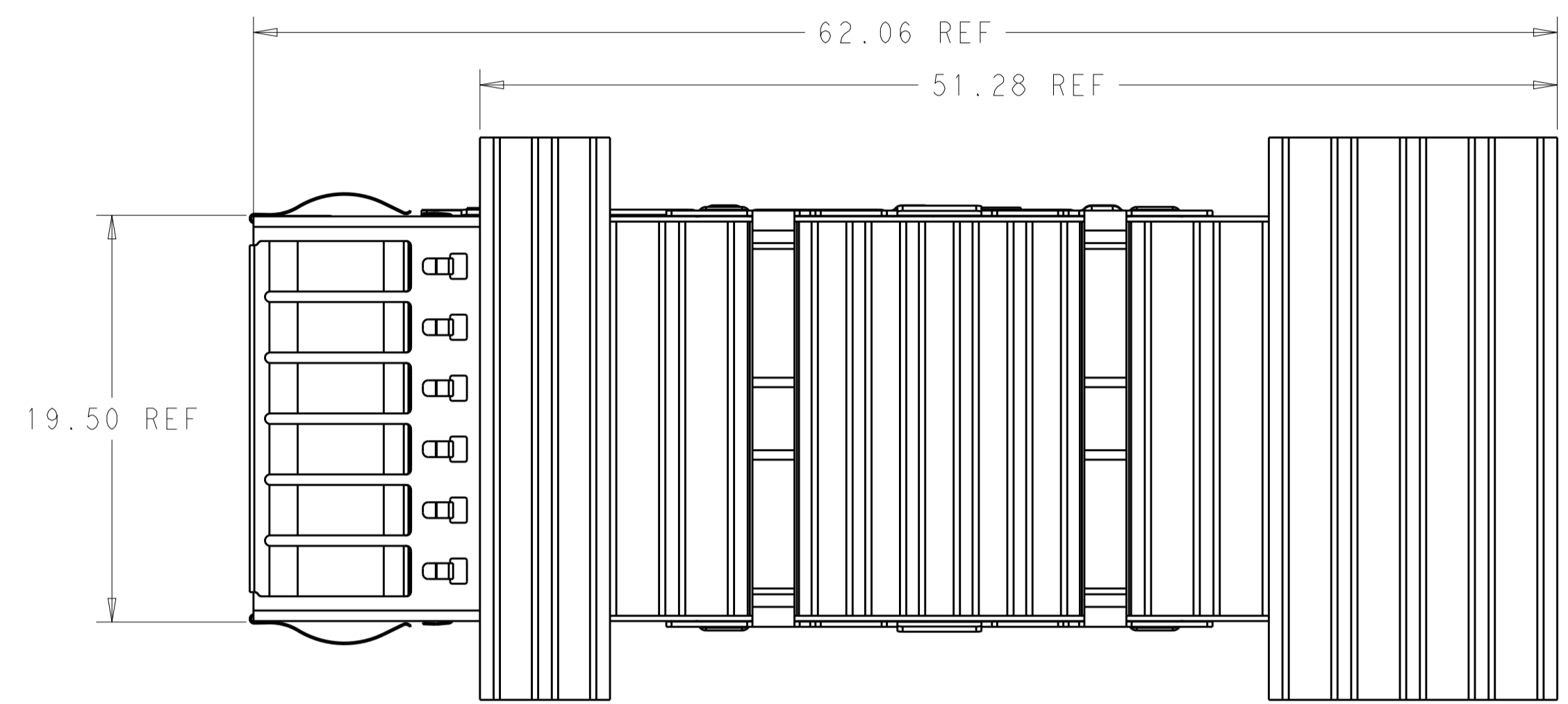

- MATERIAL:
 CAGE MATERIAL : 0.25 THICK NICKEL SILVER.
 SPRING MATERIAL: COPPER ALLOY
 HEAT SINK MATERIAL: ALUMINUM
 CLIP MATERIAL: STAINLESS STEEL
- FINISH:
 SPRING: NICKEL PLATING
 HEAT SINK: BLACK ANODIZE

- ⚠ DIMENSION APPLIES WITH MODULE INSTALLED IN THE CAGE TO TOP OF HEAT SINK.
- ⚠ REFERENCE APPLICATION SPEC 114-32023 FOR RECOMMENDED DRILL HOLE DIAMETER AND PLATING THICKNESS.
- ⚠ DATUM AND BASIC DIMENSIONS ESTABLISHED BY CUSTOMERS.
- 6. MINIMUM PC BOARD THICKNESS : SINGLES SIDED: 1.57 MIN
 DOUBLE SIDED: 2.20 MIN
- ⚠ DATUM -A- IS TOP SURFACE OF THE HOST BOARD.
- ⚠ DATE CODE (YYWWD) MARKED APPROXIMATELY AS SHOWN
- 9. MATES WITH QSFP28 MSA COMPATIBLE TRANSCEIVER.

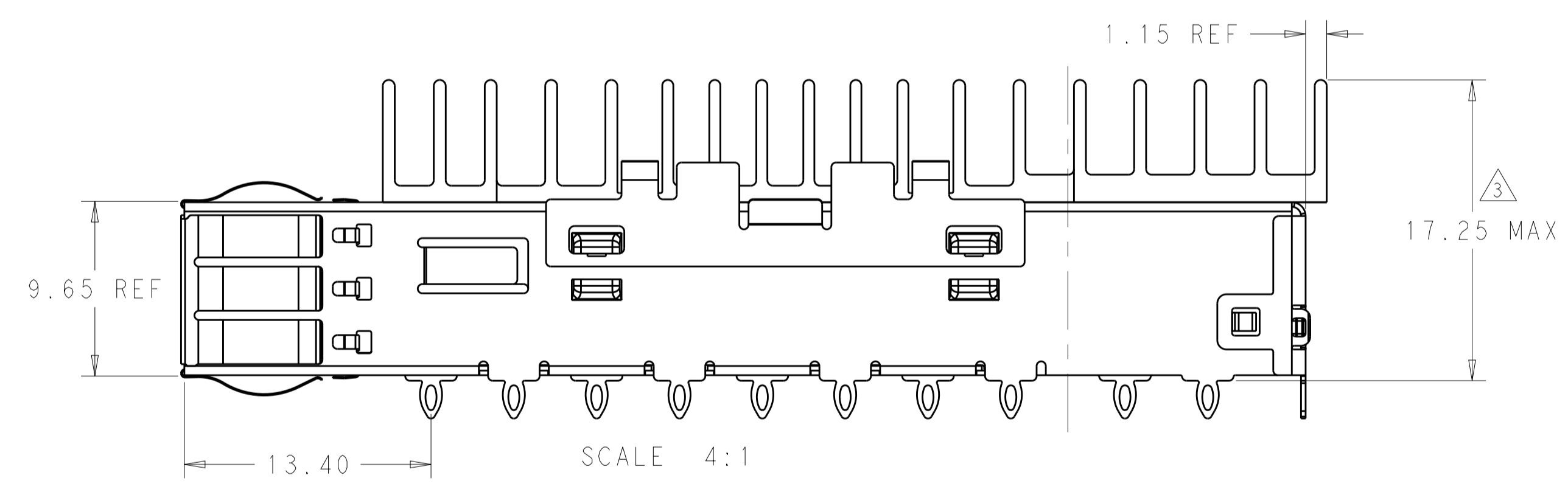
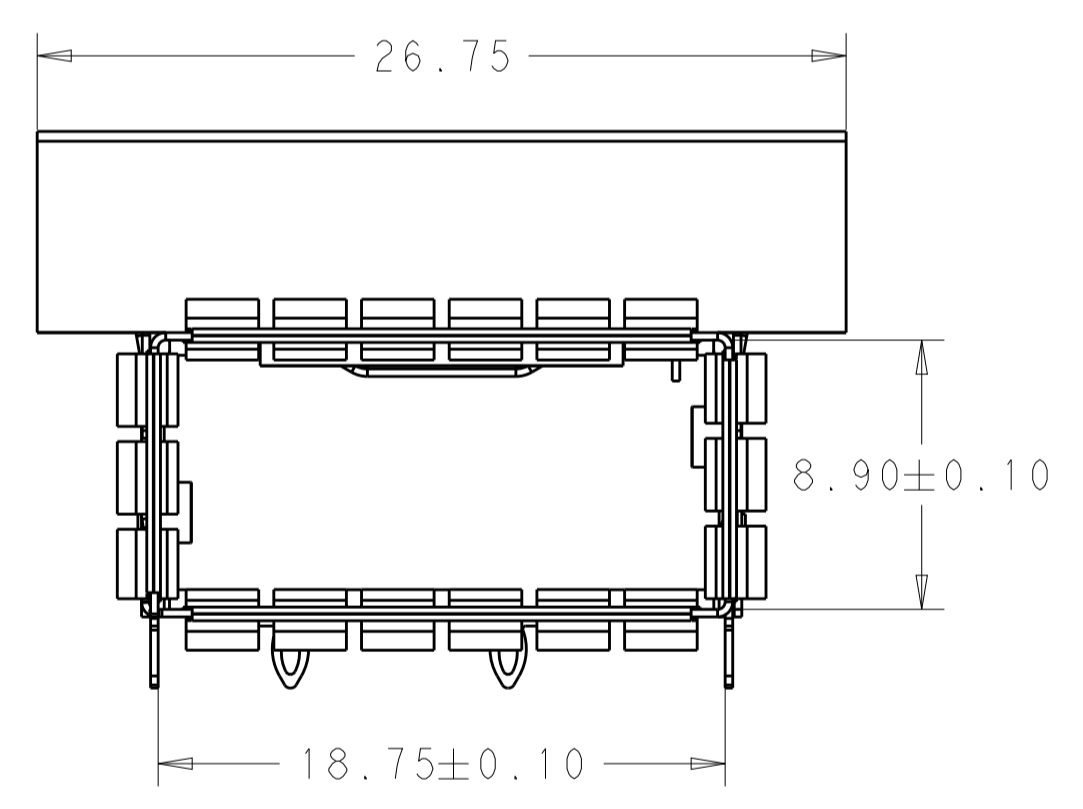

SCALE 4:1

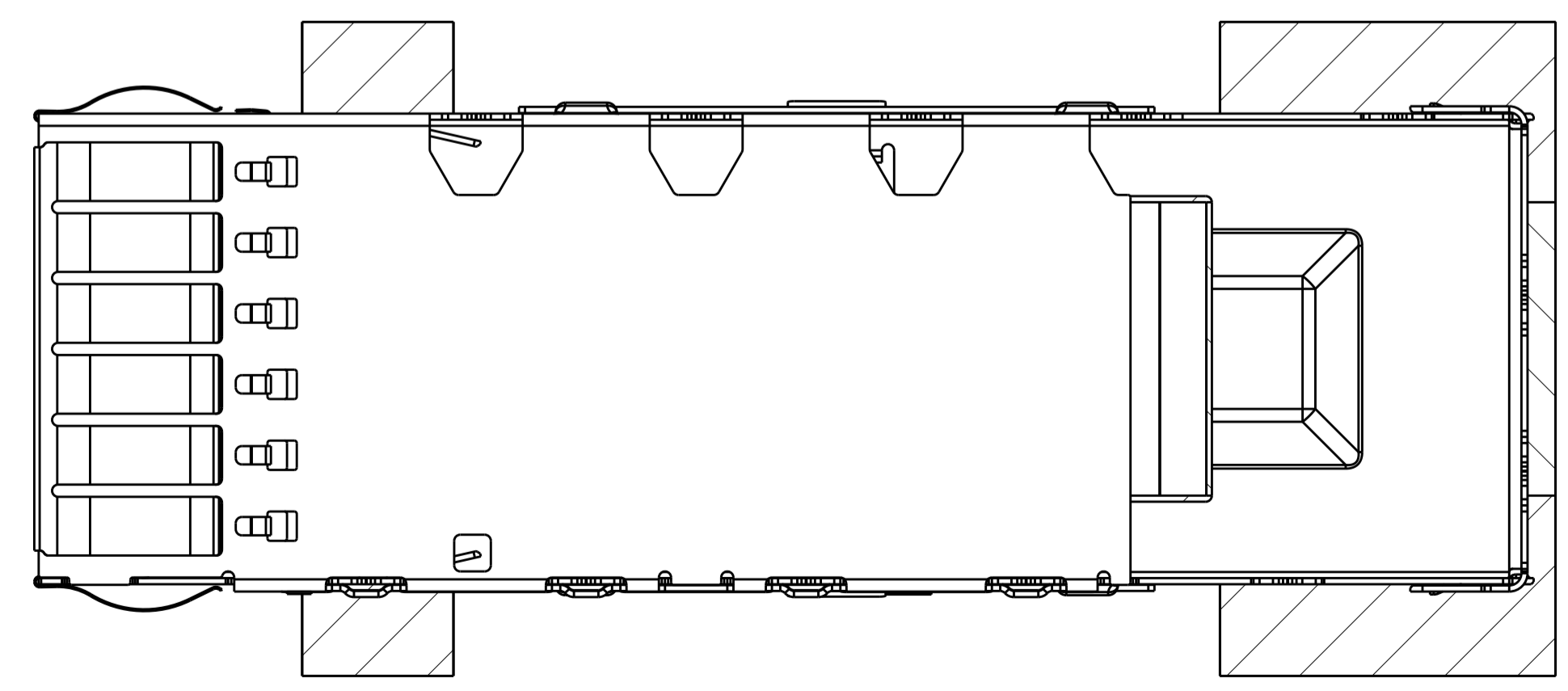
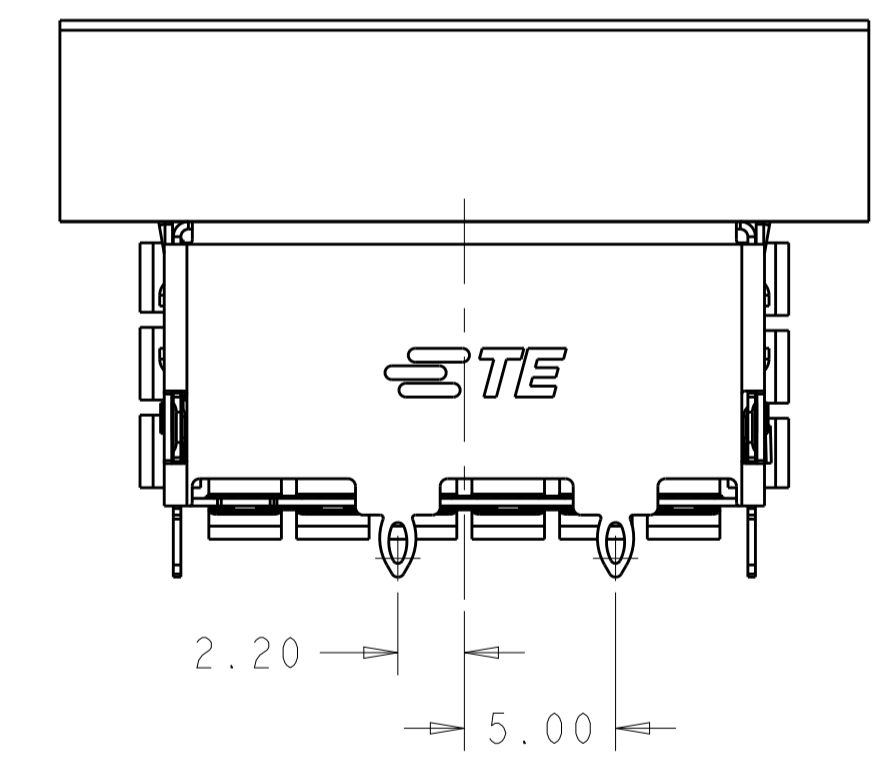

2301472-1 AS SHOWN

2	2301472-7
0	2301472-6
0	2301472-5
0	2301472-4
2	2301472-3
2	2301472-2
2	2301472-1
#	PART NUMBER
REAR EON	

THIS DRAWING IS A CONTROLLED DOCUMENT.		OWN: ROBERT GAN 10MAR2016	TE Connectivity
DIMENSIONS: mm		CHK: SEAN HAN 10MAR2016	
TOLERANCES UNLESS OTHERWISE SPECIFIED:		APVD: SEAN HAN 10MAR2016	NAME: CAGE ASSEMBLY, QSFP28, THRU BEZEL WITH EMI SPRING FINGER CUSTOMIZED HEAT SINK SIZE: CAGE CODE DRAWING NO: A100779C=2301472 RESTRICTED TO:
0 PLC ±0.25 1 PLC ±0.25 2 PLC ±0.25 3 PLC ±0.25 4 PLC ±0.100 ANGLES ±°		PRODUCT SPEC: 108-19428 APPLICATION SPEC: 114-32023 WEIGHT:	
MATERIAL:		FINISH:	CUSTOMER DRAWING SCALE: 2:1 SHEET 1 OF 7 REV 5

LOC		DIST		REVISIONS			
P.	LTN	DESCRIPTION	DATE	DWN	APVD		
-	-	SEE SHEET 1	-	-	-		

2301472-2 AS SHOWN

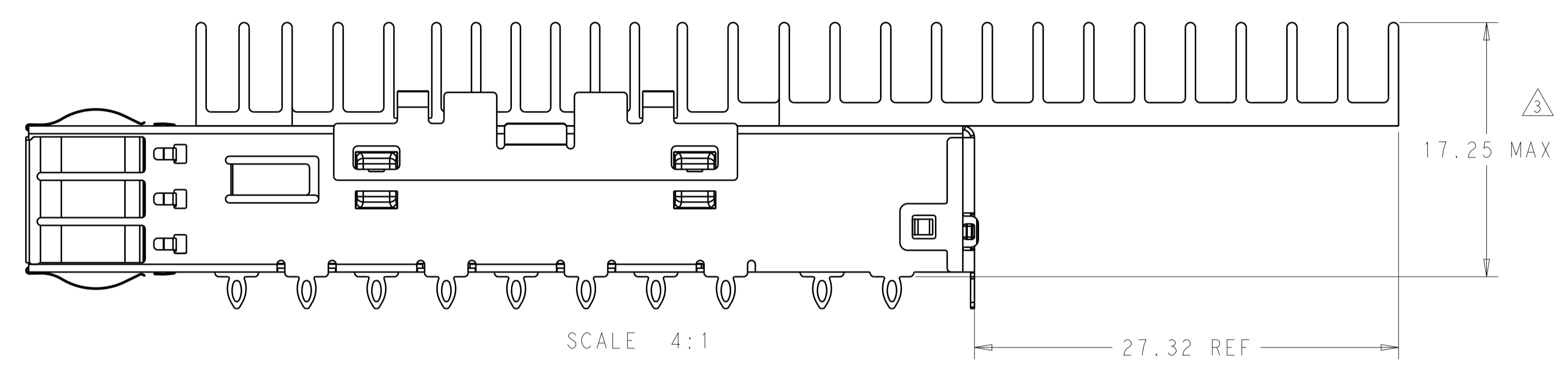
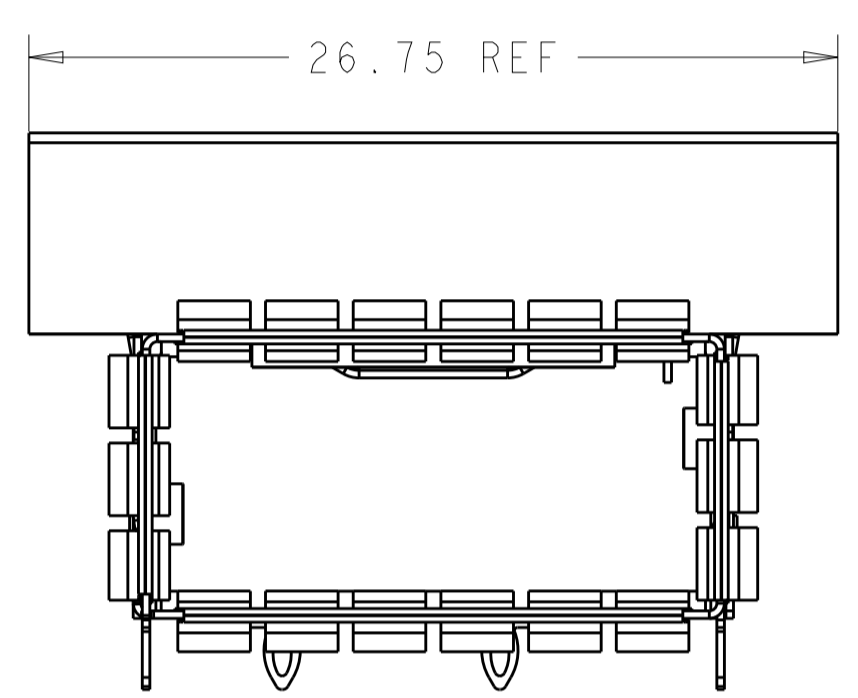
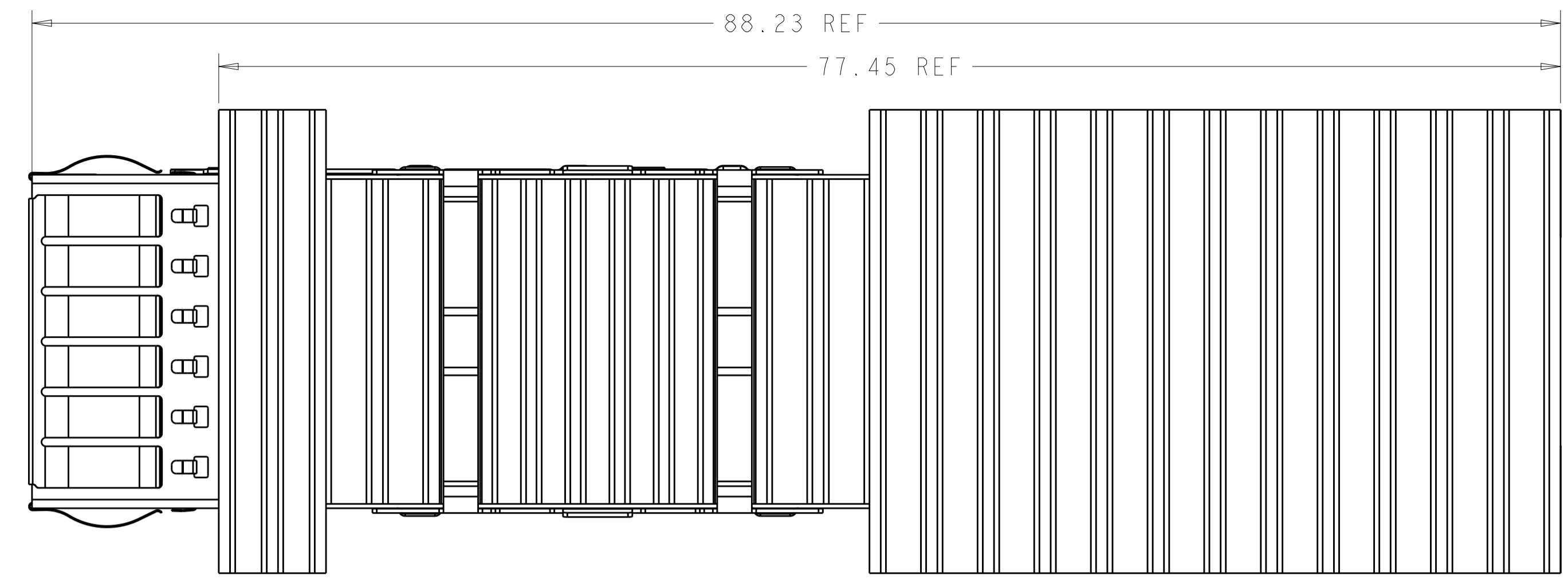

2301472-3 AS SHOWN

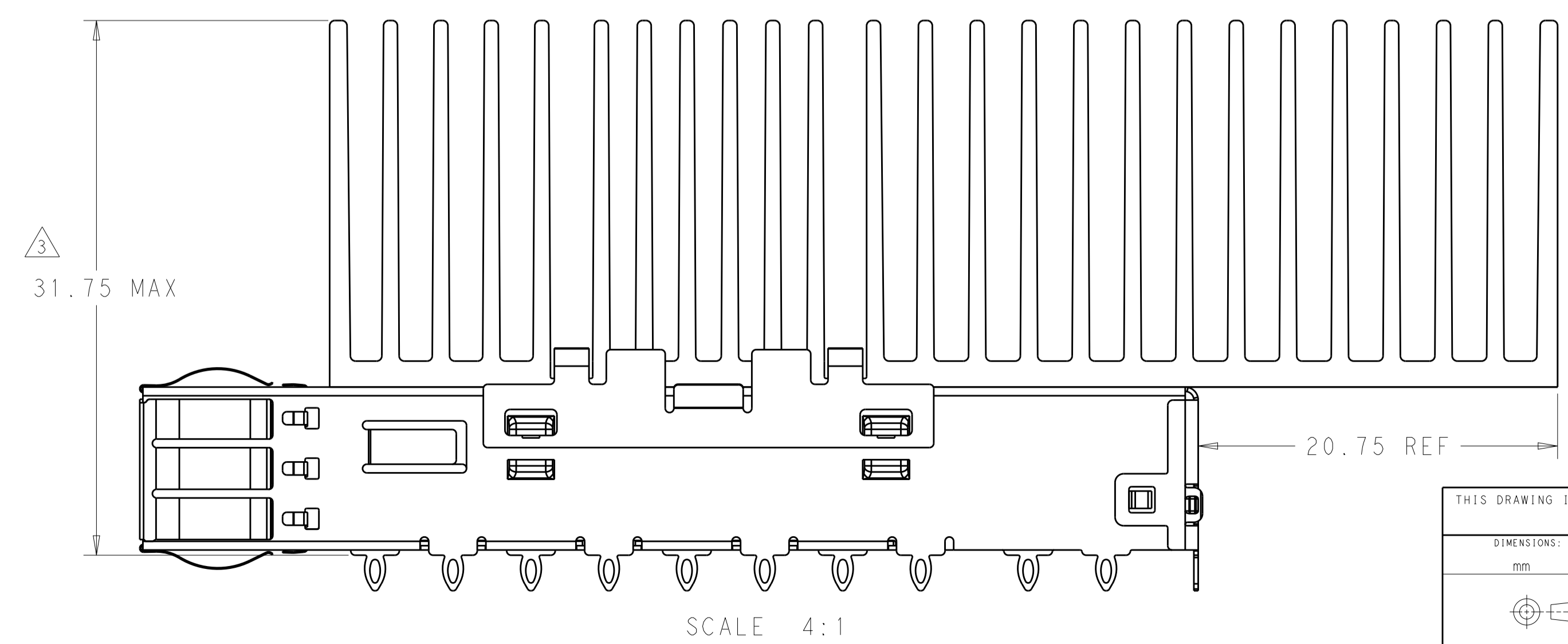
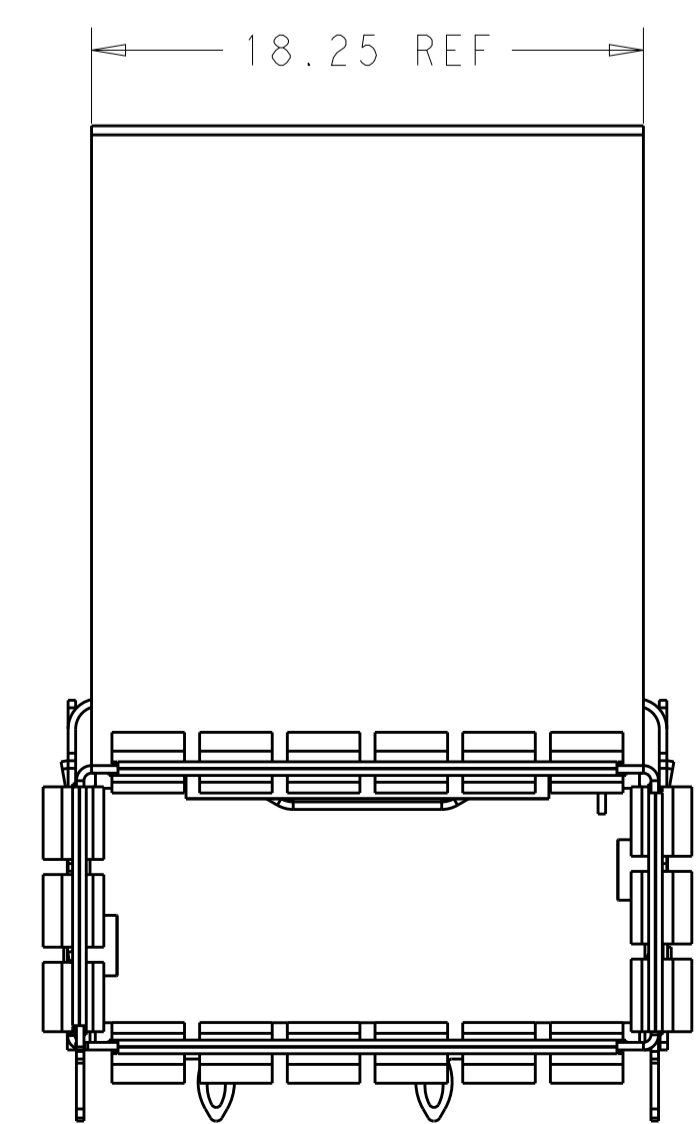
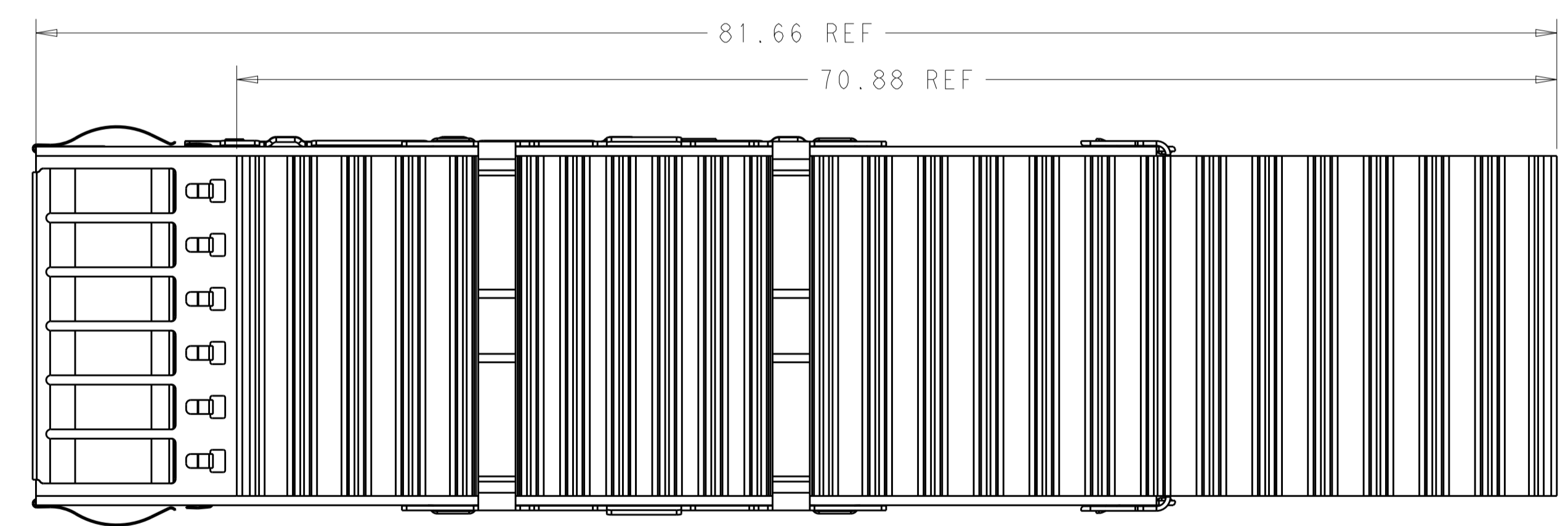

THIS DRAWING IS A CONTROLLED DOCUMENT.		DWN: ROBERT GAN 10MAR2016	TE Connectivity
DIMENSIONS: mm		CHK: SEAN HAN 10MAR2016	
TOLERANCES UNLESS OTHERWISE SPECIFIED: 0 PLC ±0.25 1 PLC ±0.25 2 PLC ±0.25 3 PLC ±0.25 4 PLC ±0.100 ANGLES ±°		NAME: CAGE ASSEMBLY, OSFP28, THRU BEZEL WITH EMI SPRING FINGER CUSTOMIZED HEAT SINK PRODUCT SPEC: 108-19428 APPLICATION SPEC: 114-32023 WEIGHT: - MATERIAL: - FINISH: -	SIZE: A100779 CAGE CODE: C=2301472 RESTRICTED TO: -
MATERIAL: -		CUSTOMER DRAWING	SCALE: 2:1 SHEET 2 OF 7 REV 5

LOC	DIST	REVISIONS			
P.	LTN	DESCRIPTION	DATE	DWN	APVD
-	-	SEE SHEET 1	-	-	-

2301472-4 AS SHOWN

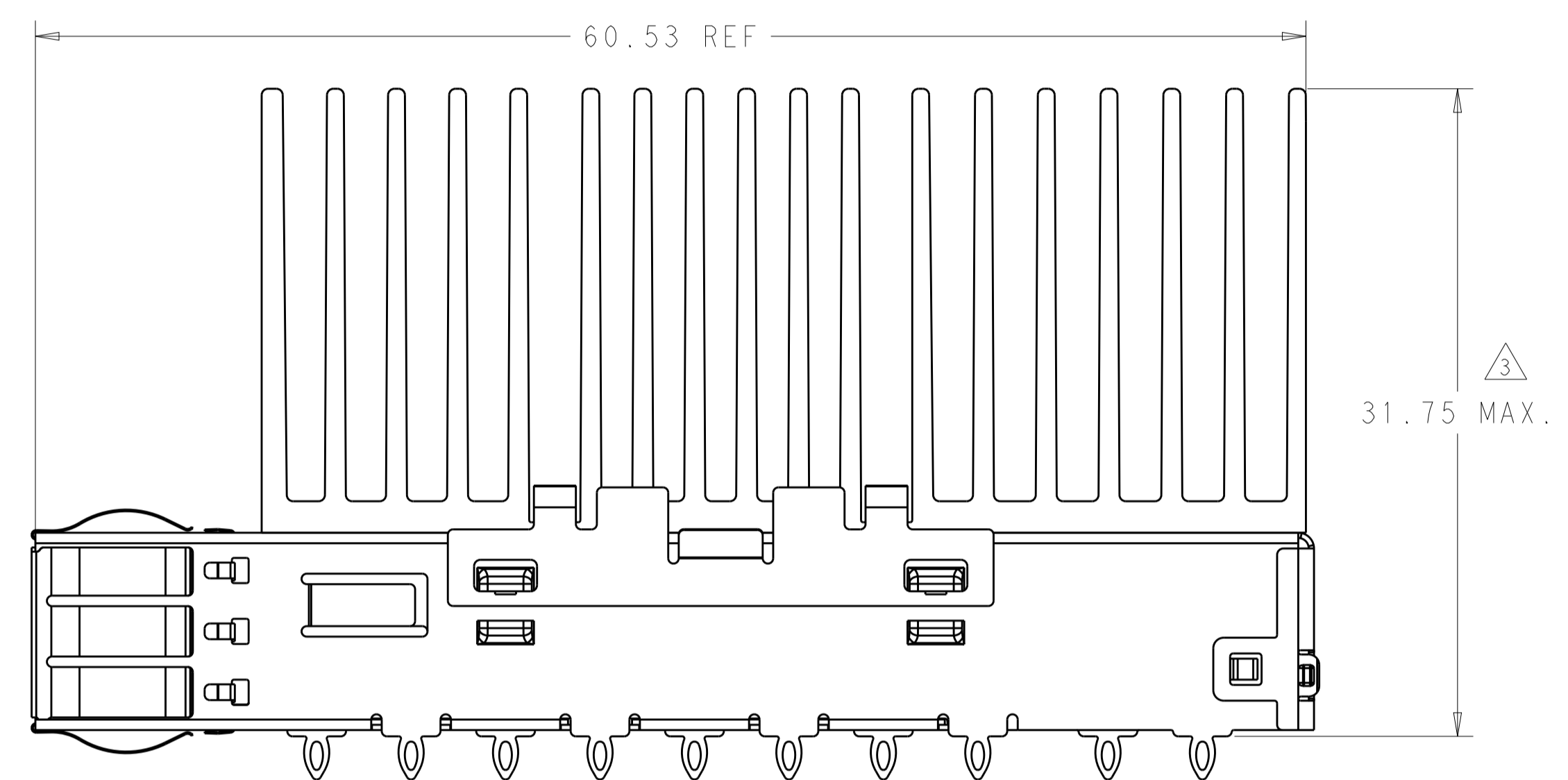
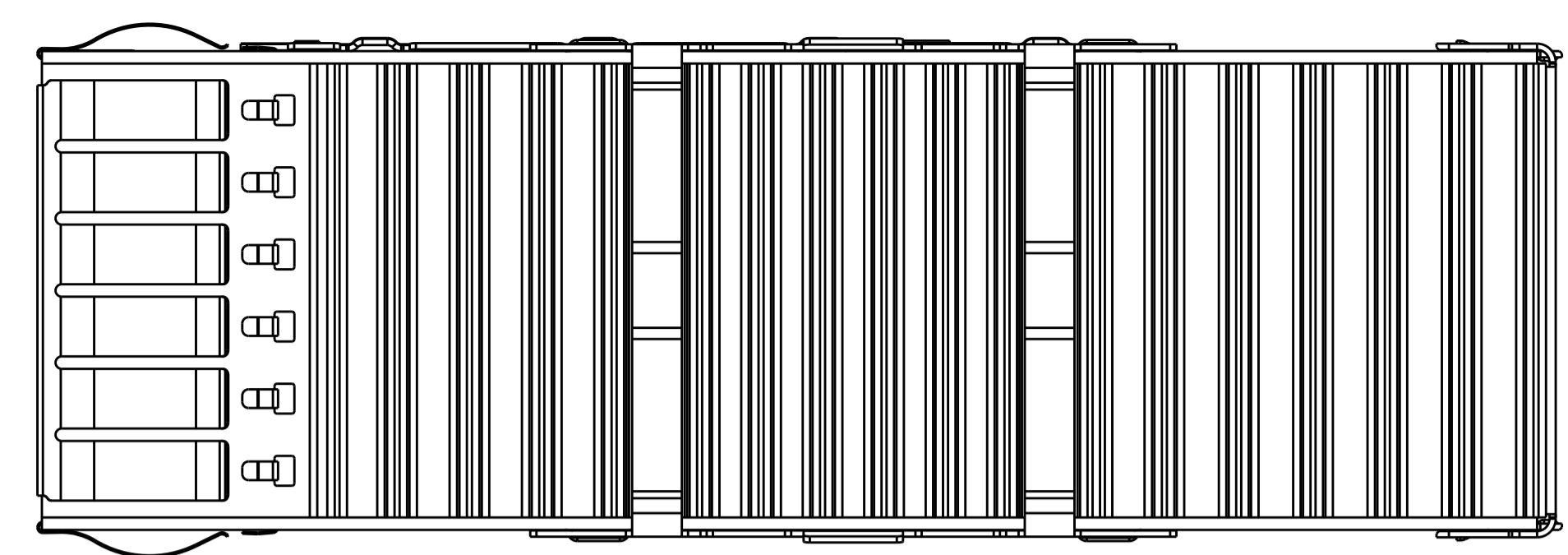
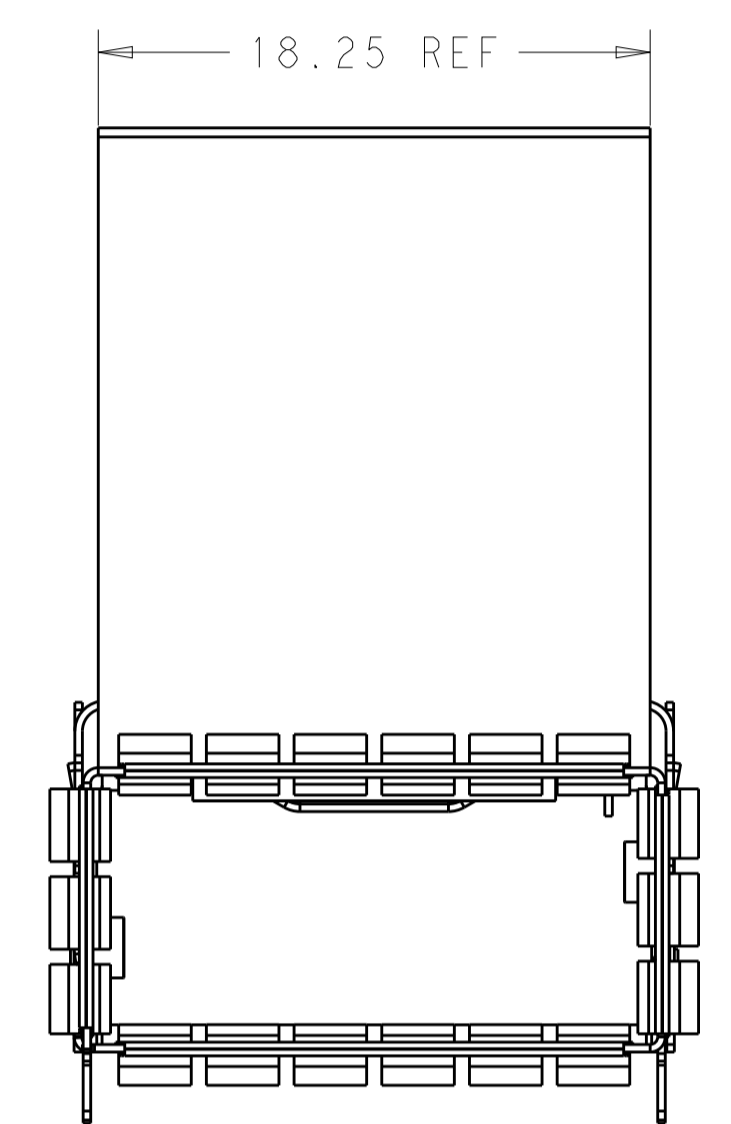

2301472-5 AS SHOWN

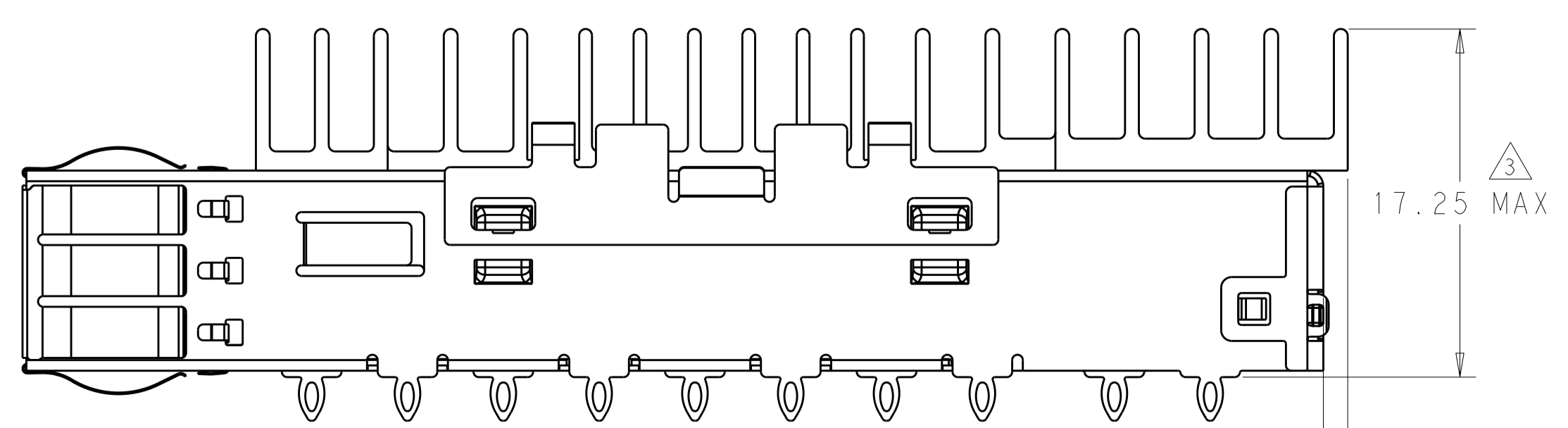
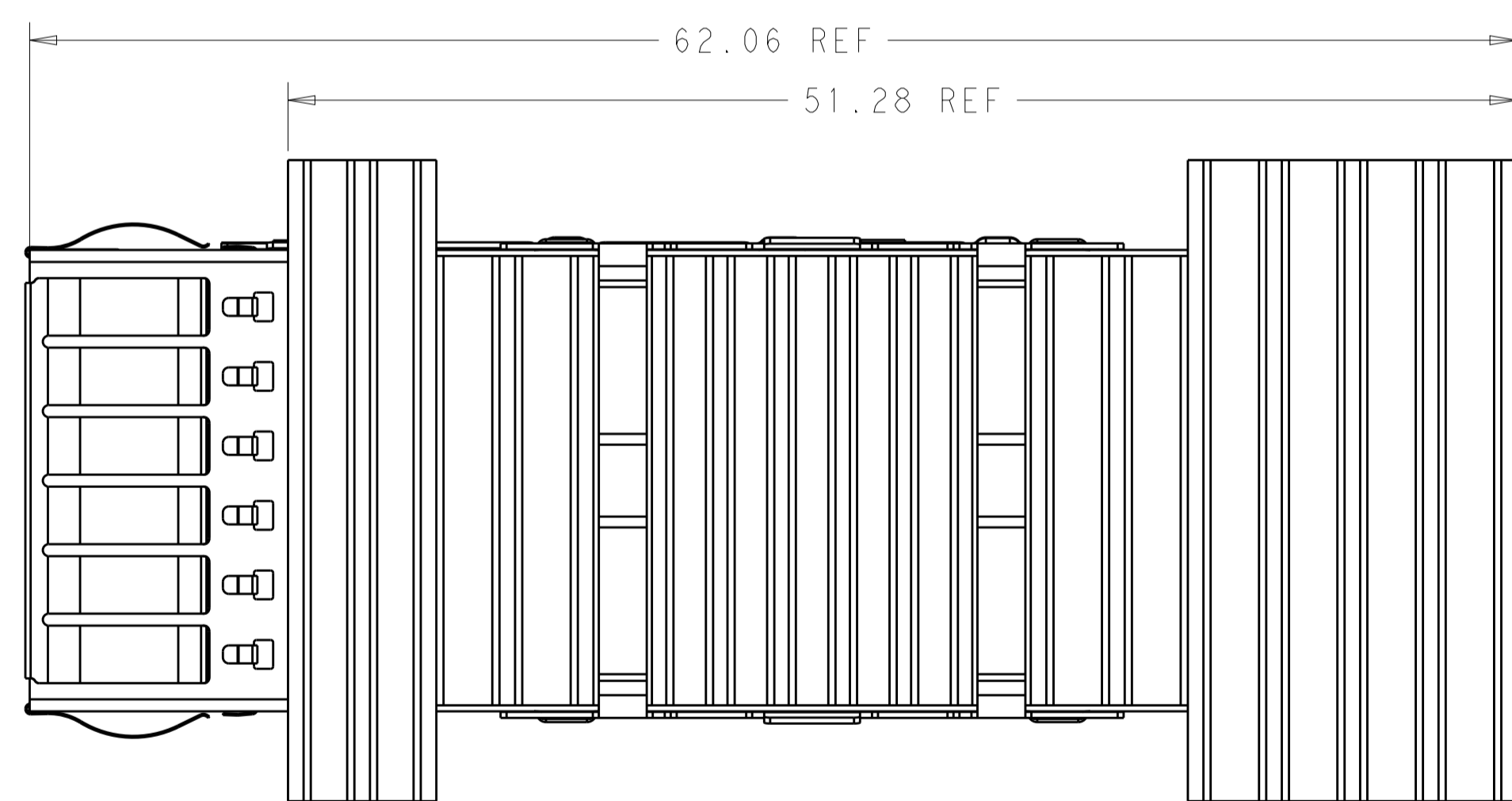
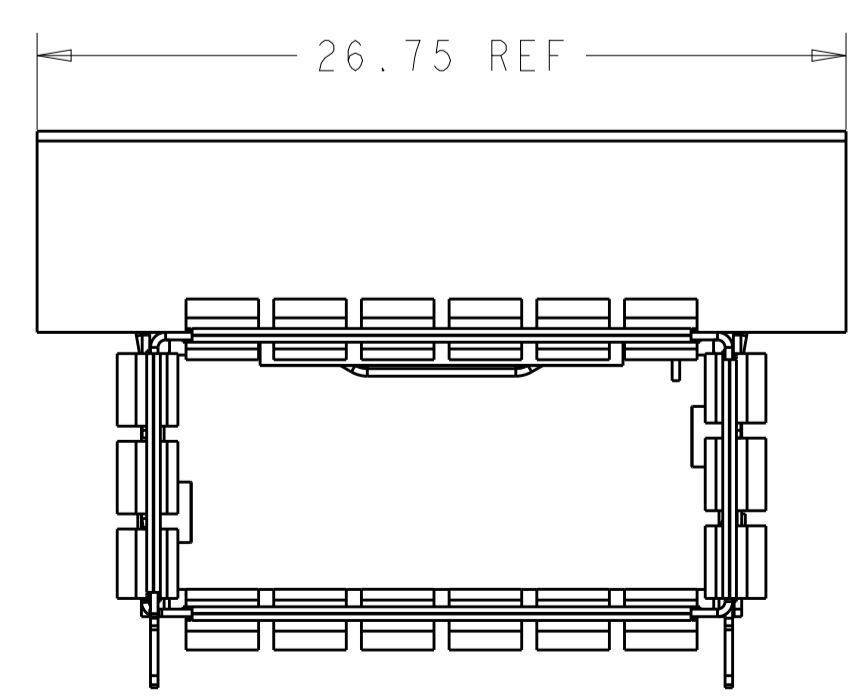

THIS DRAWING IS A CONTROLLED DOCUMENT.		OWN: ROBERT GAN 10MAR2016	TE Connectivity
DIMENSIONS: mm		CHK: -	
TOLERANCES UNLESS OTHERWISE SPECIFIED:		APVD: SEAN HAN 10MAR2016	NAME: CAGE ASSEMBLY, QSP28, THRU BEZEL WITH EMI SPRING FINGER CUSTOMIZED HEAT SINK
0 PLC ±0.25 1 PLC ±0.25 2 PLC ±0.25 3 PLC ±0.25 4 PLC ±0.100 ANGLES ±°		PRODUCT SPEC: 108-19428	
MATERIAL: -		APPLICATION SPEC: 114-32023	SIZE: A1
FINISH: -		WEIGHT: -	CAGE CODE: 2301472
CUSTOMER DRAWING		SCALE: 2:1	SHEET 3 OF 7
			REV 5

LOC		DIST		REVISIONS			
P.	LTN	DESCRIPTION	DATE	DWN	APVD		
-	-	SEE SHEET 1	-	-	-		

2301472-6 AS SHOWN

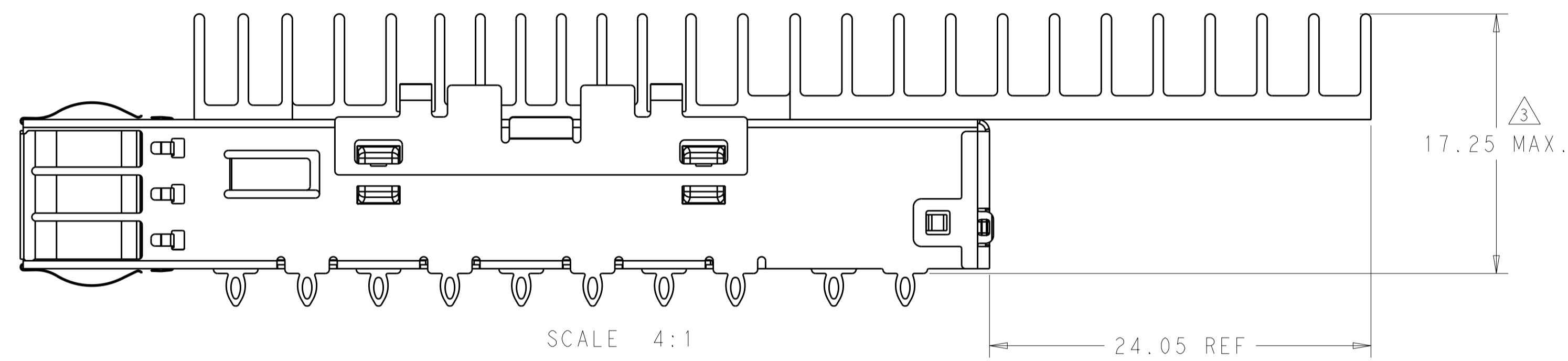
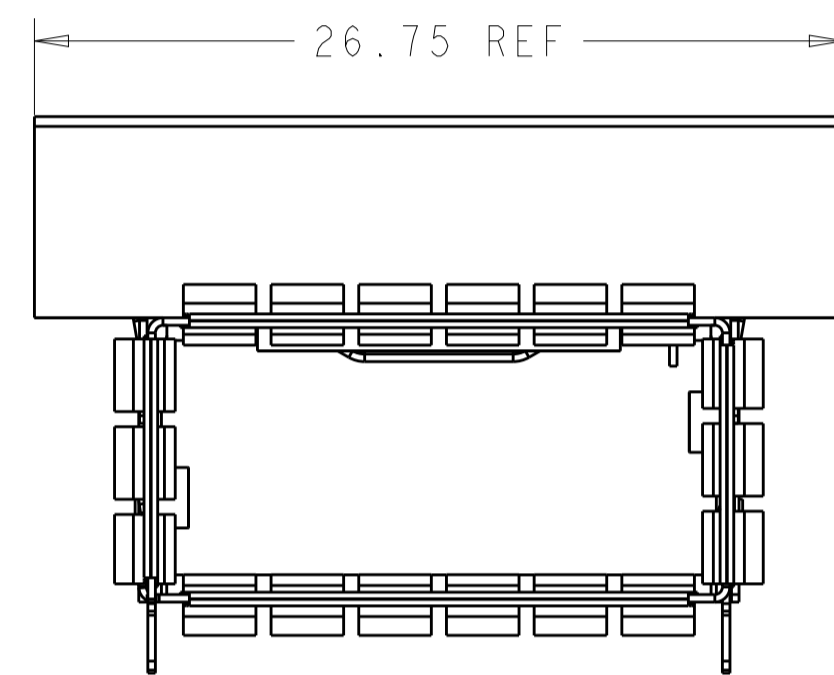
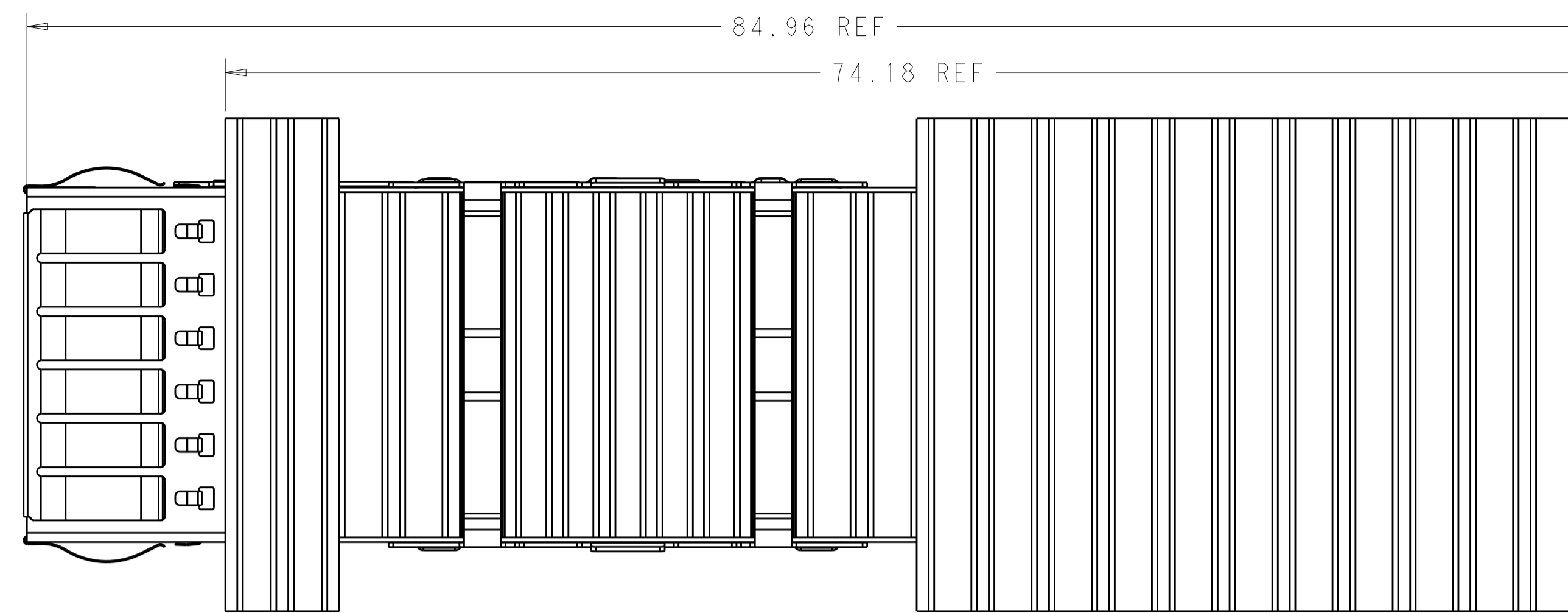

2301472-7 AS SHOWN

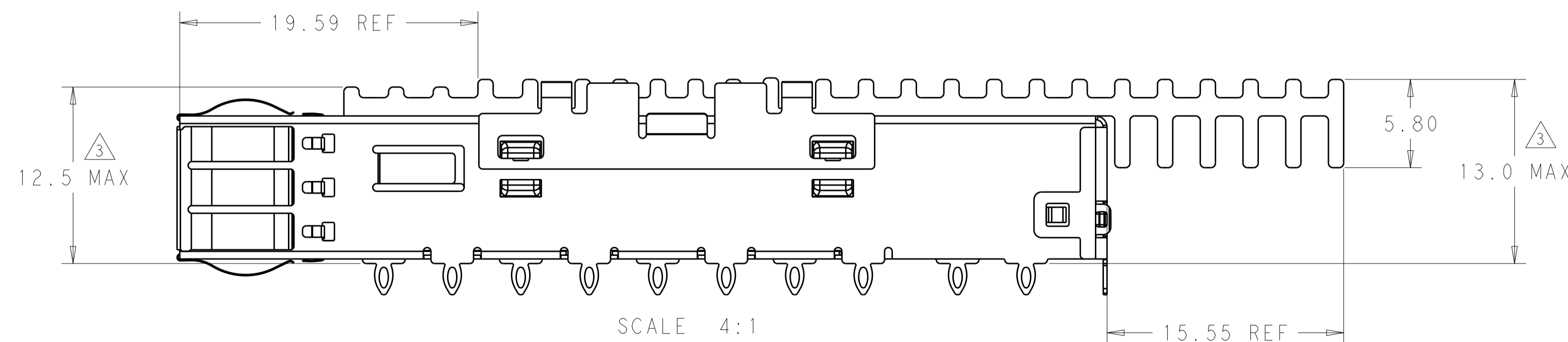
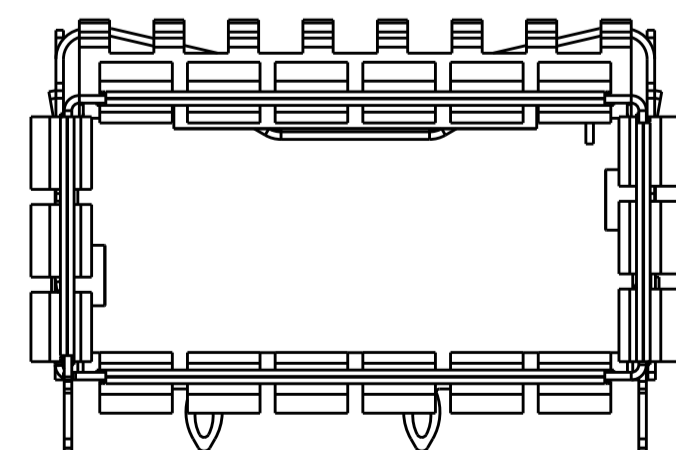
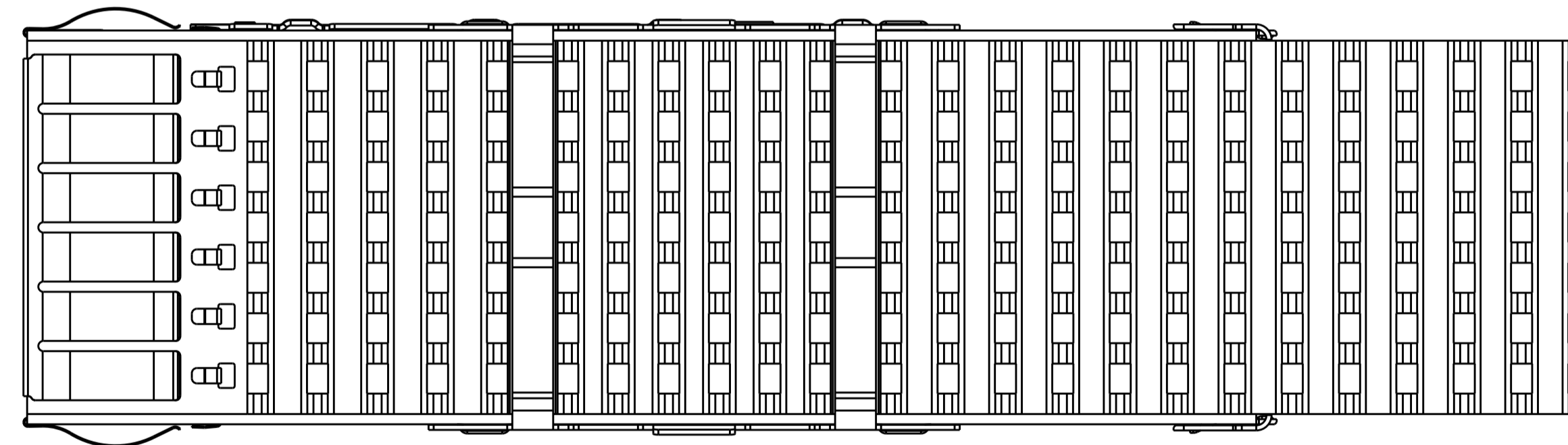

THIS DRAWING IS A CONTROLLED DOCUMENT.		OWN ROBERT GAN 10MAR2016	TE Connectivity
DIMENSIONS: mm		CHK -	
TOLERANCES UNLESS OTHERWISE SPECIFIED:		APVD SEAN HAN 10MAR2016	NAME CAGE ASSEMBLY, OSFP28, THRU BEZEL WITH EMI SPRING FINGER CUSTOMIZED HEAT SINK PRODUCT SPEC 108-19428 APPLICATION SPEC
0 PLC ±0.25 1 PLC ±0.25 2 PLC ±0.25 3 PLC ±0.100 4 PLC ± ANGLES ± FINISH ±		SIZE A100779 CAGE CODE C=2301472 DRAWING NO WEIGHT CUSTOMER DRAWING	
MATERIAL		RESTRICTED TO	SCALE 2:1 SHEET 4 OF 7 REV 5

LOC		DIST		REVISIONS			
P	LTN	DESCRIPTION	DATE	DMN	APVD		
-	-	SEE SHEET 1	-	-	-		

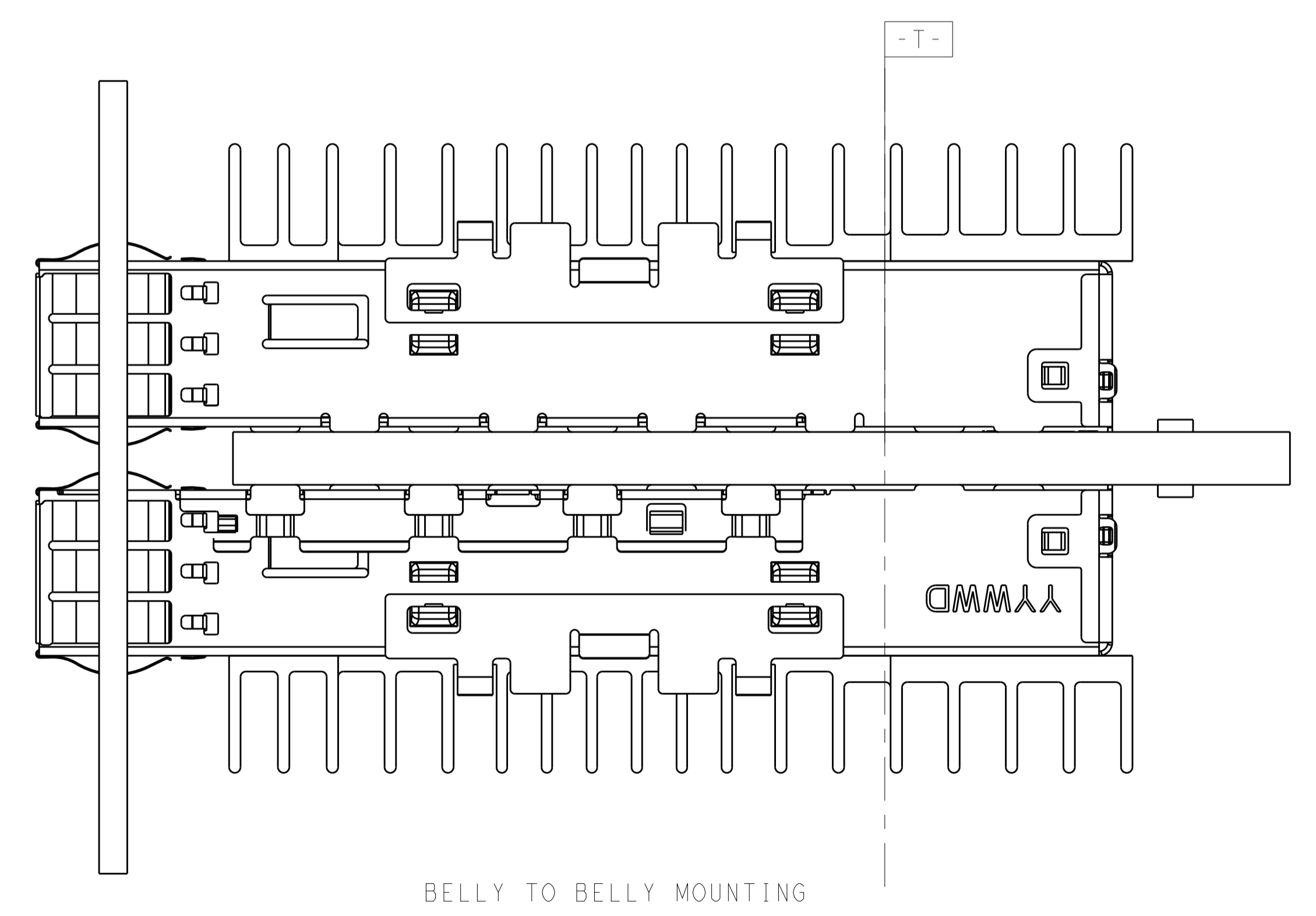
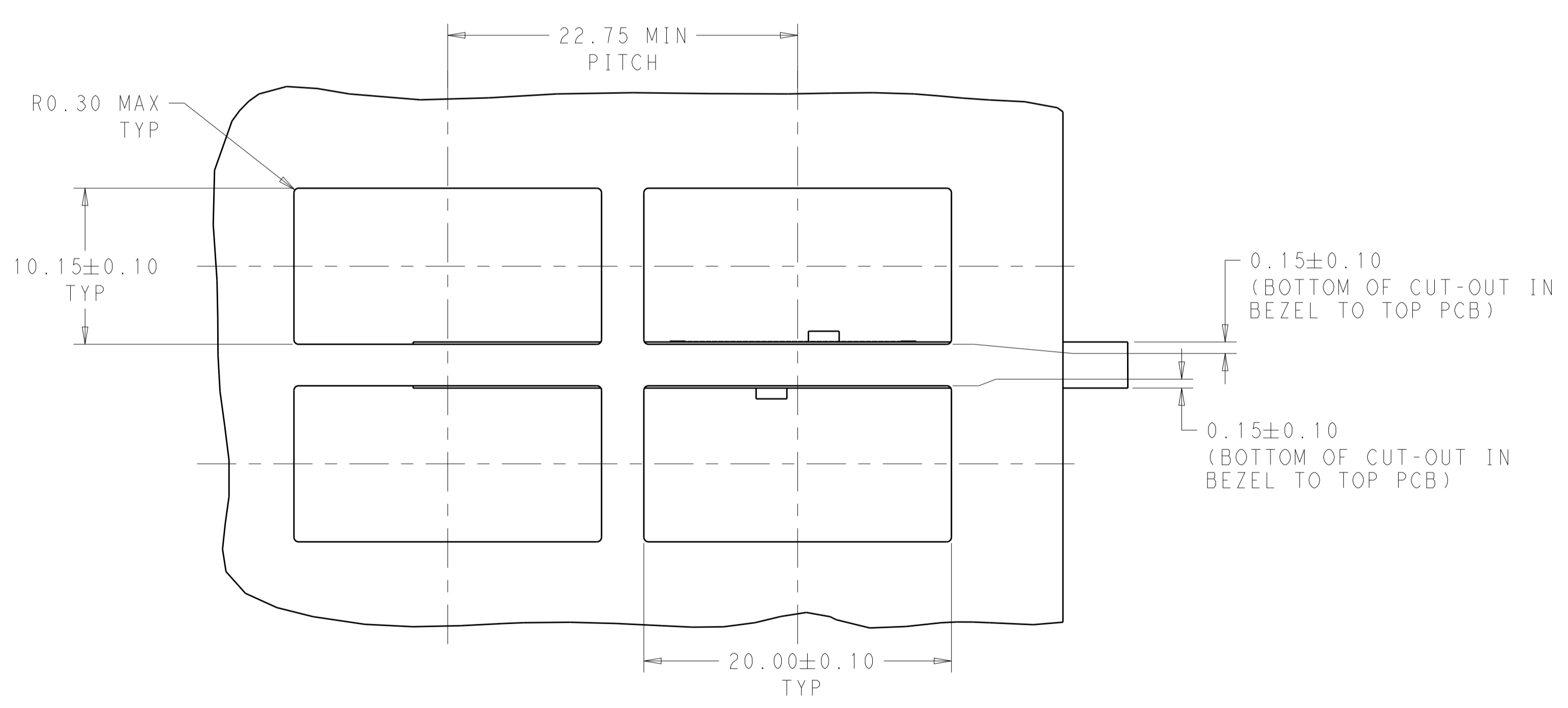
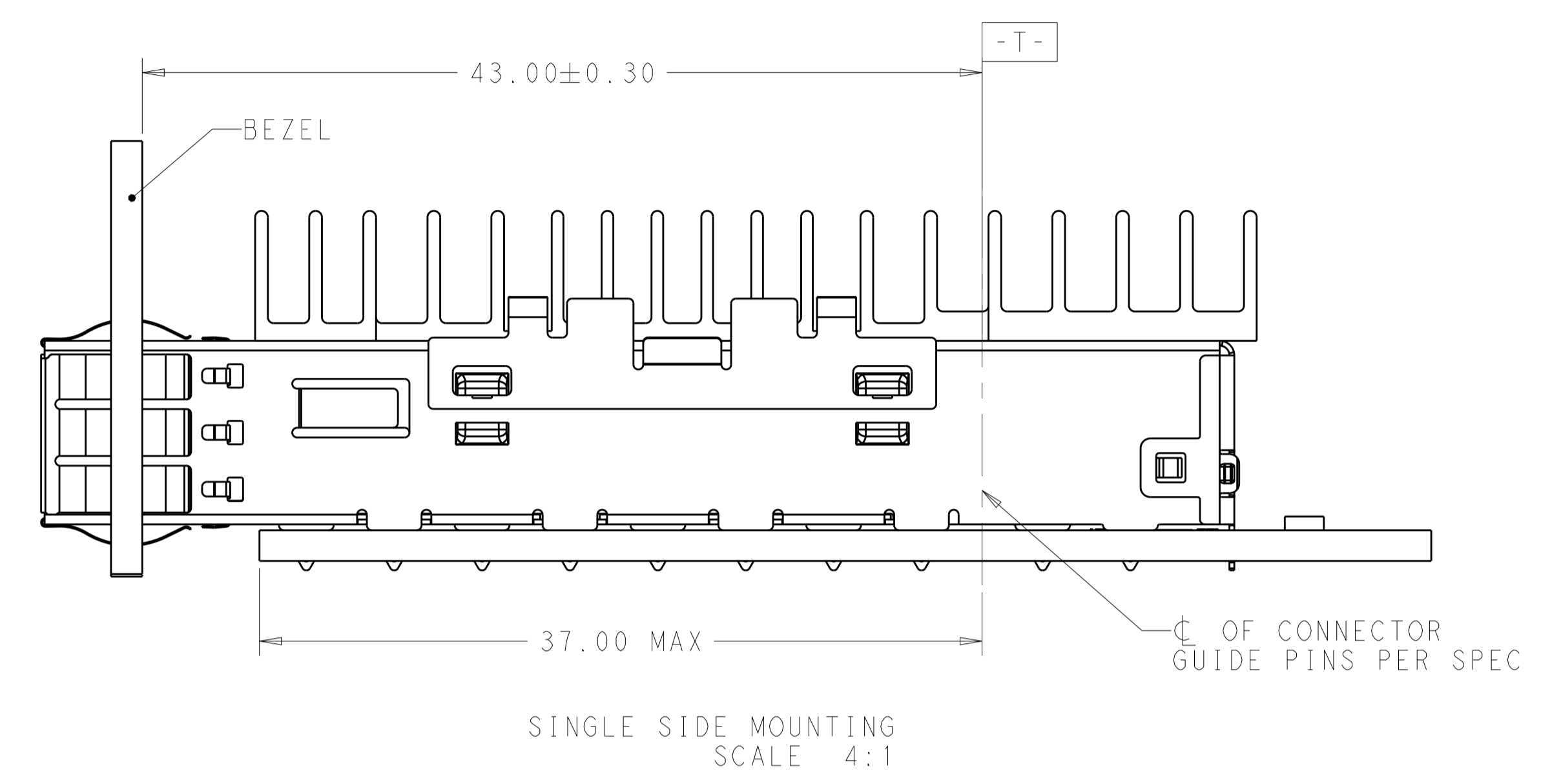
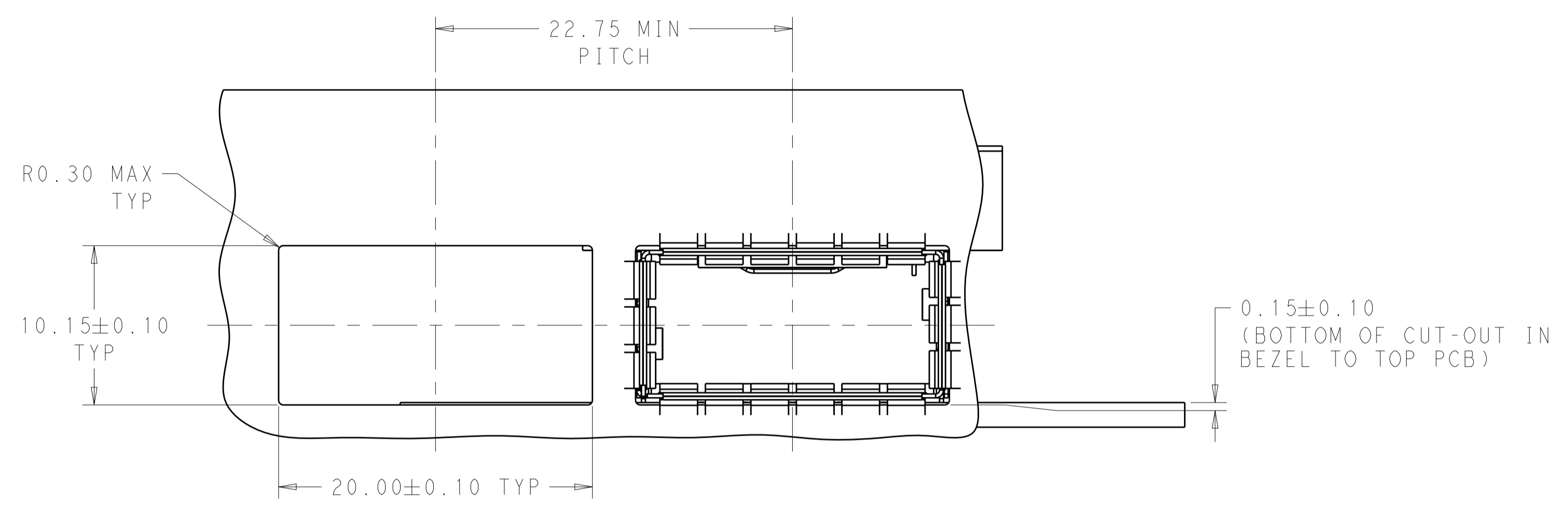

SCALE 4:1

THIS DRAWING IS A CONTROLLED DOCUMENT.		DMN: ROBERT GAN 10MAR2016	TE Connectivity
DIMENSIONS: mm		CHK: SEAN HAN 10MAR2016	
TOLERANCES UNLESS OTHERWISE SPECIFIED:		APVD: SEAN HAN 10MAR2016	NAME: CAGE ASSEMBLY, OSFP28, THRU BEZEL WITH EMI SPRING FINGER CUSTOMIZED HEAT SINK
0 PLC	±0.25	PRODUCT SPEC	108-19428
1 PLC	±0.25	APPLICATION SPEC	114-32023
2 PLC	±0.25	SIZE	A100779C=2301472
3 PLC	±0.25	WEIGHT	
4 PLC	±0.100	CUSTOMER DRAWING	SCALE 2:1 SHEET 5 OF 7 REV 5
ANGLES	±°		
FINISH			

LOC	DIST	REVISIONS			
P.	LTH	DESCRIPTION	DATE	DMN	APVD
-	-	SEE SHEET 1	-	-	-

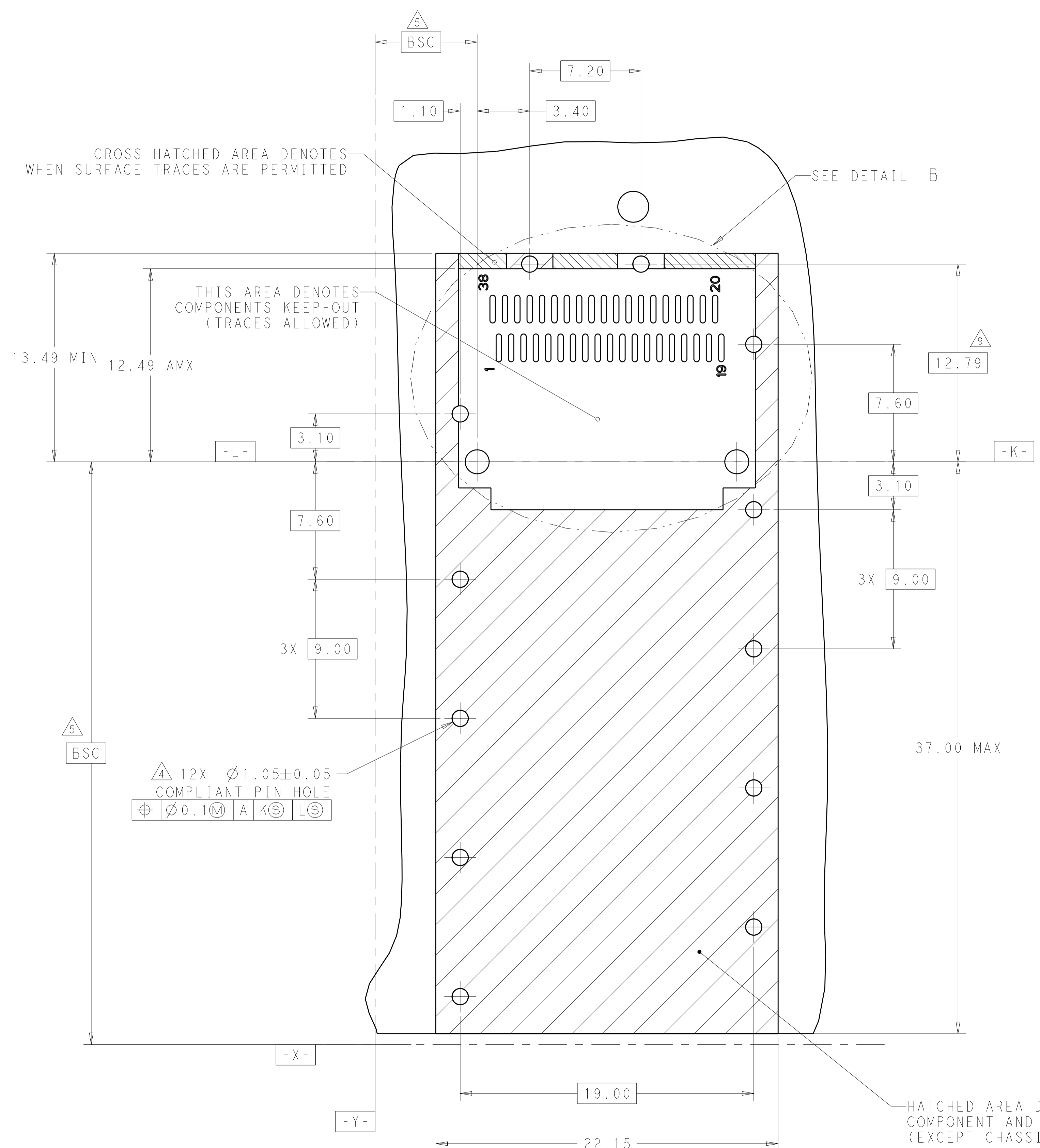

RECOMMENDED PCB LAYOUT
 SINGLE TYPE OF 2 REAR HOLES OF LEGS
 PCB TOLERANCE: ± 0.05
 SCALE 6:1

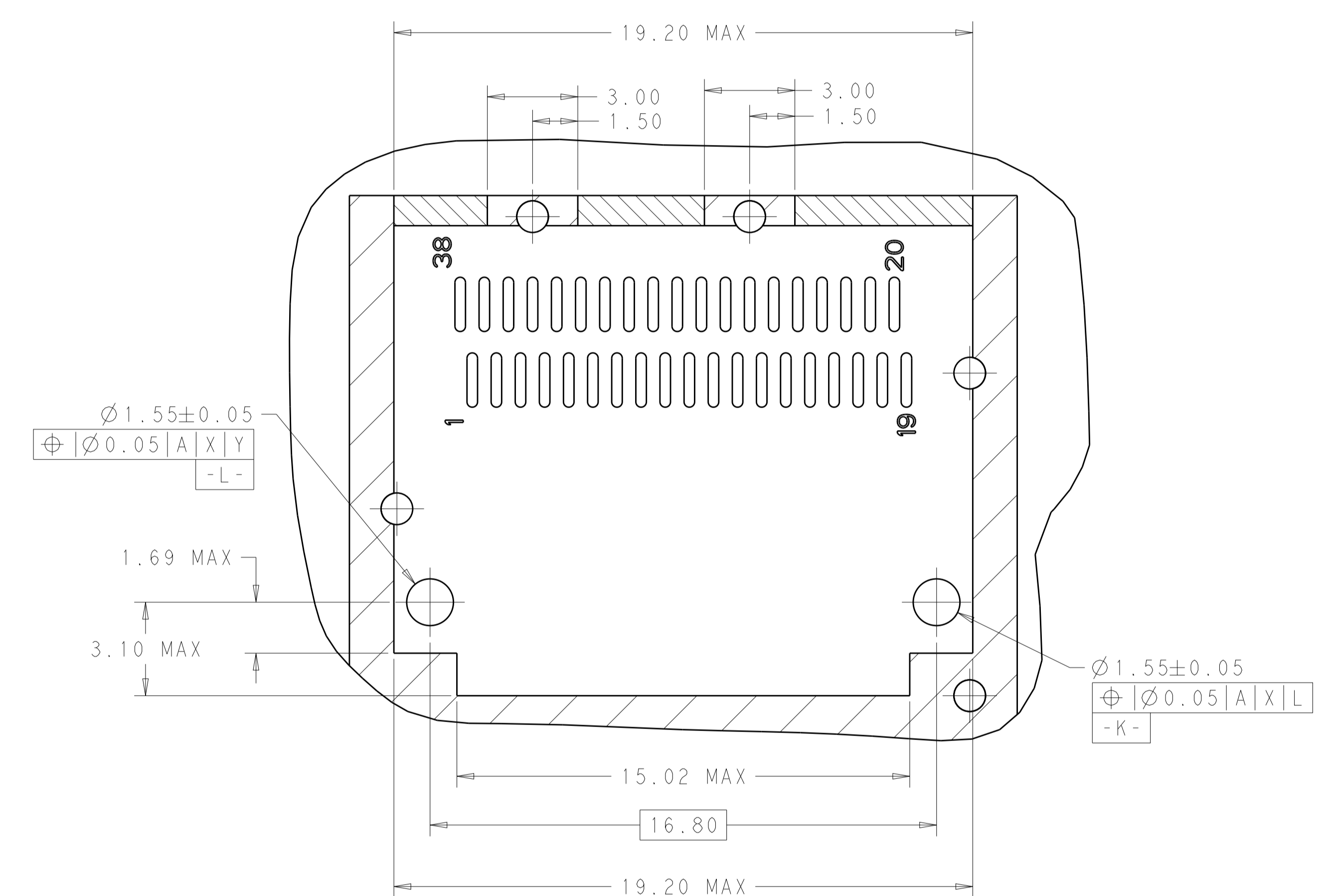

DETAIL B
 SCALE 8:1

THIS DRAWING IS A CONTROLLED DOCUMENT.		DMN ROBERT GAN 10MAR2016	TE Connectivity
DIMENSIONS: mm		CHK -	
TOLERANCES UNLESS OTHERWISE SPECIFIED:		APVD SEAN HAN 10MAR2016	NAME CAGE ASSEMBLY, QSPF28, THRU BEZEL WITH EMI SPRING FINGER CUSTOMIZED HEAT SINK PRODUCT SPEC 108-19428 APPLICATION SPEC
0 PLC ± 0.25 1 PLC ± 0.25 2 PLC ± 0.25 3 PLC ± 0.100 4 PLC \pm ANGLES \pm FINISH \pm		SIZE CAGE CODE DRAWING NO A100779C=2301472 WEIGHT CUSTOMER DRAWING	
MATERIAL		114-32023	RESTRICTED TO
SCALE 2:1		SHEET 6 OF 7	REV 5

LOC	DIST	REVISIONS			
P.	LTH	DESCRIPTION	DATE	DMN	APVD
-	-	SEE SHEET 1	-	-	-

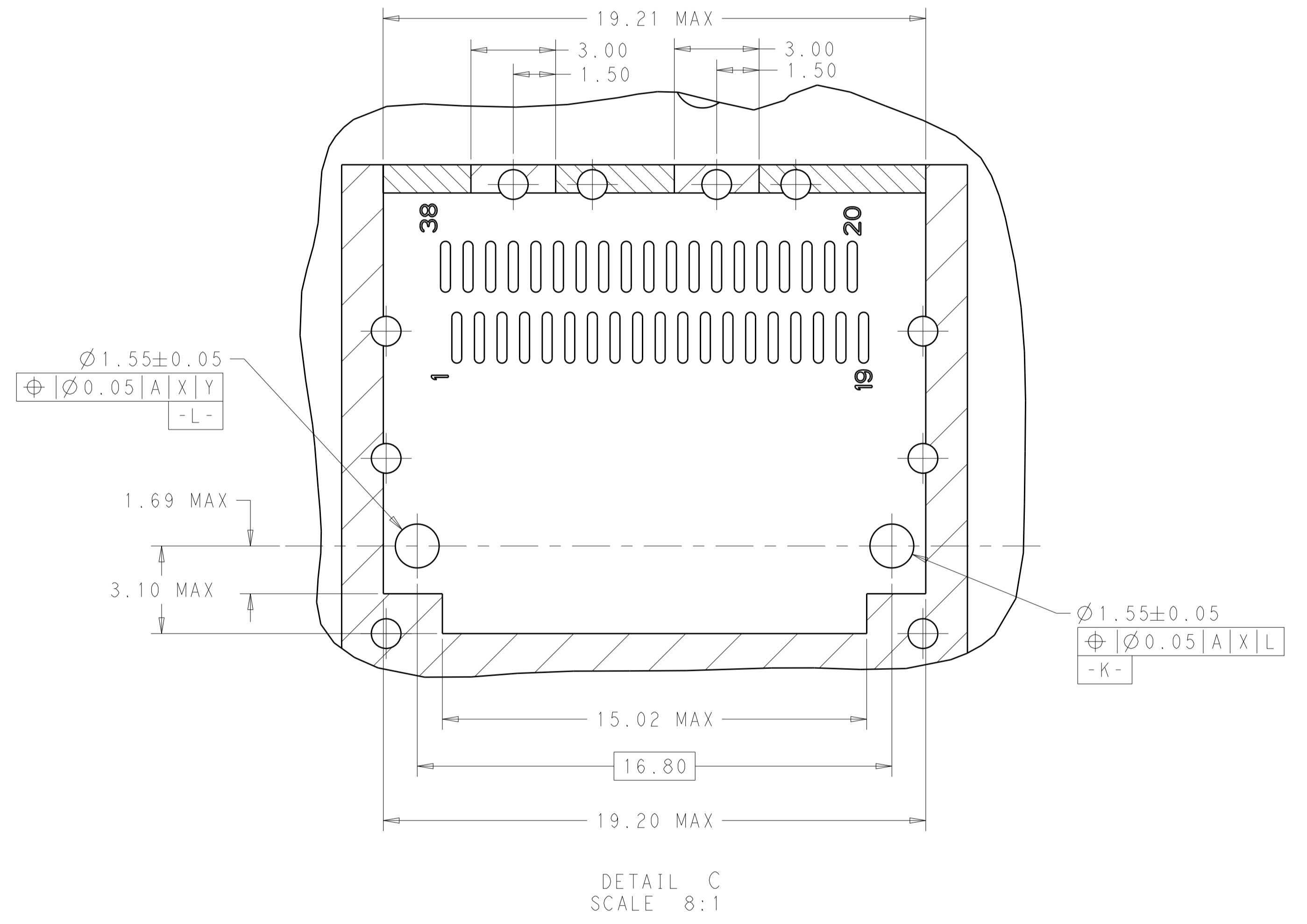
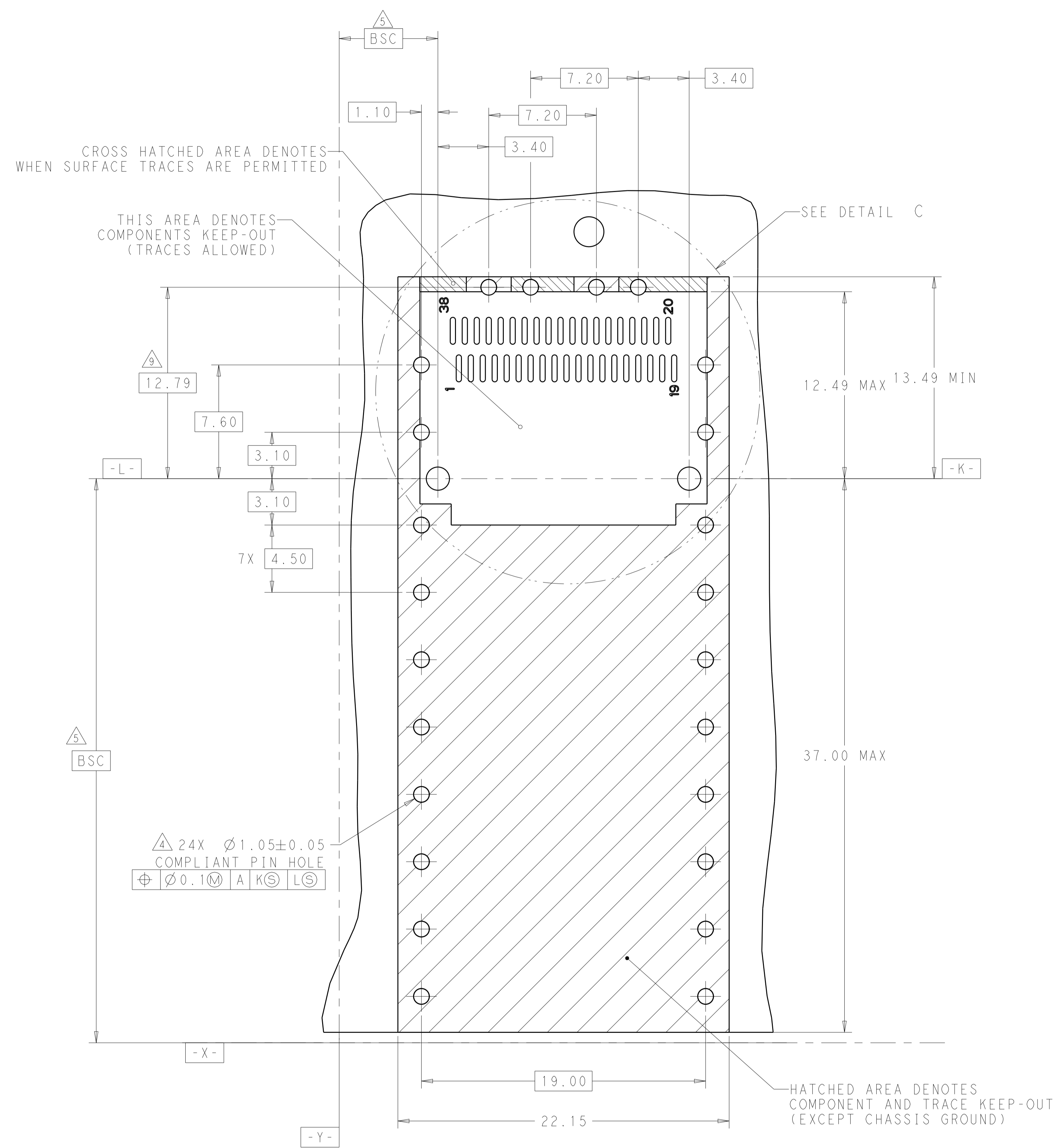

THIS DRAWING IS A CONTROLLED DOCUMENT.		DMN: ROBERT GAN 10MAR2016	TE Connectivity
DIMENSIONS: mm		CHK: SEAN HAN 10MAR2016	
TOLERANCES UNLESS OTHERWISE SPECIFIED:		APVD: SEAN HAN 10MAR2016	NAME: CAGE ASSEMBLY, QSPF28, THRU BEZEL WITH EMI SPRING FINGER CUSTOMIZED HEAT SINK
0 PLC ±0.25	1 PLC ±0.25	PRODUCT SPEC: 108-19428	SIZE: A100779C=2301472
2 PLC ±0.20	3 PLC ±0.100	APPLICATION SPEC: 114-32023	RESTRICTED TO: -
4 PLC ±	ANGLES ±	WEIGHT: -	SCALE: 2:1 SHEET 7 OF 7 REV 5
MATERIAL: -	FINISH: -	CUSTOMER DRAWING	