

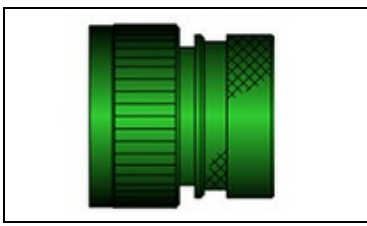

218M524-19B Product Details

[Share](#) [Print](#) [Email](#)

218M524-19B

Braid, Fixed, Spin and Tinel Lock Adapters

Not EU RoHS or ELV Compliant

Product Highlights:

- Applies To Cable
- Military Style Number = MIL-C-5015
- Style = Solid
- Connector Code = 18
- Straight

[View all Features](#)

Quick Links

- ▶ [Pricing & Availability](#)
- ▶ [Search for Tooling](#)
- ▶ [Product Feature Selector](#)
- ▶ [Contact Us About This Product](#)

TE Internal Number: 946791-000



[Add to My Part List](#)
[Request Sample](#)
[Find Similar Products](#)
[Buy Product](#)

Documentation & Additional Information

Product Drawings:

- [Adapter, Spin Coupling Code 18 \(PDF, English\)](#)

Catalog Pages/Data Sheets:

- None Available

Product Specifications:

- None Available

Application Specifications:

- None Available

Instruction Sheets:

- None Available

CAD Files:

- None Available

Related Products:

- [Tooling](#)

[List all Documents](#)

Feedback

Product Features (Please use the Product Drawing for all design activity)

Product Type Features:

- [Style](#) = Solid
- [Angle](#) = Straight
- Connector Shell Size = 24
- Finish = Cadmium Plating over Electroless Nickel
- Color = Olive Drab

Dimensions:

- [Boot Diameter \(mm \[in\]\)](#) = 40.50 [1.594]

Body Features:

- [Connector Code](#) = 18
- Material = Aluminium Alloy

Industry Standards:

- Military Style Number = MIL-C-5015
- [RoHS/ELV Compliance](#) = Not ELV/RoHS compliant
- [Lead Free Solder Processes](#) = Not relevant for lead free process

Conditions for Usage:

- Applies To = Cable

Other:

- Brand = Raychem
- Comment = For Specific shell size information, refer to Harnware™ or Catalouge.

Corporate Information | Quick Links | Customer Support | Keep Me Informed

- Corporate Information**
- [About TE](#)
 - [Investors](#)
 - [News Room](#)
 - [Supplier Portal](#)
 - [Careers](#)
 - [Terms & Conditions](#)
 - [Privacy Policy](#)
 - [AODA Accessibility Policy](#)
 - [AODA Multi-Year Accessibility Plan](#)

- Quick Links**
- [Distributor Inventory](#)
 - [Product Cross Reference](#)
 - [Documents & Drawings](#)
 - [Product Compliance Support Center](#)
 - [Site Map](#)

- Customer Support**
- [Email or Chat With Us](#)
 - [Find a Phone Number](#)
 - [Knowledge Base](#)
 - [Manage Your Account](#)

Keep Me Informed

