

THIS DRAWING IS UNPUBLISHED. RELEASED FOR PUBLICATION
 © COPYRIGHT - By - ALL RIGHTS RESERVED.

P	LR	DESCRIPTION	DATE	DN	APVD
C		ECR-17-002010	2-2017	RS	LZ

PART NUMBER	REV	FIRST USED	POWER UNIT	FEED TYPE	DESCRIPTION
1852621-2	C	565435-5	BENCH MODEL K	PRE FEED	CUTS CARRIER
1852621-3	C	354500-1	BENCH MODEL G	PRE FEED	CUTS CARRIER
7-1852621-7	A	-	-	-	SPARE PARTS

TERMINAL NAME: -					
184437					
63535-1					
CRIMPING DATA					
PAD LTR	CRIMP HEIGHT		WIRE SIZE		
A	.035 ±.002		30 SOLID		
B	-		-		
C	-		-		
D	-		-		
CRIMP	SIZE	TYPE	RANGE		
WIRE	.042	F	30		
PRESS NO.	INSUL		-		
WIRE STRIP LENGTH	TERM APPL SPEC	FEED	APPL INSTRUCTION	SET UP GAGE	LAYOUT
-	-	.436	-	-	L1339

- 1 RECOMMENDED SPARE PARTS.
- 2 GREASE LIGHTLY.
- 3 LUBRICATE DAILY USING NO. 20 MACHINE OIL.
- 4 GUARD MUST BE IN PLACE WHEN OPERATING APPLICATOR IN BENCH MACHINE.
- 5 MODIFY LAMINATER SPACER AS REQUIRED TO REMOVE CLEARANCE IN FEED LINKAGE.
- 6 LUBRICATION OF TERMINAL IS REQUIRED.

						181
						180
						179
						178
						177
						176
						175
						174
						173
						172
						171
						170
						169
						168
						167
						166
						165
						164
						163
						162
						161
						160
						159
						158
						157
						156
						155
						154
						153
						152
						151
						150
						149
						148
						147
						146
						145
						144
						143
						142
						141
-77	-3	-2	U/M	PART NO	DESCRIPTION	ITEM NO

						140
						139
						138
						137
						136
						135
						134
						133
						132
						131
						130
						129
						128
						127
						126
						125
						124
						123
						122
						121
						120
						119
						118
						117
						116
						115
						114
						113
						112
						111
						110
						109
						108
						107
						106
						105
						104
						103
						102
						101
						100
						99
						98
						97
						96
						95
						94
						93
						92
						91
						90
						89
						88
						87
						86
						85
						84
						83
						82
						81
						80
						79
						78
						77
						76
						75
						74
						73
						72
						71
-77	-3	-2	U/M	PART NO	DESCRIPTION	ITEM NO

						70
						69
						68
						67
						66
						65
						64
						63
						62
						61
						60
						59
						58
						57
						56
						55
						54
						53
						52
						51
						50
						49
						48
						47
						46
						45
						44
						43
						42
						41
						40
						39
						38
						37
						36
						35
						34
						33
						32
						31
						30
						29
						28
						27
						26
						25
						24
						23
						22
						21
						20
						19
						18
						17
						16
						15
						14
						13
						12
						11
						10
						9
						8
						7
						6
						5
						4
						3
						2
						1
-77	-3	-2	U/M	PART NO	DESCRIPTION	ITEM NO

QTY REQD PER ASSY		PARTS LIST		QTY REQD PER ASSY		PARTS LIST		QTY REQD PER ASSY		PARTS LIST	
THIS DRAWING IS A CONTROLLED DOCUMENT. DWN: M. YOUNGER 04JAN2008 DIMENSIONS: INCHES TOLERANCES UNLESS OTHERWISE SPECIFIED: 0 PLC ±.0005 1 PLC ±.0005 2 PLC ±.0005 3 PLC ±.0005 4 PLC ±.0005 ANGLES FINISH											
MATERIAL				WEIGHT 0				CUSTOMER DRAWING			
APVD: T. FLIN				APPL SPEC				RESTRICTED TO			
SIZE: A1				CAGE CODE: 00779				DRAWING NO: 1852621			
SCALE: -				SHEET 1 OF 2				REV C			

REVISIONS				
P	LTR	DESCRIPTION	DATE	APPV
-	-	SEE SHEET 1	-	-

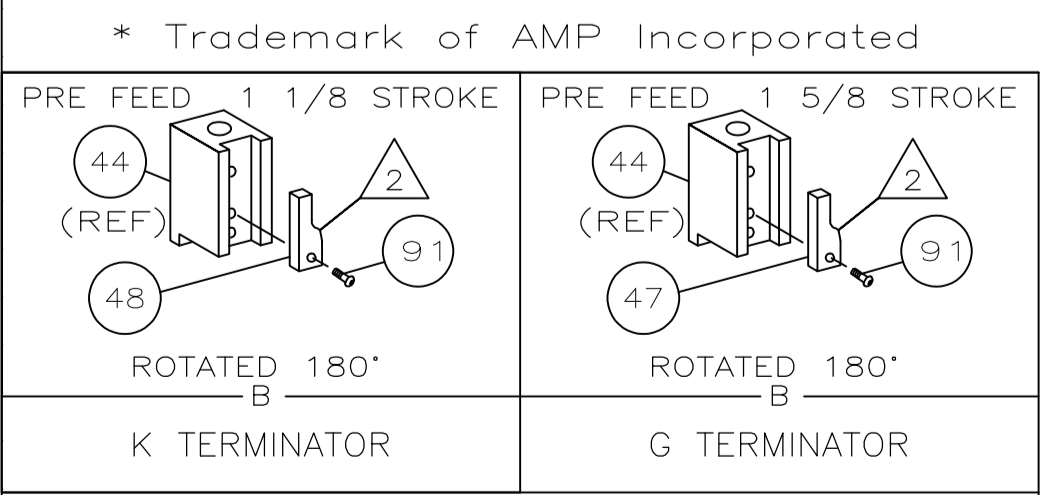
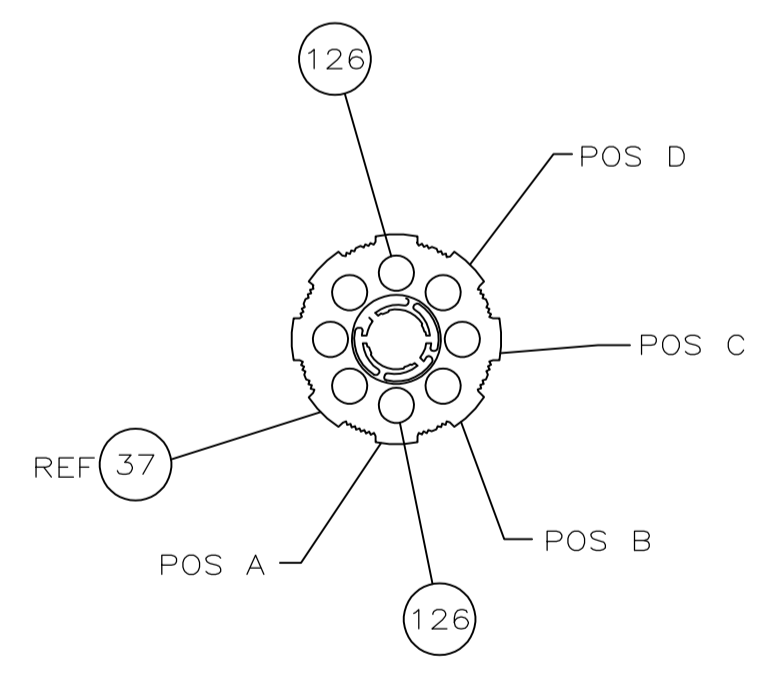
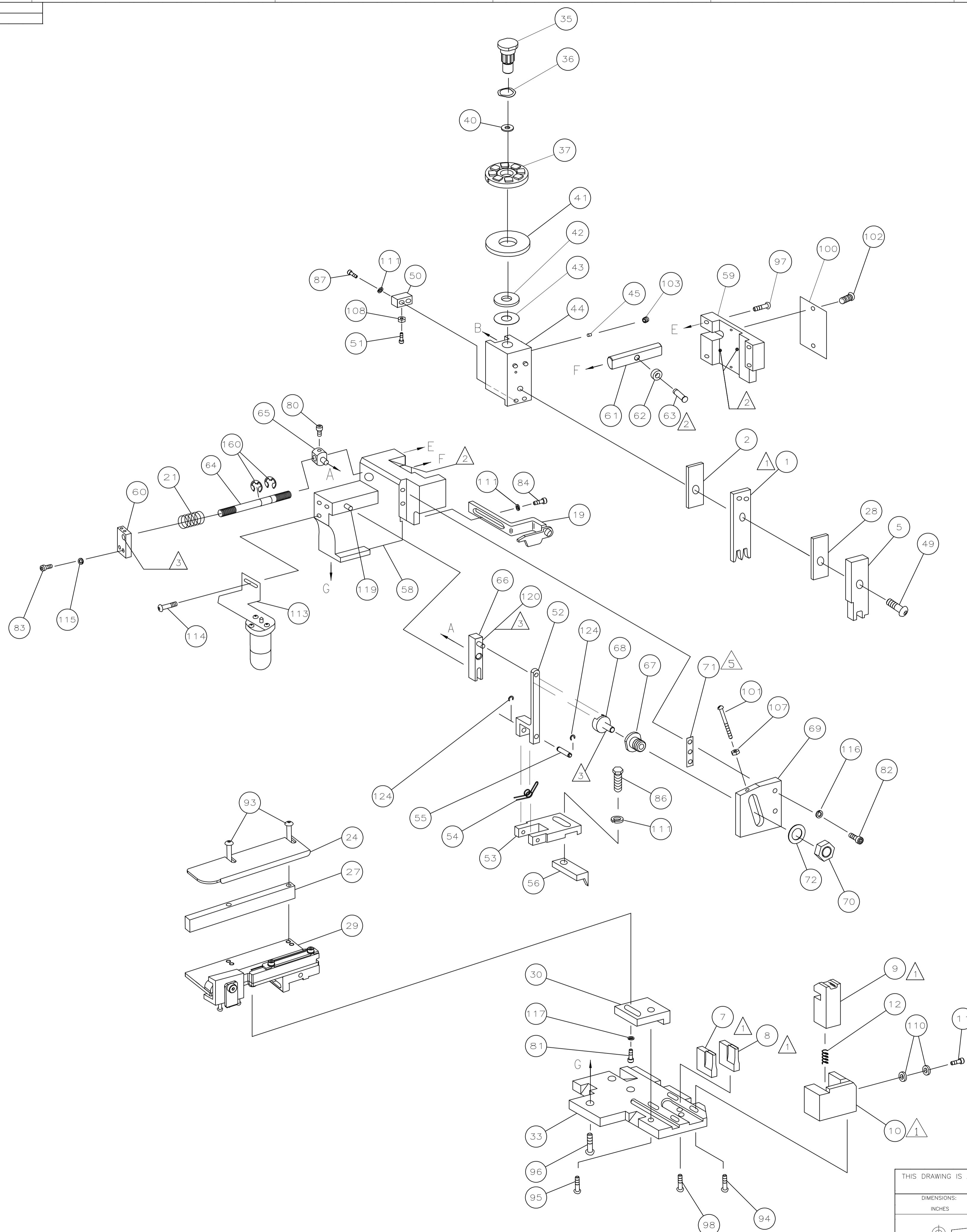
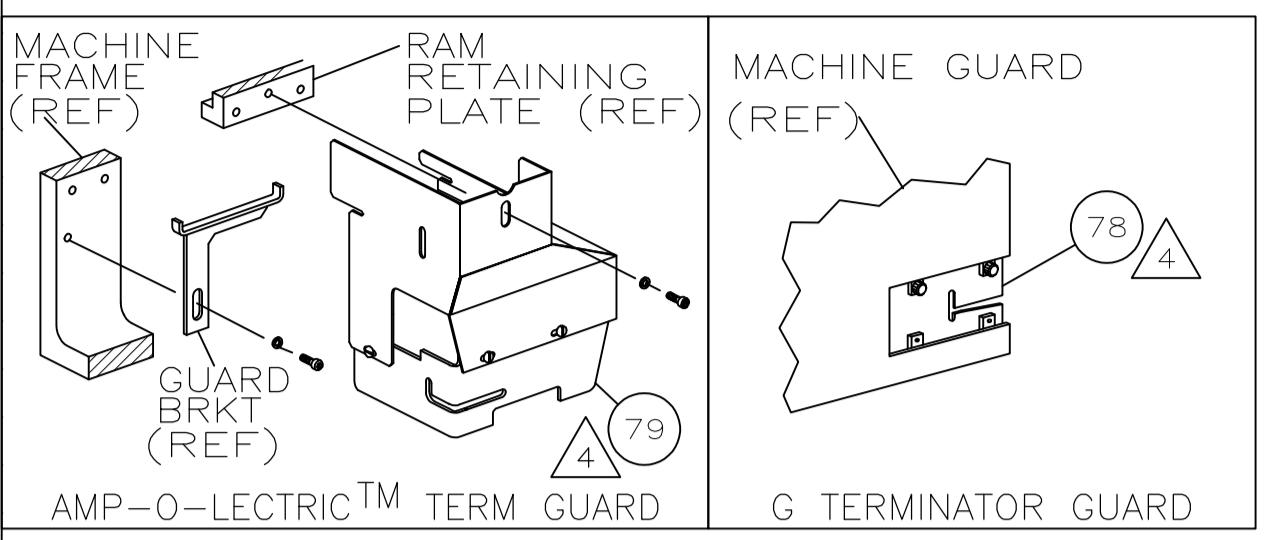

THIS DRAWING IS A CONTROLLED DOCUMENT.		DWG: M. YOUNGER	DATE: 04JAN2008	TE Connectivity	
DIMENSIONS: INCHES		TOLERANCES UNLESS OTHERWISE SPECIFIED:		NAME: SIDE FEED HDM APPLICATOR	
		0. PLC	± .005	PRODUCT SPEC: -	
		1. PLC	± .005	APPLICATION SPEC: -	
		2. PLC	± .005	SIZE: A1	
		3. PLC	± .005	CAGE CODE: 00779	
		4. PLC	± .005	DRAWING NO: 1852621	
MATERIAL: -		FINISH: -		RESTRICTED TO: -	
CUSTOMER DRAWING		SCALE: -		SHEET 2 OF 2	