

# ENTRELEC TERMINAL BLOCKS

## COMPACT POWER BLOCKS - CBS95-2P

### Screw Clamp Technology

95 mm<sup>2</sup> (3/0 AWG) , Single pole 1000 VAC/DC (IEC/UL), 232 A

#### INTRODUCTION

The compact terminal blocks cover a wide variety of applications from mechanical engineering, industrial equipment, automation to wind turbines, solar energy or switchgears. They offer cost, weight and space savings from enhanced aluminum body and compact design. The range offers connection capacity from 50 mm<sup>2</sup> to 300 mm<sup>2</sup> and TS35 rail or panel mount.

#### FEATURES

- Screw-clamp technology
- 95 mm<sup>2</sup> (3/0 AWG)
- 1000V AC/DC - IEC/UL rated
- Current rating 232 A (IEC/UL)
- Single pole
- 6 colors (grey, blue, green, black, brown, red)
- Aluminum tin plated body
- Panel and Din-rail mounting
- One extra measurement connection 10 mm<sup>2</sup> (8 AWG)

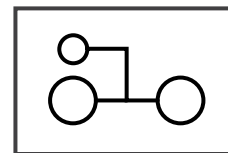

#### APPROVALS

- IEC 60947-7-1
- IEC 61238-1 (Class A)
- UL-1059
- UL 486E
- CSA C22.2 No.158-10





#### CONFORMITY



# ENTRELEC TERMINAL BLOCKS COMPACT POWER BLOCKS - CBS95-2P

Screw clamp technology

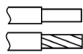
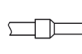
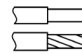
## MAIN TECHNICAL DATA

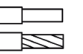
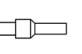
	IEC 60947-7-1, IEC 61238-1			UL 1059, CSA-C22.2 No. 158				
Nominal Voltage	1,000 VAC/ 1,000 V DC			1,000 VAC				
Nominal current	Cu 232 A, Al 200 A			Cu 200 A, Al 155 A				
Rated cross-section	95 mm <sup>2</sup>			AWG 3/0				
Impulse withstand voltage	8 kV			-				
Pollution degree	3			-				
Surge voltage category	III			-				
CTI value	550							
Terminal cross section	no. of connections: 2 x 95 mm <sup>2</sup> (all conductor types)			no. of connections: 2 x AWG 3/0 (all conductor types)				
		IEC60947-7-1		IEC 61238-1		UL 1059, CSA-C22.2 No. 158		
	Material	Cu		Al	Material	Cu		
								
	95 mm <sup>2</sup>	19 Nm	-	22.6 Nm	AWG 3/0	22.6 Nm	-	22.6 Nm
	70 mm <sup>2</sup>		19 Nm		AWG 2/0			
	50 mm <sup>2</sup>	14 Nm			AWG 1/0			
	35 mm <sup>2</sup>				AWG 2			
	25 mm <sup>2</sup>	14 Nm	AWG 4					
	16 mm <sup>2</sup>		AWG 6					
	10 mm <sup>2</sup>	-	-	AWG 8	-	-		
	Stripping length	26 mm			Stripping length	26 mm		
	Allen screw	M14 (SW6mm)			Allen screw	M14 (SW6mm)		
Measurement connection	no. of connections: 1 x 10 mm <sup>2</sup> (all conductor types)			no. of connections: 1 x 8 AWG (all conductor types)				
	10 mm <sup>2</sup>	1.2 Nm	1.2 Nm	8 AWG	2.3 Nm	-	2.3 Nm	
	6 mm <sup>2</sup>			10 AWG				
	4 mm <sup>2</sup>			12 AWG				
	2.5 mm <sup>2</sup>			14 AWG				
	1.5 mm <sup>2</sup>			16 AWG				
	Stripping length	10 mm			Stripping length	10 mm		
Screw	M4 (+/- PZ2)			Screw	M4 (+/- PZ2)			
Materials	Terminal body: Aluminium tin plated Housing: PA 6 (Halogen-free) Screws: Steel zinc plated							
Flame resistance	Self-extinguishing							
Mechanical data	Dimensions: Width x Height x Depth (mm): 28 x 57 x 93							
Protection degree	IP20							
Remarks	The product is compliant with the EC ROHSdirectives							

 Solid

 Compact stranded

 Fine stranded with ferrule

## DIMENSIONS: (Unit: mm)

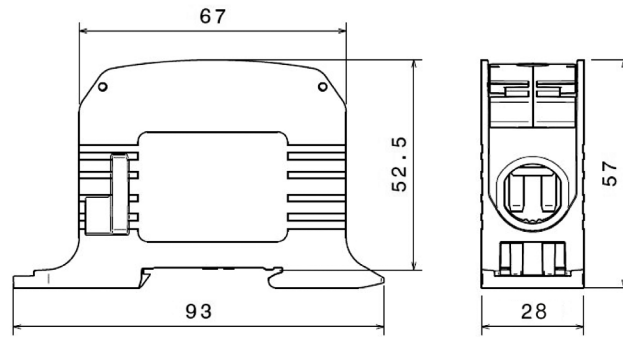

## ORDERING DETAILS

Description	Color	Type	Part Number	Pkg qty Std/box	Weight 1 Piece (g)	EAN/UPC codes
95 mm <sup>2</sup> Double pole	Grey - RAL7035	CBS95-2P	<a href="#">1SNF526011R0000</a>	2/36	112	3472599057746
	Grey/Blue - RAL7035/5012	CBS95-2P-BL	<a href="#">1SNF526021R0000</a>			3472599057753
	Grey/Green - RAL7035/6018	CBS95-2P-GR	<a href="#">1SNF526031R0000</a>			3472599057821
	Grey/Brown - RAL7035/8003	CBS95-2P-BR	<a href="#">1SNF526041R0000</a>			3472598016539
	Grey/Black - RAL7035/9005	CBS95-2P-BK	<a href="#">1SNF526051R0000</a>			3472598016546
	Grey/Red - RAL7035/3020	CBS95-2P-RD	<a href="#">1SNF526061R0000</a>			3472598016553
CBS95-IP20 Cover	Grey - RAL7035	CBS95- Cover	<a href="#">1SNF926710R0000</a>	20/360	5	3472599057975
Self-adhesive white label 17x9 mm 60 per card	White	TAA0917	<a href="#">1SNA235776R0000</a>	18 cards/ pack	16.7 (per card)	3472599021105

## Connect With Us

### Get Answers to Your Questions Now.

We make it easy to connect with our experts and are ready to provide the support you need, including:

- Product information
- Product comparisons for your project
- Discussions with TE engineers and product experts
- Project consultations
- TE design resources and tools

[te.com](https://www.te.com)

©2024 TE Connectivity Ltd. Family of Companies. All Rights Reserved.

TE Connectivity, TE connectivity (logo) and Every Connection Counts are trademarks owned or licensed by the TE Connectivity family of companies. All other logos, products and/or company names referred to herein might be trademarks of their respective owners.

While TE has made every reasonable effort to ensure the accuracy of the information in this document, TE does not guarantee that it is error-free, nor does TE make any other representation, warranty or guarantee that the information is accurate, correct, reliable or current. TE reserves the right to make any changes to the information contained herein without prior notice. TE Connectivity assumes only those obligations set forth in the terms and conditions for this product and shall in no event be liable for any incidental, indirect, or consequential damages arising out of the sale, resale, use, or misapplication of the product. TE expressly disclaims any implied warranties with respect to the information contained herein, including, but not limited to, implied warranties of merchantability or fitness for a particular purpose. Dimensions, specifications and/or information contained herein are for reference purposes only and are subject to change without notice. Consult TE for the latest dimensions, specifications and/or information. Users of TE Connectivity products must make their own assessment as to whether the respective product is suitable for the respective desired application.

08/24 ED