

PCB terminal block - KDS10-PE/SO



1704062

<https://www.phoenixcontact.com/pc/products/1704062>

Please be informed that the data shown in this PDF document is generated from our Online Catalog. Please find the complete data in the user documentation. Our General Terms of Use for Downloads are valid.



PCB terminal block, nominal current: 76 A, rated voltage (III/2): 320 V, nominal cross section: 10 mm², number of potentials: 1, number of rows: 1, number of positions per row: 1, product range: KDS10-PE, pitch: 10 mm, connection method: Screw connection with tension sleeve, mounting: Wave soldering, conductor/PCB connection direction: 0 °, Pin layout: Linear pinning, Solder pin [P]: 4.3 mm, number of solder pins per potential: 4, type of packaging: packed in cardboard. The article can be aligned to create different nos. of positions!

Your advantages

- Well-known connection principle allows worldwide use
- Low temperature rise, thanks to maximum contact force
- Allows connection of two conductors
- Potentials can be easily looped through with additional connection to the PCB
- The latching on the side enables various numbers of positions to be combined

Commercial Data

| | |
|--------------------------------------|---------------------|
| Item number | 1704062 |
| Packing unit | 50 pc |
| Minimum order quantity | 1 pc |
| Product Key | AANFCB |
| Catalog Page | Page 459 (C-1-2013) |
| GTIN | 4017918023195 |
| Weight per Piece (including packing) | 17.096 g |
| Weight per Piece (excluding packing) | 16.106 g |
| Customs tariff number | 85369010 |
| Country of origin | DE |

PCB terminal block - KDS10-PE/SO



1704062

<https://www.phoenixcontact.com/pc/products/1704062>

Technical Data

Product properties

| | |
|---------------------------|--|
| Type | PC terminal block can be aligned + PE terminal block + feed-through terminal block |
| Product line | COMBICON Terminals L |
| Product type | Printed circuit board terminal |
| Number of positions | 1 |
| Pitch | 10 mm |
| Number of connections | 2 |
| Number of rows | 1 |
| Number of potentials | 1 |
| Pin layout | Linear pinning |
| Solder pins per potential | 4 |

Electrical properties

| | |
|-----------------------------|-------|
| Nominal current I_N | 76 A |
| Nominal voltage U_N | 320 V |
| Degree of pollution | 3 |
| Rated voltage (III/3) | 250 V |
| Rated surge voltage (III/3) | 4 kV |
| Rated voltage (III/2) | 320 V |
| Rated surge voltage (III/2) | 4 kV |

Connection data

Connection technology

| | |
|-----------------------|--|
| Type | PC terminal block can be aligned + PE terminal block + feed-through terminal block |
| Nominal cross section | 10 mm ² |

Conductor connection

| | |
|---|---|
| Connection method | Screw connection with tension sleeve |
| Conductor cross section solid | 0.5 mm ² ... 16 mm ² |
| Conductor cross section flexible | 0.5 mm ² ... 10 mm ² |
| Conductor cross section AWG | 20 ... 6 |
| Conductor cross section flexible, with ferrule without plastic sleeve | 0.5 mm ² ... 10 mm ² |
| Conductor cross section, flexible, with ferrule, with plastic sleeve | 0.5 mm ² ... 10 mm ² |
| 2 conductors with same cross section, solid | 0.5 mm ² ... 4 mm ² |
| 2 conductors with same cross section, flexible | 0.5 mm ² ... 4 mm ² |
| 2 conductors with same cross section, flexible, with ferrule without plastic sleeve | 0.5 mm ² ... 2.5 mm ² |
| 2 conductors with the same cross section, flexible, with TWIN ferrule with plastic sleeve | 0.5 mm ² ... 6 mm ² |
| Stripping length | 12 mm |

PCB terminal block - KDS10-PE/SO

1704062

<https://www.phoenixcontact.com/pc/products/1704062>

| | |
|-------------------|-------------------|
| Tightening torque | 1.2 Nm ... 1.5 Nm |
|-------------------|-------------------|

Mounting

| | |
|---------------|----------------|
| Mounting type | Wave soldering |
| Pin layout | Linear pinning |

Material specifications

Material data - contact

| | |
|---|--|
| Note | WEEE/RoHS-compliant, free of whiskers according to IEC 60068-2-82/JEDEC JESD 201 |
| Contact material | Cu alloy |
| Surface characteristics | Tin-plated |
| Metal surface terminal point (top layer) | Tin (5 - 7 μm Sn) |
| Metal surface terminal point (middle layer) | Nickel (2 - 3 μm Ni) |
| Metal surface soldering area (top layer) | Tin (5 - 7 μm Sn) |
| Metal surface soldering area (middle layer) | Nickel (2 - 3 μm Ni) |

Material data - housing

| | |
|---|--------|
| Insulating material | PA |
| Insulating material group | I |
| CTI according to IEC 60112 | 600 |
| Flammability rating according to UL 94 | V0 |
| Glow wire flammability index GWFI according to EN 60695-2-12 | 850 |
| Glow wire ignition temperature GWIT according to EN 60695-2-13 | 775 |
| Temperature for the ball pressure test according to EN 60695-10-2 | 125 °C |

Dimensions

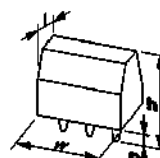
| | |
|-----------------------|--|
| Dimensional drawing |  |
| Pitch | 10 mm |
| Width [w] | 10 mm |
| Height [h] | 33.3 mm |
| Length [l] | 36.8 mm |
| Installed height | 29 mm |
| Solder pin length [P] | 4.3 mm |

Mechanical tests

Test for conductor damage and slackening

| | |
|---------------|-----------------------|
| Specification | IEC 60998-2-1:1990-04 |
|---------------|-----------------------|

PCB terminal block - KDS10-PE/SO



1704062

<https://www.phoenixcontact.com/pc/products/1704062>

| | |
|--------|-------------|
| Result | Test passed |
|--------|-------------|

Pull-out test

| | |
|---|---|
| Specification | IEC 60998-2-1:1990-04 |
| Conductor cross section/conductor type/tractive force setpoint/actual value | 0.5 mm ² / solid / > 30 N |
| | 0.5 mm ² / flexible / > 30 N |
| | 16 mm ² / solid / > 100 N |
| | 10 mm ² / flexible / > 90 N |

Torque test

| | |
|---------------|-----------------------|
| Specification | IEC 60998-2-1:1990-04 |
|---------------|-----------------------|

Electrical tests

Temperature-rise test

| | |
|-----------------------------------|--------------------------------|
| Specification | IEC 60998-2-1:1990-04 |
| Requirement temperature-rise test | Increase in temperature ≤ 45 K |

Insulation resistance

| | |
|--|-----------------------|
| Specification | IEC 60998-2-1:1990-04 |
| Insulation resistance, neighboring positions | 10 ⁹ Ω |

Air clearances and creepage distances |

| | |
|--|---------------------|
| Specification | IEC 60664-1:2007-04 |
| Insulating material group | I |
| Comparative tracking index (IEC 60112) | CTI 600 |
| Rated insulation voltage (III/3) | 250 V |
| Rated surge voltage (III/3) | 4 kV |
| minimum clearance value - non-homogenous field (III/3) | 3 mm |
| minimum creepage distance (III/3) | 3.2 mm |
| Rated insulation voltage (III/2) | 320 V |
| Rated surge voltage (III/2) | 4 kV |
| minimum clearance value - non-homogenous field (III/2) | 3 mm |
| minimum creepage distance (III/2) | 3 mm |
| Rated insulation voltage (II/2) | 630 V |
| Rated surge voltage (II/2) | 4 kV |
| minimum clearance value - non-homogenous field (II/2) | 3 mm |
| minimum creepage distance (II/2) | 3.2 mm |

Environmental and real-life conditions

Vibration test

| | |
|---------------|-----------------------------|
| Specification | IEC 60068-2-6:1995-03 |
| Frequency | 10 - 150 - 10 Hz |
| Sweep speed | 1 octave/min |
| Amplitude | 0.35 mm (10 Hz ... 60.1 Hz) |
| Sweep speed | 5g (60.1 Hz ... 150 Hz) |

PCB terminal block - KDS10-PE/SO



1704062

<https://www.phoenixcontact.com/pc/products/1704062>

| | |
|------------------------|-------|
| Test duration per axis | 2.5 h |
|------------------------|-------|

Glow-wire test

| | |
|------------------|-----------------------|
| Specification | IEC 60998-2-1:1990-04 |
| Temperature | 850 °C |
| Time of exposure | 5 s |

Ambient conditions

| | |
|---|---|
| Ambient temperature (operation) | -40 °C ... 100 °C (Depending on the current carrying capacity/derating curve) |
| Ambient temperature (storage/transport) | -40 °C ... 70 °C |
| Relative humidity (storage/transport) | 30 % ... 70 % |
| Ambient temperature (assembly) | -5 °C ... 100 °C |

Packaging specifications

| | |
|-------------------|---------------------|
| Type of packaging | packed in cardboard |
|-------------------|---------------------|

PCB terminal block - KDS10-PE/SO



1704062

<https://www.phoenixcontact.com/pc/products/1704062>

Drawings

Diagram

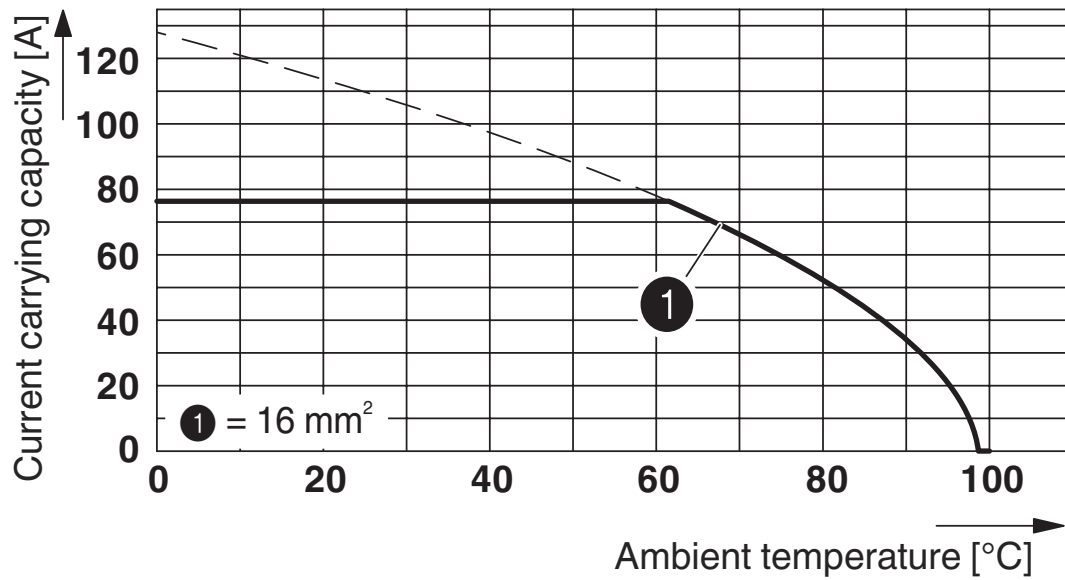

Type: KDS10-PE

Drilling plan/solder pad geometry

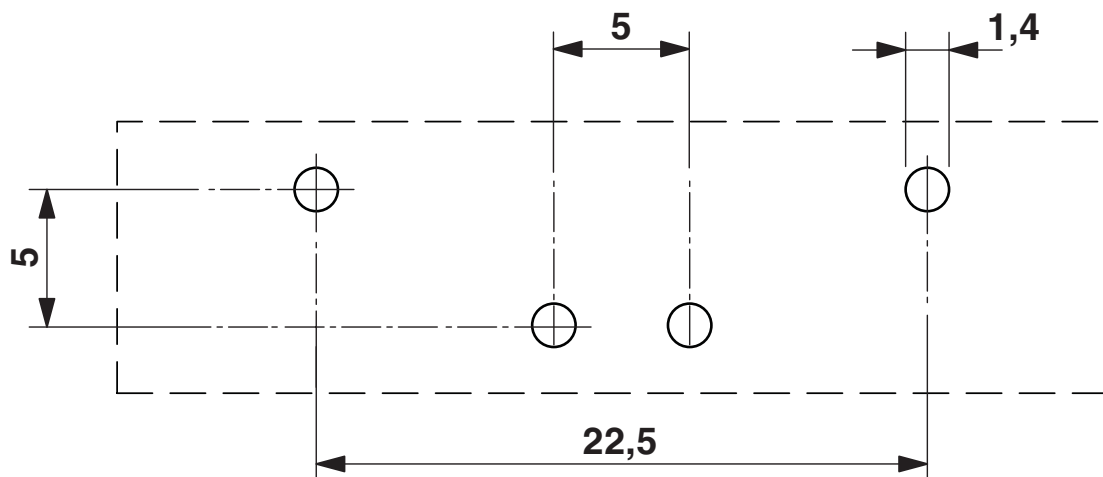

PCB terminal block - KDS10-PE/SO

1704062

<https://www.phoenixcontact.com/pc/products/1704062>



Dimensional drawing

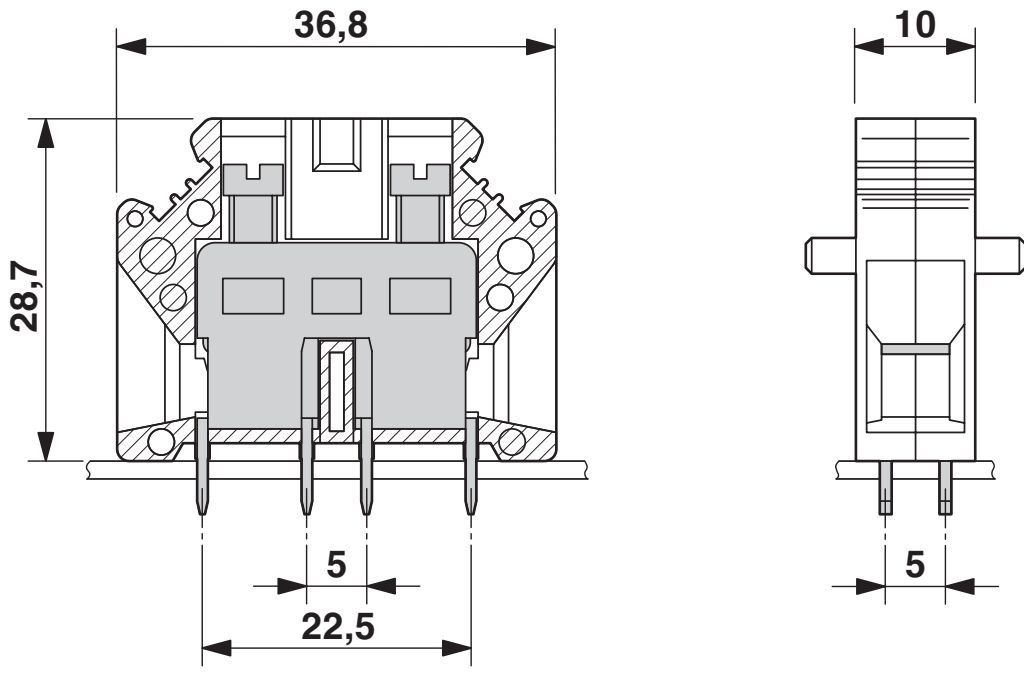

PCB terminal block - KDS10-PE/SO





1704062

<https://www.phoenixcontact.com/pc/products/1704062>

Approvals

|  CSA Approval ID: 13631 | | | | |
|--|-----------------------|-----------------------|-------------------|----------------------|
| | Nominal Voltage U_N | Nominal Current I_N | Cross Section AWG | Cross Section mm^2 |
| Use group B | | | 18 - 6 | - |
| Use group C | | | 18 - 6 | - |

|  cUL Recognized Approval ID: FILE E 60425 | | | | |
|--|-----------------------|-----------------------|-------------------|----------------------|
| | Nominal Voltage U_N | Nominal Current I_N | Cross Section AWG | Cross Section mm^2 |
| Use group B | | | 24 - 6 | - |
| Use group C | | | 24 - 6 | - |

|  UL Recognized Approval ID: FILE E 60425 | | | | |
|---|-----------------------|-----------------------|-------------------|----------------------|
| | Nominal Voltage U_N | Nominal Current I_N | Cross Section AWG | Cross Section mm^2 |
| Use group B | | | 24 - 6 | - |
| Use group C | | | 24 - 6 | - |

|  EAC Approval ID: B.01687 | | | | |
|--|--|--|--|--|
|--|--|--|--|--|

|  DNV GL Approval ID: TAE00001EV | | | | |
|--|--|--|--|--|
|--|--|--|--|--|

| cULus Recognized | | | | |
|-------------------------|--|--|--|--|
|-------------------------|--|--|--|--|

PCB terminal block - KDS10-PE/SO



1704062

<https://www.phoenixcontact.com/pc/products/1704062>

Classifications

ECLASS

| | |
|---------------|----------|
| ECLASS-9.0 | 27440401 |
| ECLASS-10.0.1 | 27440401 |
| ECLASS-11.0 | 27460101 |

ETIM

| | |
|----------|----------|
| ETIM 8.0 | EC002643 |
|----------|----------|

UNSPSC

| | |
|-------------|----------|
| UNSPSC 21.0 | 39121400 |
|-------------|----------|

PCB terminal block - KDS10-PE/SO



1704062

<https://www.phoenixcontact.com/pc/products/1704062>

Environmental Product Compliance

| | |
|------------|---|
| China RoHS | Environmentally friendly use period: unlimited = EFUP-e |
| | No hazardous substances above threshold values |

PCB terminal block - KDS10-PE/SO



1704062

<https://www.phoenixcontact.com/pc/products/1704062>

Accessories

Pitch spacer

Pitch spacer - RZ-KDS10 - 1701065

<https://www.phoenixcontact.com/pc/products/1701065>



Pitch spacer, raises the pitch by 2.5 mm, interlocks with terminal block of the same shape, color: green

Fixed bridge

Fixed bridge - FBI 10-10 - 0203276

<https://www.phoenixcontact.com/pc/products/0203276>



Fixed bridge, pitch: 10 mm, color: silver

PCB terminal block - KDS10-PE/SO

1704062

<https://www.phoenixcontact.com/pc/products/1704062>



Female test connector

Female test connector - PSB 4/7/6 - 0303299

<https://www.phoenixcontact.com/pc/products/0303299>



Female test connector, color: silver

Screwdriver

Screwdriver - SZS 1,0X4,0 VDE - 1205066

<https://www.phoenixcontact.com/pc/products/1205066>



Screwdriver, slot-headed, VDE insulated, size: 1.0 x 4.0 x 100 mm, 2-component grip, with non-slip grip

PCB terminal block - KDS10-PE/SO



1704062

<https://www.phoenixcontact.com/pc/products/1704062>

Zack marker strip

Zack marker strip - ZB10,LGS:FORTL.ZAHLEN - 1053014

<https://www.phoenixcontact.com/pc/products/1053014>



Zack marker strip, Strip, white, labeled, can be labeled with: CMS-P1-PLOTTER, printed horizontally: consecutive numbers 1 ... 10, 11 ... 20, etc. up to 91 ... 100, mounting type: snapped, for terminal block width: 10.2 mm, lettering field size: 10.15 x 10.5 mm, Number of individual labels: 10

Phoenix Contact 2022 © - all rights reserved

<https://www.phoenixcontact.com>

PHOENIX CONTACT GmbH & Co. KG

Flachsmarktstraße 8

D-32825 Blomberg

+49 (0) 5235-3 00

info@phoenixcontact.com