

Charging connector holder - EV-T2CCS-PARK



1624153

<https://www.phoenixcontact.com/pc/products/1624153>

Please be informed that the data shown in this PDF document is generated from our Online Catalog. Please find the complete data in the user documentation. Our General Terms of Use for Downloads are valid.



CHARX connect standard, Charging connector holder, Accessories, for vehicle charging connectors on charging stations (EVSE), CCS type 2, IEC 62196-3, Front mounting, D-Line 1.1, C-Line, housing: black, Item is not compatible with the HPC CCS type 2 charging cable from Phoenix Contact.

Product Description

Retainer for Vehicle Connector as parking position at charging stations for E-Mobility (EVSE)

Commercial Data

Item number	1624153
Packing unit	1 pc
Minimum order quantity	1 pc
Product Key	XWBAJD
Catalog Page	Page 43 (C-7-2019)
GTIN	4055626242873
Weight per Piece (including packing)	182.9 g
Weight per Piece (excluding packing)	140 g
Customs tariff number	39269097
Country of origin	DE

Charging connector holder - EV-T2CCS-PARK

1624153

<https://www.phoenixcontact.com/pc/products/1624153>

Technical Data

Notes

Note on application	Item is not compatible with the HPC CCS type 2 charging cable from Phoenix Contact.
---------------------	---

Product properties

Product type	Charging connector holder
Application	for vehicle charging connectors on charging stations (EVSE)
Type	Accessories
Technology	Combined Charging System
Charging standard	CCS type 2
Charging mode	Mode 4

Dimensions

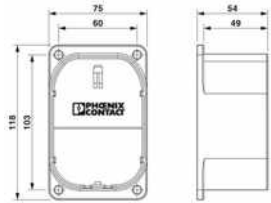
Dimensional drawing	
Width	75 mm
Height	118 mm
Depth	54 mm
Bore dimensions	60 mm x 103 mm

Material specifications

Color (Housing)	black (9005)
Color (Handle area)	gray (7042)
Color (Mating face)	black (9005)
Color (Protective cap)	black (9005)
Color (Cable)	black (9005)
Flammability rating according to UL 94	V0 ()

Mechanical properties

Securing	With locking clips for locking contour
Removal	Lifting and removal

Environmental and real-life conditions

Ambient conditions

Degree of protection (when plugged in)	IP54
Degree of protection	IP54
Ambient temperature (operation)	-30 °C ... 50 °C

Charging connector holder - EV-T2CCS-PARK



1624153

<https://www.phoenixcontact.com/pc/products/1624153>

Ambient temperature (storage/transport)	-40 °C ... 80 °C
---	------------------

Standards and regulations

Standards

Standards/regulations	IEC 62196-3
-----------------------	-------------

Mounting

Mounting type Charging connector holder	Front mounting (0° ... 45° frontal inclination possible)
Mounting hole diameter	6.00 mm (ø)

Charging connector holder - EV-T2CCS-PARK

1624153

<https://www.phoenixcontact.com/pc/products/1624153>

Drawings

Schematic diagram

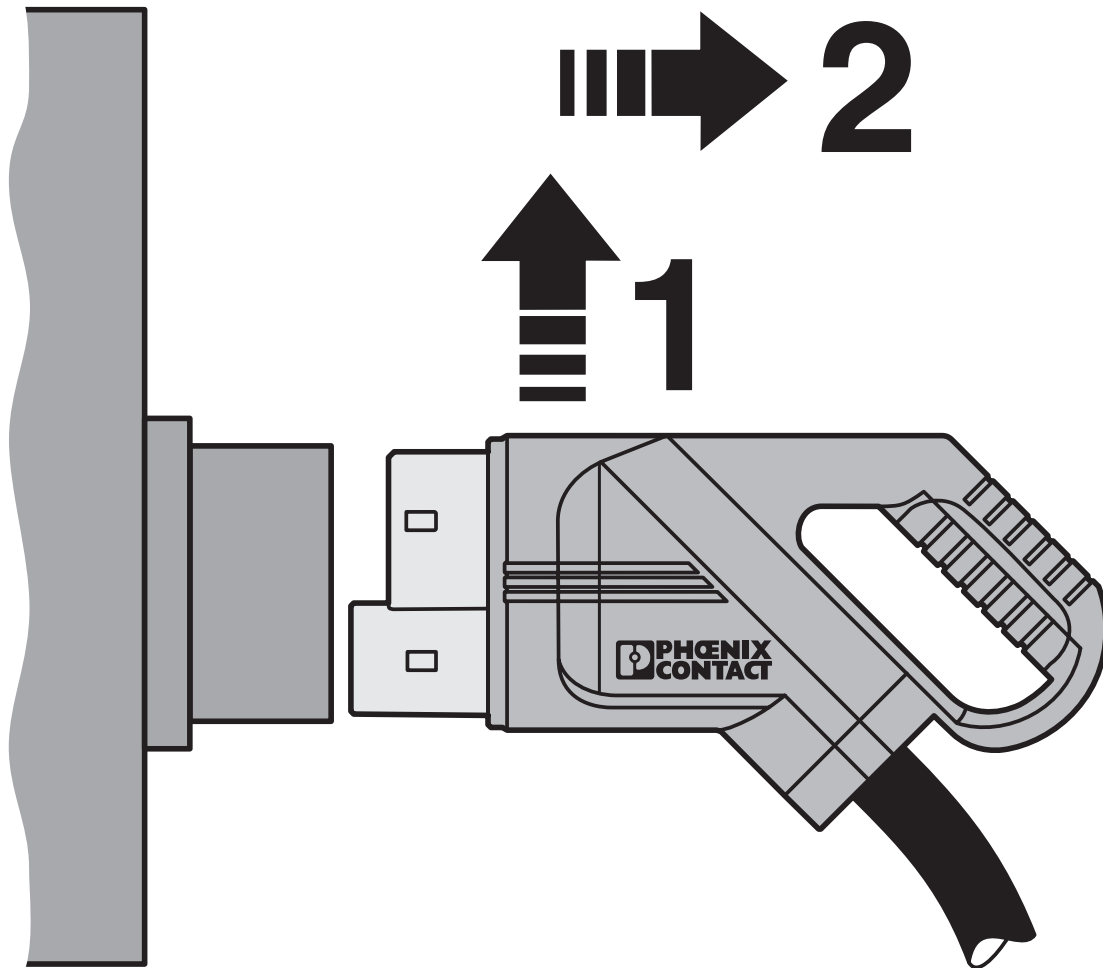

The attached DC Vehicle Connector is raised in the holder, releasing it from the integrated locking clip, and it can then be removed.

Charging connector holder - EV-T2CCS-PARK

1624153

<https://www.phoenixcontact.com/pc/products/1624153>



Dimensional drawing

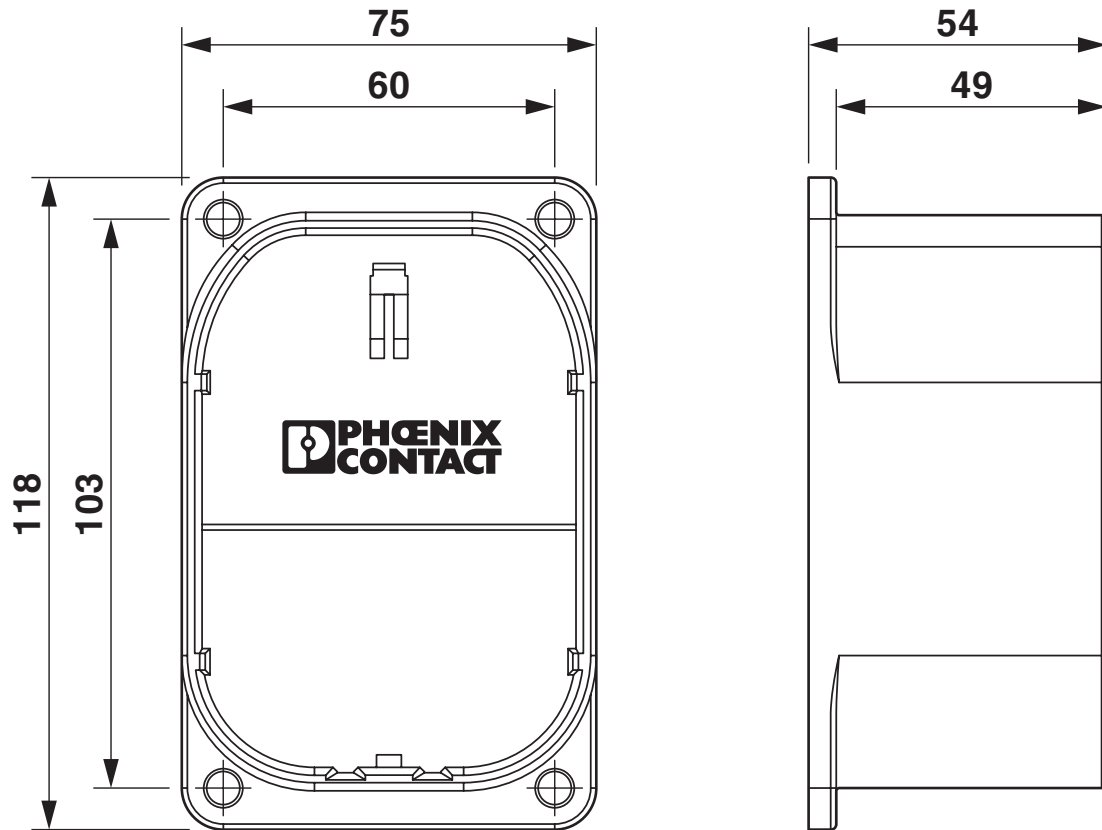

Dimensional drawing

Charging connector holder - EV-T2CCS-PARK



1624153

<https://www.phoenixcontact.com/pc/products/1624153>

Classifications

ECLASS

ECLASS-9.0	27144792
ECLASS-10.0.1	27144792
ECLASS-11.0	27144792

ETIM

ETIM 8.0	EC002884
----------	----------

UNSPSC

UNSPSC 21.0	39121500
-------------	----------

Charging connector holder - EV-T2CCS-PARK



1624153

<https://www.phoenixcontact.com/pc/products/1624153>

Environmental Product Compliance

China RoHS	Environmentally friendly use period: unlimited = EFUP-e No hazardous substances above threshold values
------------	---

Phoenix Contact 2023 © - all rights reserved
<https://www.phoenixcontact.com>

PHOENIX CONTACT GmbH & Co. KG
Flachmarktstraße 8
D-32825 Blomberg
+49 (0) 5235-3 00
info@phoenixcontact.com