



# Eurocard Connectors (Continued)

DIN 41612 and IEC 603-2

## High Current and Coaxial Contacts for Type M Receptacle Assemblies

### High Current Contacts

#### Material and Finish:

**Contacts** — Copper alloy, gold over nickel plated

**Retaining Ring** — Copper alloy

**Note:** These power contacts are used in the Type M Receptacle Assemblies shown on page 311.

### Female Power Contacts for Cable Termination

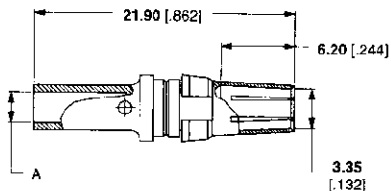

Part Number 148221-1

AWG	Contact Rated Current (Amperes)	Dim. A	Part Numbers	
			Solder	Crimp
8	40	4.80 .189	100081-1	148432-1
12-14	20	2.80 .110	100082-1	148221-1
16-18	10	1.70 .067	100083-1	148410-1

### Female Power Contacts (MFBL) for Cable Termination

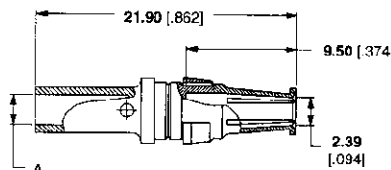

Part Number 148250-1

AWG	Contact Rated Current (Amperes)	Dim. A	Part Numbers	
			Solder	Crimp
8	40	4.80 .189	100084-1	148433-1
12-14	20	2.80 .110	100085-1	148250-1
16-18	10	1.70 .067	100086-1	148416-1

### Female Power Contact for PC Board Mount

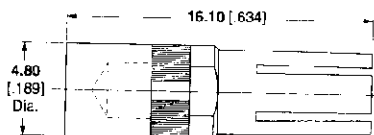

Part Number 148375-1  
(40 ampere rated current)



Part Number 148513-1  
RIA Power

### Coaxial Contacts

#### Material and Finish

**Outer Contact** — Copper alloy, gold plated

**Insulator** — PTFE

**Note:** These coaxial contacts are used in the Type M Receptacle Assemblies shown on page 311.

### Coaxial Contact for Female Connector, PC Board Mount (50 ohm)\*

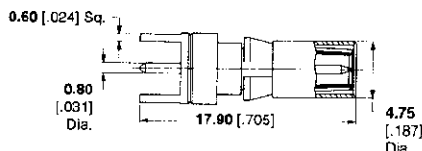

Part Number 148387-1

**Note:** Contact will raise the connector assembly up 3.18 [0.125] from the PC board surface.

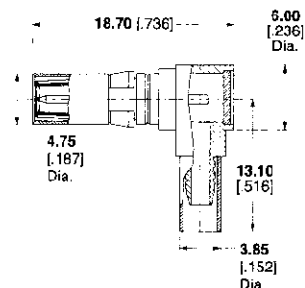

148342-1  
90° Right-Angle  
for RG316 Cable

### Coaxial Contacts for Female Connectors, Cable Termination (50 ohm)

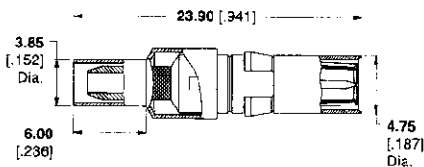

Cable Type	Part Numbers
RG316	148340-1
RD316	148340-2
RG142	148340-4
RG179	148253-1