

## Cable gland - G-INS-PG16-M68N-PNES-BK - 1424499

Please be informed that the data shown in this PDF Document is generated from our Online Catalog. Please find the complete data in the user's documentation. Our General Terms of Use for Downloads are valid (<http://phoenixcontact.com/download>)



Cable gland, Cable gland material: PA, External cable diameter 10 mm ... 14 mm, Shielding: No, Connecting thread: Pg16, Color: jet black RAL 9005



### Key Commercial Data

Packing unit	1
GTIN	 4 055626 373294
GTIN	4055626373294
Custom tariff number	39269097

### Technical data

#### Dimensions

Length	44 mm
Wrench size, union nut	27 mm
Wrench size, support	27 mm
Hexagon angular dimension	30.8 mm
Length of the connecting thread	10 mm
Feed-through hole diameter	22.6 mm ... 22.8 mm
External cable diameter	10 mm ... 14 mm
	10 mm ... 14 mm (for UL 514 B)

#### Ambient conditions

Degree of protection	IP68 (5 bar / 0.5 h)
Ambient temperature (operation)	-20 °C ... 100 °C (static)

#### General

# Cable gland - G-INS-PG16-M68N-PNES-BK - 1424499

## Technical data

### General

No. of conductors	1
Cable gland material	PA
Cable seal material	Neoprene
Shielded	No
Thread type on connection side	Pg16
Torque	3.5 Nm (Union nut)
	3.5 Nm (Support)
	9 Nm (for UL514 B: union nut / support)
Flammability rating according to UL 94	V2
	V2 (Housing)
Color	jet black RAL 9005
Assembly instructions	1) Mount screw connection support in the housing using the correct torque 2) Insert cable 3) Tighten union nut using the correct torque
Manufacturer	BIMED
Manufacturer Designation	BS-25

### Standards and Regulations

Flammability rating according to UL 94	V2
--	----

## Drawings

Dimensional drawing

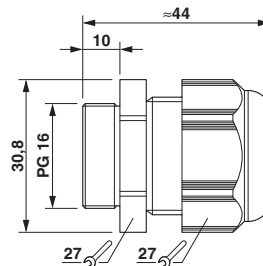

Dimensional drawing

## Classifications

eCl@ss

eCl@ss 5.1	27149109
eCl@ss 6.0	27149109
eCl@ss 7.0	27149109

# Cable gland - G-INS-PG16-M68N-PNES-BK - 1424499

## Classifications

### eCl@ss

eCl@ss 8.0	27149109
eCl@ss 9.0	27144432

### ETIM

ETIM 5.0	EC000441
----------	----------

## Approvals

### Approvals

---

Approvals

UL Listed / cUL Listed / EAC / cULus Listed

---

### Ex Approvals

### Approval details

UL Listed		<a href="http://database.ul.com/cgi-bin/XYV/template/LISEXT/1FRAME/index.htm">http://database.ul.com/cgi-bin/XYV/template/LISEXT/1FRAME/index.htm</a>	E199260
-----------	--	---	---------

cUL Listed		<a href="http://database.ul.com/cgi-bin/XYV/template/LISEXT/1FRAME/index.htm">http://database.ul.com/cgi-bin/XYV/template/LISEXT/1FRAME/index.htm</a>	E199260
------------	--	---	---------

EAC		EAC-Zulassung
-----	--	---------------

cULus Listed		
--------------	--	--

## Accessories

### Accessories

Flat nut

## Cable gland - G-INS-PG16-M68N-PNES-BK - 1424499

### Accessories

Nut - A-INL-PG16-P-GY - 1411225



Nut, PA, for threads Pg16, Color: silver-gray RAL 7001

---

### Sealing plugs

Closing cap - SEALING PLUG 12X22 RD - 1400260



Sealing plug, for sealing unused bore holes in multiple grommets and cable glands, diameter: 12 mm