

# Device connector, rear mounting - SACC-DSI-M12FSL-4FE-M16XL-L180

1415338

<https://www.phoenixcontact.com/pc/products/1415338>

Please be informed that the data shown in this PDF document is generated from our Online Catalog. Please find the complete data in the user documentation. Our General Terms of Use for Downloads are valid.

---



Device connector, rear mounting, Power, 5-position, Socket, straight, M12, L-coded, Rear mounting, M16 x 1.5, Solder pins

---

## Your advantages

- Easy PCB assembly: one-piece connectors for wave soldering
- For compact devices: transmit high power in a confined space
- Easy-to-install, optimized XL housing contour with wrench size 19
- Mechanical tightening limitation for long-term-stable gasket

# Device connector, rear mounting - SACC-DSI-M12FSL-4FE-M16XL-L180



1415338

<https://www.phoenixcontact.com/pc/products/1415338>

## Commercial Data

Item number	1415338
Packing unit	20 pc
Minimum order quantity	20 pc
Note	Made to Order (non-returnable)
Product Key	ABQEAD
GTIN	4055626055794
Weight per Piece (including packing)	18.135 g
Weight per Piece (excluding packing)	18 g
Customs tariff number	85366990
Country of origin	DE

# Device connector, rear mounting - SACC-DSI-M12FSL-4FE-M16XL-L180



1415338

<https://www.phoenixcontact.com/pc/products/1415338>

## Technical Data

### Notes

Notes on operation	The electrical and mechanical data specified assume that the connector pair is correctly locked and mounted. If the connector is unlocked and if there is a danger of contamination, the connector must be sealed using a protective cap > IP54. Influences arising from litz wires, cables or PCB assembly must also be taken into consideration.
Notes on operation	FE not connected to metal parts that can be touched, no protective function

### Product properties

Product type	Circular connectors (device side)
Number of positions	5
Coding	L - Power

### Insulation characteristics

Overvoltage category	III
Degree of pollution	3

### Ambient conditions

Degree of protection	IP67
Degree of protection	IP65/IP67
Ambient temperature (operation)	-25 °C ... 85 °C (Plug / socket) -40 °C ... 85 °C (without mechanical actuation)

### Connector

Insertion/withdrawal cycles	> 100
-----------------------------	-------

### Header 1

Head design	Socket
Head cable outlet	straight
Head thread type	M12
Coding	L-coded

### Electrical properties

Rated voltage in acc. with IEC 61076-2-101	630 V
Rated surge voltage	1.5 kV
Nominal voltage $U_N$	63 V DC
Nominal current $I_N$	16 A

### Material specifications

Material	PU 2K (Grout material)
Flammability rating according to UL 94	V0

# Device connector, rear mounting - SACC-DSI-M12FSL-4FE-M16XL-L180



1415338

<https://www.phoenixcontact.com/pc/products/1415338>

Sealing material	FKM
Contact material	CuZn
Contact surface material	Au
Contact carrier material	PA
Cable gland material	Zinc die-cast, nickel-plated

## Connection data

Conductor connection

Connection method	Solder pins
-------------------	-------------

## Mounting

Mounting type	Rear mounting, M16 x 1.5 thread with flat nut
Assembly instructions	With flat nut

## Standards and regulations

M12

Standards/specifications	IEC 61076-2-111
--------------------------	-----------------

## Cable / line

Cable structure

Signal type/category	Power
----------------------	-------

# Device connector, rear mounting - SACC-DSI-M12FSL-4FE-M16XL-L180

1415338

<https://www.phoenixcontact.com/pc/products/1415338>

## Drawings

Drilling plan/solder pad geometry

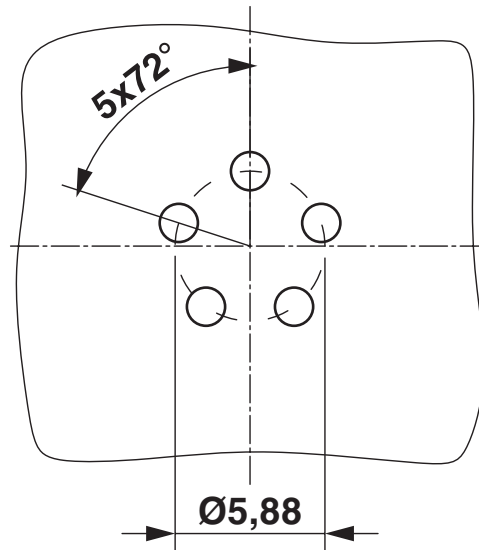

Schematic diagram

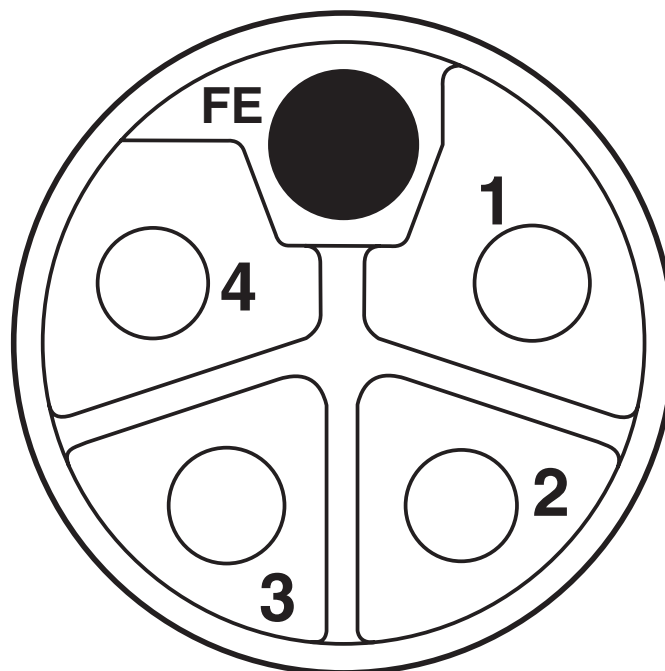

Pin assignment of M12 socket, 5-pos., L-coded, socket side view

# Device connector, rear mounting - SACC-DSI-M12FSL-4FE-M16XL-L180



1415338

<https://www.phoenixcontact.com/pc/products/1415338>

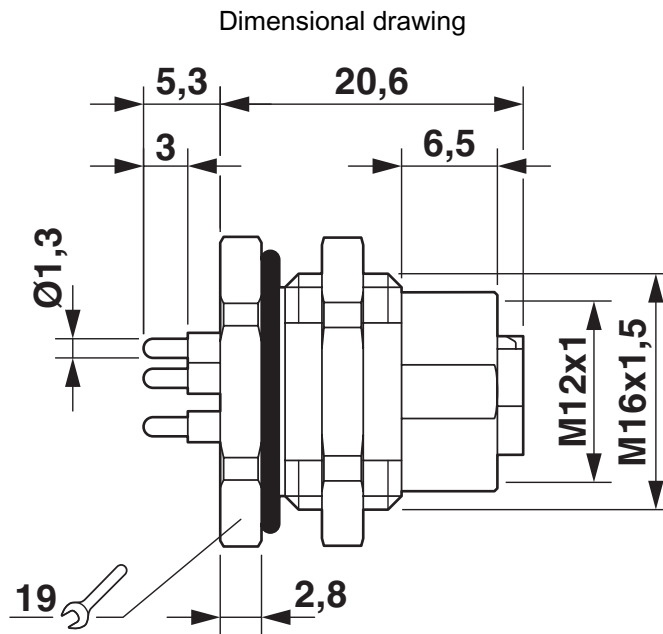

M12 flush-type socket

# Device connector, rear mounting - SACC-DSI-M12FSL-4FE-M16XL-L180



1415338

<https://www.phoenixcontact.com/pc/products/1415338>

## Approvals



**EAC**

Approval ID: B.01687



**cULus Recognized**

Approval ID: E468743-20180113

	Nominal Voltage $U_N$	Nominal Current $I_N$	Cross Section AWG	Cross Section $\text{mm}^2$
	63 V	16 A	-	-

# Device connector, rear mounting - SACC-DSI-M12FSL-4FE-M16XL-L180



1415338

<https://www.phoenixcontact.com/pc/products/1415338>

## Classifications

### ECLASS

ECLASS-9.0	27440102
ECLASS-10.0.1	27440102
ECLASS-11.0	27440102

### ETIM

ETIM 8.0	EC002635
----------	----------

### UNSPSC

UNSPSC 21.0	39121400
-------------	----------

# Device connector, rear mounting - SACC-DSI-M12FSL-4FE-M16XL-L180



1415338

<https://www.phoenixcontact.com/pc/products/1415338>

## Environmental Product Compliance

REACH SVHC	Lead 7439-92-1
China RoHS	Environmentally Friendly Use Period = 50 years
	For information on hazardous substances, refer to the manufacturer's declaration available under "Downloads"

# Device connector, rear mounting - SACC-DSI-M12FSL-4FE-M16XL-L180



1415338

<https://www.phoenixcontact.com/pc/products/1415338>

## Accessories

### Screw plug

Screw plug - PROT M12 MS PWR - 1092802

<https://www.phoenixcontact.com/pc/products/1092802>



An M12 screw plug for the unoccupied M12 females of the M12 POWER connectors, boxes, and flush-type connectors

---

Phoenix Contact 2022 © - all rights reserved  
<https://www.phoenixcontact.com>

PHOENIX CONTACT GmbH & Co. KG  
Flachmarktstraße 8  
D-32825 Blomberg  
+49 (0) 5235-3 00  
[info@phoenixcontact.com](mailto:info@phoenixcontact.com)