

DATE	SYM	REVISION RECORD	AUTH.	DR.	CK.
3/14/96	-	ISSUED		NT	
1/3/00		BASE UNDER PLATING IS NICKEL WAS COPPER		NT	DG

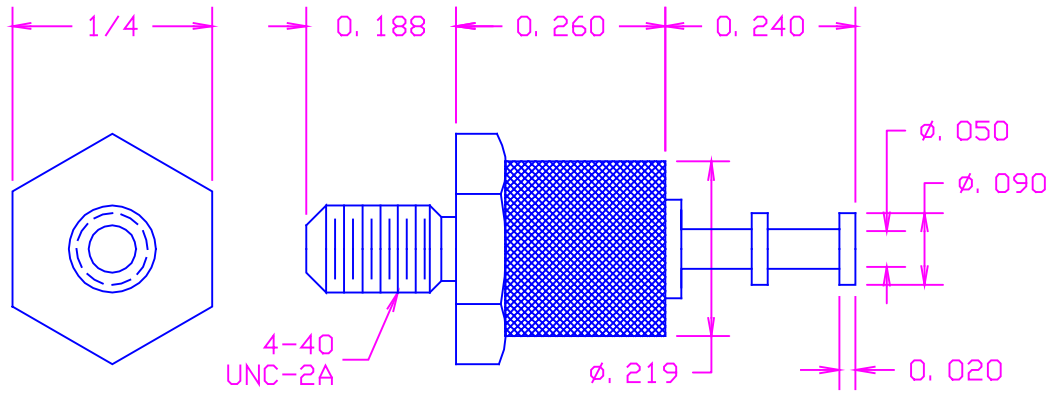

COLOR CODE (XX):

- 10- BLACK
- 11- BROWN
- 12- RED
- 13- ORANGE
- 14- YELLOW
- 15- GREEN
- 16- BLUE (STANDARD)
- 17- VIOLET
- 18- GRAY
- 19- WHITE

MATERIAL: PIN AND BASE- BRASS PER ASTM B16,
 ALLOY C 36000, 1/2 HARD
 INSULATION- MOLDED DIALLYL PHTHALATE
 SDGF, COLOR (XX)- SEE COLOR CODE

FINISH: PIN- .0003"MIN. ELECTRO-SOLDER PER
 MIL-P-81728 OVER .0001"MIN. COPPER
 BASE- .0001"MIN. ELECTRO-SOLDER PER
 MIL-P-81728, OVER NICKEL

SUPPLIED WITH NUT AND WASHER

ACTUAL SIZE

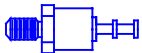

TOLERANCES (EXCEPT AS NOTED)	CONCORD ELECTRONICS CORPORATION		
DECIMAL ± .010	P/N	SCALE	30 GREAT JONES ST. NEW YORK N. Y. 10012
FRACTIONAL ± 1/64	TITLE TERMINAL		
ANGULAR ± 5°	DATE 3-14-96	DRAWING NUMBER 1169-36-05XX	