

<b>DRAWING NUMBER:</b>	<b>1127-05M-XXXX</b>
<b>PRODUCT GROUP:</b>	TERMINALS
<b>SUB-GROUP:</b>	MILITARY INSULATED TERMINALS
<b>DESCRIPTION:</b>	DIALLYL PHTHALATE INSULATED DOUBLE TURRET TERMINAL

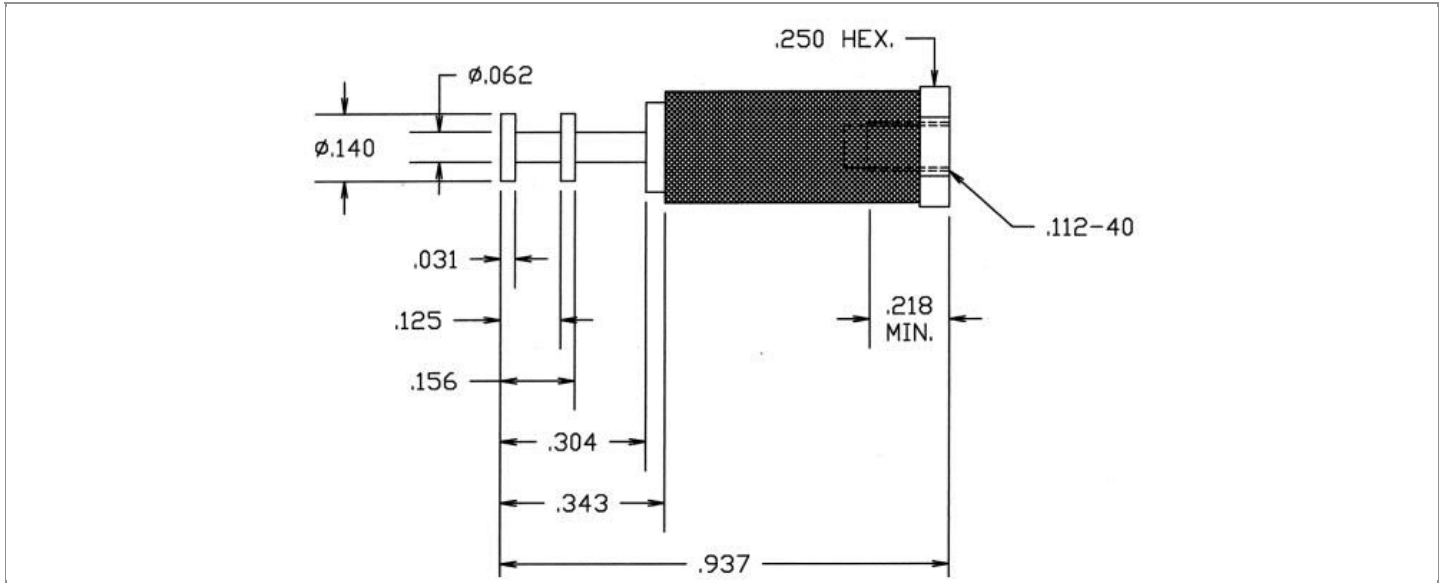

PIN DIAMETER	OVERALL LENGTH	MOUNTING ORIENTATION	BOARD / PANEL MOUNTING METHOD
N/A	0.937"	VERTICAL	THREAD MOUNT (4-40 SCREW)

BOARD / PANEL THICKNESS	MOUNTING HOLE SIZE	DRILL SIZE	FEED THRU COMBINATION
N/A	CLEARANCE FOR SCREW #4	#31	N/A

**PART NO. STRUCTURE:\***

<b>1127</b>	-	<b>05M</b>	-	<b>XX</b>	<b>XX</b>
PART SERIES		DIMENSION		FINISH	INSULATION COLOR

\*If applicable, "Z" at the end of a PART NO. STRUCTURE indicates TERMINAL MATERIAL TYPE.

**MATERIAL OPTIONS:**

**1127-05M-XXXX**

COMPONENT	MATERIAL	MATERIAL AND SPECIFICATION
TERMINAL	BRASS	BRASS PER ASTM B16, ALLOY C36000, 1/2 HARD
BASE/METAL SLEEVE	BRASS	BRASS PER ASTM B16, ALLOY C36000, 1/2 HARD
INSULATION*	DIALLYL PHTHALATE	MOLDED DIALLYL PHTHALATE, TYPE SDG-F PER ASTM D5948
NUT	N/A	N/A
WASHER	N/A	N/A

\*For Insulation color, please see INSULATION COLOR OPTIONS on Page 2

FINISH - PLATING OPTIONS:

1127-05M-XXXX

FINISH CODE	COMPONENT	FINISH	FINISH AND SPECIFICATION
05	TERMINAL	ELECTRO-SOLDER	0.000300"MIN. ELECTRO-SOLDER PER SAE-AMS-P-81728 OVER 0.000100"MIN. COPPER PER SAE-AMS-2418
	BASE/METAL SLEEVE	ELECTRO-SOLDER	0.000100"MIN. ELECTRO-SOLDER PER SAE-AMS-P-81728 OVER 0.000100"MIN. NICKEL PER SAE-AMS-QQ-N-290
	NUT	N/A	N/A
	WASHER	N/A	N/A
088	TERMINAL	BRIGHT TIN-LEAD	0.000300"MIN. BRIGHT TIN-LEAD (Sn93%-Pb7%) PER ASTM B545 OVER 0.000100"MIN. COPPER PER SAE-AMS-2418
	BASE/METAL SLEEVE	BRIGHT TIN-LEAD	0.000100"MIN. BRIGHT TIN-LEAD (Sn93%-Pb7%) PER ASTM B545 OVER 0.000100"MIN. NICKEL PER SAE-AMS-QQ-N-290
	NUT	N/A	N/A
	WASHER	N/A	N/A
095	TERMINAL	HOT SOLDER DIP	0.000100"MIN. HOT SOLDER DIP USING Sn60 PER IPC-J-STD-006 OVER 0.000100"MIN. COPPER PER SAE-AMS-2418
	BASE/METAL SLEEVE	BRIGHT TIN-LEAD	0.000100"MIN. BRIGHT TIN-LEAD (Sn93%-Pb7%) PER ASTM B545 OVER 0.000100"MIN. NICKEL PER SAE-AMS-QQ-N-290
	NUT	N/A	N/A
	WASHER	N/A	N/A

INSULATION COLOR OPTIONS:

1127-05M-XXXX

INSULATION COLOR	BLACK	BROWN	RED	ORANGE	YELLOW	GREEN	BLUE	VIOLET	GRAY	WHITE
COLOR CODE NO.	10	11	12	13	14	15	16	17	18	19

TOLERANCES:\*

DECIMAL	FRACTIONAL	ANGULAR	DRAWING ORIGATION DATE	LAST MODIFICATION DATE
± 0.015	N/A	N/A	12/19/2003	3/1/2017

\*All dimensions are in inches.

RoHS COMPLIANCE:

1127-05M-05XX

PART NUMBER	RoHS COMPLIANT
1127-05M-0510	NO
1127-05M-0511	NO
1127-05M-0512	NO
1127-05M-0513	NO
1127-05M-0514	NO
1127-05M-0515	NO
1127-05M-0516	NO
1127-05M-0517	NO
1127-05M-0518	NO
1127-05M-0519	NO

1127-05M-088XX

PART NUMBER	RoHS COMPLIANT
1127-05M-08810	NO
1127-05M-08811	NO
1127-05M-08812	NO
1127-05M-08813	NO
1127-05M-08814	NO
1127-05M-08815	NO
1127-05M-08816	NO
1127-05M-08817	NO
1127-05M-08818	NO
1127-05M-08819	NO

1127-05M-095XX

PART NUMBER	RoHS COMPLIANT
1127-05M-09510	NO
1127-05M-09511	NO
1127-05M-09512	NO
1127-05M-09513	NO
1127-05M-09514	NO
1127-05M-09515	NO
1127-05M-09516	NO
1127-05M-09517	NO
1127-05M-09518	NO
1127-05M-09519	NO

MILITARY REFERENCE SPECIFICATIONS:

1127-05M-05XX

PART NUMBER	MIL SPECIFICATION	MIL PART NUMBER	COMMERCIAL ITEM DESCRIPTION (CID) SPECIFICATION	CID PART NUMBER
1127-05M-0510	MIL-T-55155/20	M55155/200H02 (SE200D02S)	A-A-59126/20	AA59126/200H02
1127-05M-0511	MIL-T-55155/20	M55155/201H02 (SE201D02S)	A-A-59126/20	AA59126/201H02
1127-05M-0512	MIL-T-55155/20	M55155/202H02 (SE202D02S)	A-A-59126/20	AA59126/202H02
1127-05M-0513	MIL-T-55155/20	M55155/203H02 (SE203D02S)	A-A-59126/20	AA59126/203H02
1127-05M-0514	MIL-T-55155/20	M55155/204H02 (SE204D02S)	A-A-59126/20	AA59126/204H02
1127-05M-0515	MIL-T-55155/20	M55155/205H02 (SE205D02S)	A-A-59126/20	AA59126/205H02
1127-05M-0516	MIL-T-55155/20	M55155/206H02 (SE206D02S)	A-A-59126/20	AA59126/206H02
1127-05M-0517	MIL-T-55155/20	M55155/207H02 (SE207D02S)	A-A-59126/20	AA59126/207H02
1127-05M-0518	MIL-T-55155/20	M55155/208H02 (SE208D02S)	A-A-59126/20	AA59126/208H02
1127-05M-0519	MIL-T-55155/20	M55155/209H02 (SE209D02S)	A-A-59126/20	AA59126/209H02

1127-05M-088XX

PART NUMBER	MIL SPECIFICATION	MIL PART NUMBER	COMMERCIAL ITEM DESCRIPTION (CID) SPECIFICATION	CID PART NUMBER
1127-05M-08810	MIL-T-55155/20	M55155/200J02	A-A-59126/20	AA59126/200J02 (AA59126/20002)
1127-05M-08811	MIL-T-55155/20	M55155/201J02	A-A-59126/20	AA59126/201J02 (AA59126/20102)
1127-05M-08812	MIL-T-55155/20	M55155/202J02	A-A-59126/20	AA59126/202J02 (AA59126/20202)
1127-05M-08813	MIL-T-55155/20	M55155/203J02	A-A-59126/20	AA59126/203J02 (AA59126/20302)
1127-05M-08814	MIL-T-55155/20	M55155/204J02	A-A-59126/20	AA59126/204J02 (AA59126/20402)

Continued on next page...

MILITARY REFERENCE SPECIFICATIONS CONTINUED:

1127-05M-088XX

PART NUMBER	MIL SPECIFICATION	MIL PART NUMBER	COMMERCIAL ITEM DESCRIPTION (CID) SPECIFICATION	CID PART NUMBER
1127-05M-08815	MIL-T-55155/20	M55155/205J02	A-A-59126/20	AA59126/205J02 (AA59126/20502)
1127-05M-08816	MIL-T-55155/20	M55155/206J02	A-A-59126/20	AA59126/206J02 (AA59126/20602)
1127-05M-08817	MIL-T-55155/20	M55155/207J02	A-A-59126/20	AA59126/207J02 (AA59126/20702)
1127-05M-08818	MIL-T-55155/20	M55155/208J02	A-A-59126/20	AA59126/208J02 (AA59126/20802)
1127-05M-08819	MIL-T-55155/20	M55155/209J02	A-A-59126/20	AA59126/209J02 (AA59126/20902)

1127-05M-095XX

PART NUMBER	MIL SPECIFICATION	MIL PART NUMBER	COMMERCIAL ITEM DESCRIPTION (CID) SPECIFICATION	CID PART NUMBER
1127-05M-09510	MIL-T-55155/20	M55155/200I02	A-A-59126/20	AA59126/200I02
1127-05M-09511	MIL-T-55155/20	M55155/201I02	A-A-59126/20	AA59126/201I02
1127-05M-09512	MIL-T-55155/20	M55155/202I02	A-A-59126/20	AA59126/202I02
1127-05M-09513	MIL-T-55155/20	M55155/203I02	A-A-59126/20	AA59126/203I02
1127-05M-09514	MIL-T-55155/20	M55155/204I02	A-A-59126/20	AA59126/204I02
1127-05M-09515	MIL-T-55155/20	M55155/205I02	A-A-59126/20	AA59126/205I02
1127-05M-09516	MIL-T-55155/20	M55155/206I02	A-A-59126/20	AA59126/206I02
1127-05M-09517	MIL-T-55155/20	M55155/207I02	A-A-59126/20	AA59126/207I02
1127-05M-09518	MIL-T-55155/20	M55155/208I02	A-A-59126/20	AA59126/208I02
1127-05M-09519	MIL-T-55155/20	M55155/209I02	A-A-59126/20	AA59126/209I02

TOOLING:

INSTALLATION TOOL: ARBOR PRESS	INSTALLATION TOOL: ANVIL (ARBOR PRESS OPERATED)	INSTALLATION TOOL: PRESS-FIT / ROLL SWAGE / RIVET PUNCH (ARBOR PRESS OPERATED)	INSTALLATION TOOL: PRESS-FIT (HAND OPERATED)
N/A	N/A	N/A	N/A

NOTES:

<b>DATASHEET NOTES</b>
SCREW IS NOT INCLUDED.
<b>INSTRUCTION NOTES</b>
N/A