

DATE	SYM	REVISION RECORD	AUTH.	DR.	CK.
8/2/00	-	ISSUED		NT	DG
10/3/02	1	UPDATE TIN PLATING SPEC.		NT	DG

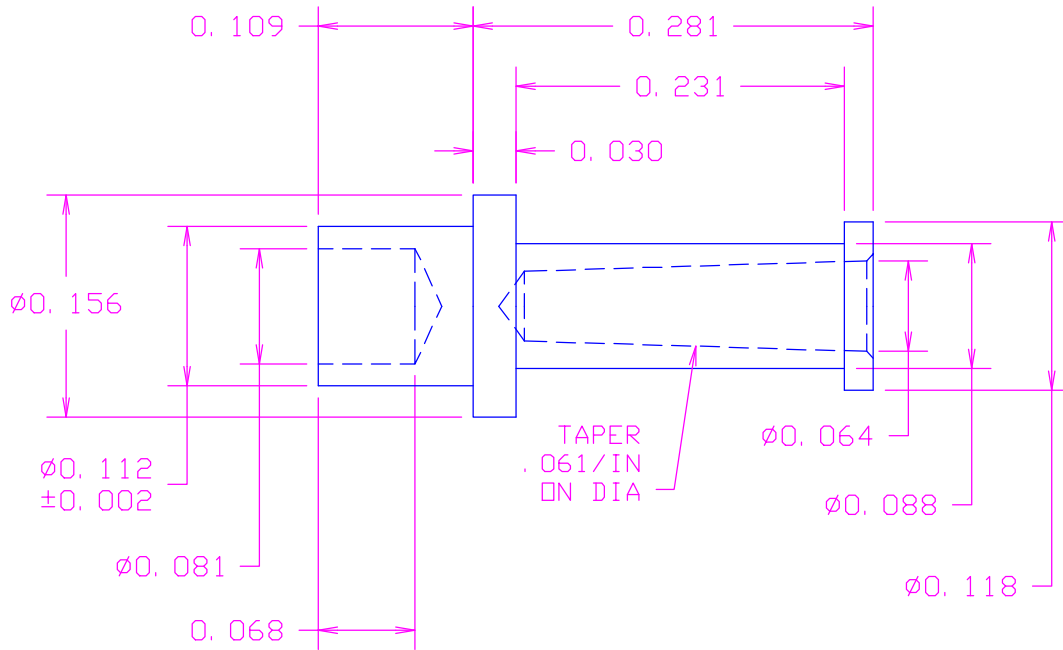

RECOMMENDED MOUNTING HOLE .116 DIA. (#32 DRILL)
MATERIAL: BRASS PER ASTM B16,
ALLOY C36000, 1/2 HARD
FINISH: .0003"MIN. ELECTRO-TIN PER ASTM B545,
OVER .0001"MIN. COPPER

ACTUAL SIZE



TOLERANCES (EXCEPT AS NOTED)	CONCORD		ELECTRONICS CORPORATION
DECIMAL $\pm .005$	P/N	SCALE	30 GREAT JONES ST. NEW YORK N. Y. 10012
FRACTIONAL $\pm 1/64$	TITLE TERMINAL		
ANGULAR $\pm 5^\circ$	DATE 7/31/00	DRAWING NUMBER 10-814-2-04	