

# TERMINALS

## 14-347-X-05

MATERIAL: RED LEADED BRASS  
FINISH: ELECTRO-SOLDER

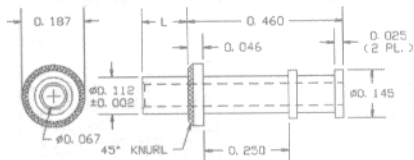

RECOMMENDED MOUNTING HOLE .116 DIA. (#32 DRILL)

| PART NO. | L    | T    | TOOLS        |          |
|----------|------|------|--------------|----------|
| 14-347-2 | .109 | 1/16 | ANVIL        | PUNCH    |
| 14-347-3 | .135 | 3/32 | TA188-146-31 | TP112-70 |
| 14-347-4 | .172 | 1/8  |              |          |
| 14-347-5 | .195 | 5/32 |              |          |

## 10-304-X-01

MATERIAL: BRASS  
FINISH: SILVER

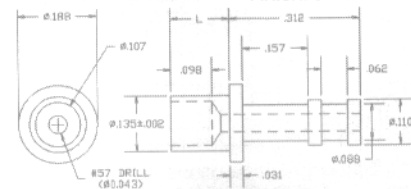

RECOMMENDED MOUNTING HOLE .1405 DIA. (#28 DRILL)

| PART NO. | L    | T    | TOOLS        |           |
|----------|------|------|--------------|-----------|
| 10-304-2 | .109 | 1/16 | ANVIL        | PUNCH     |
| 10-304-3 | .141 | 3/32 | TA188-110-31 | TP136-110 |
| 10-304-4 | .172 | 1/8  |              |           |
| 10-304-6 | .234 | 3/16 |              |           |

## 10-431-X-05

MATERIAL: BRASS  
FINISH: ELECTRO-SOLDER

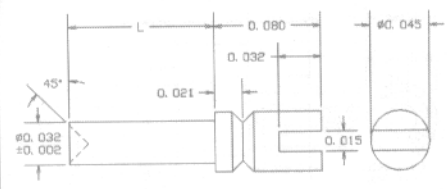

RECOMMENDED MOUNTING HOLE .036 DIA. (#64 DRILL)

| PART NO.  | L    | T    | TOOLS    |          |
|-----------|------|------|----------|----------|
| 10-431-11 | .030 | 1/64 | ANVIL    | PUNCH    |
| 10-431-1  | .045 | 1/32 | TA10-431 | TP10-431 |
| 10-431-2  | .077 | 1/16 |          |          |
| 10-431-3  | .108 | 3/32 |          |          |
| 10-431-4  | .139 | 1/8  |          |          |

## 10-336-X-04

MATERIAL: BRASS  
FINISH: ELECTRO-TIN

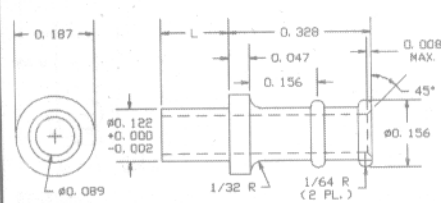

RECOMMENDED MOUNTING HOLE .125 DIA. (1/8 DRILL)

| PART NO. | L    | T    | TOOLS        |          |
|----------|------|------|--------------|----------|
| 10-336-1 | .109 | 1/16 | ANVIL        | PUNCH    |
| 10-336-2 | .125 | 3/32 | TA188-156-47 | TP125-90 |
| 10-336-3 | .156 | 1/8  |              |          |

## 12-325-X-01

MATERIAL: BRASS  
FINISH: SILVER

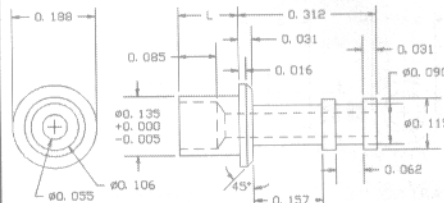

RECOMMENDED MOUNTING HOLE .196 DIA. (#9 DRILL)

| PART NO. | L    | T    | TOOLS        |           |
|----------|------|------|--------------|-----------|
| 12-325-1 | .075 | 1/32 | ANVIL        | PUNCH     |
| 12-325-2 | .105 | 1/16 | TA188-115-30 | TP135-102 |
| 12-325-3 | .135 | 3/32 |              |           |
| 12-325-4 | .165 | 1/8  |              |           |

## 12-444-X-01

MATERIAL: BRASS  
FINISH: SILVER

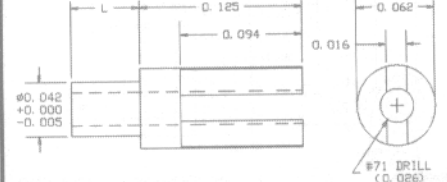

RECOMMENDED MOUNTING HOLE .052 DIA. (#55 DRILL)

| PART NO.  | L    | T    | TOOLS    |         |
|-----------|------|------|----------|---------|
| 12-444-11 | .037 | 1/64 | ANVIL    | PUNCH   |
| 12-444-1  | .053 | 1/32 | TA10-444 | TP40-25 |
| 12-444-2  | .084 | 1/16 |          |         |
| 12-444-3  | .115 | 3/32 |          |         |
| 12-444-4  | .147 | 1/8  |          |         |

## 10-329-X-04

MATERIAL: BRASS  
FINISH: ELECTRO-TIN

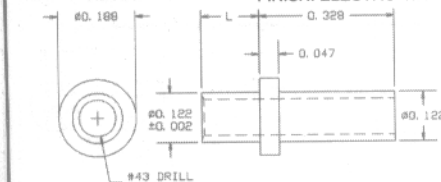

RECOMMENDED MOUNTING HOLE .125 DIA. (1/8 DRILL)

| PART NO. | L    | T    | TOOLS        |          |
|----------|------|------|--------------|----------|
| 10-329-2 | .109 | 1/16 | ANVIL        | PUNCH    |
| 10-329-3 | .141 | 3/32 | TA188-122-47 | TP125-90 |
| 10-329-4 | .172 | 1/8  |              |          |
| 10-329-5 | .203 | 5/32 |              |          |
| 10-329-6 | .234 | 3/16 |              |          |

## 14-351-X-05

MATERIAL: RED LEADED BRASS  
FINISH: ELECTRO-SOLDER

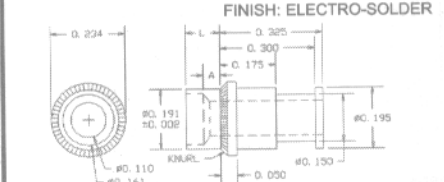

RECOMMENDED MOUNTING HOLE .196 DIA. (#9 DRILL)

| PART NO. | L    | A    | T    | TOOLS        |           |
|----------|------|------|------|--------------|-----------|
| 14-351-2 | .109 | .054 | 1/16 | ANVIL        | PUNCH     |
| 14-351-3 | .135 | .084 | 3/32 | TA234-195-30 | TP190-160 |
| 14-351-4 | .172 | .113 | 1/8  |              |           |
| 14-351-5 | .195 | .145 | 5/32 |              |           |
| 14-351-6 | .230 | .171 | 3/16 |              |           |

## 12-461-X-01

MATERIAL: BRASS  
FINISH: SILVER

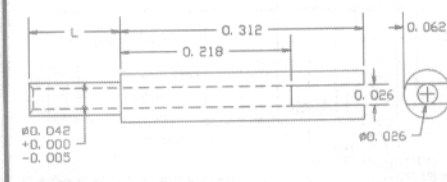

RECOMMENDED MOUNTING HOLE .052 DIA. (#55 DRILL)

| PART NO.  | L    | T    | TOOLS    |         |
|-----------|------|------|----------|---------|
| 12-461-11 | .037 | 1/64 | ANVIL    | PUNCH   |
| 12-461-1  | .053 | 1/32 | TA10-461 | TP40-25 |
| 12-461-2  | .084 | 1/16 |          |         |
| 12-461-3  | .115 | 3/32 |          |         |
| 12-461-4  | .147 | 1/8  |          |         |

## 10-337-X-04

MATERIAL: BRASS  
FINISH: ELECTRO-TIN

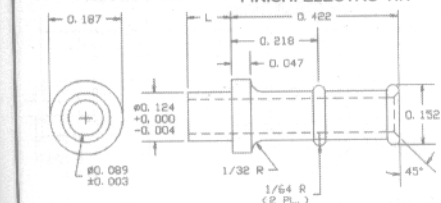

RECOMMENDED MOUNTING HOLE .125 DIA. (1/8 DRILL)

| PART NO. | L    | T    | TOOLS        |          |
|----------|------|------|--------------|----------|
| 10-337-2 | .109 | 1/16 | ANVIL        | PUNCH    |
| 10-337-3 | .141 | 3/32 | TA188-156-47 | TP125-90 |
| 10-337-4 | .172 | 1/8  |              |          |

## 14-350-X-05

MATERIAL: RED LEADED BRASS  
FINISH: ELECTRO-SOLDER

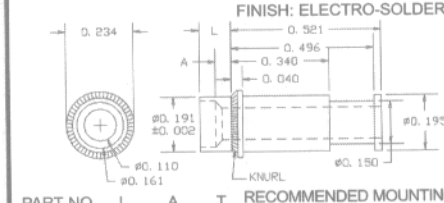

RECOMMENDED MOUNTING HOLE .196 DIA. (#9 DRILL)

| PART NO. | L    | A    | T    | TOOLS        |           |
|----------|------|------|------|--------------|-----------|
| 14-350-2 | .109 | .054 | 1/16 | ANVIL        | PUNCH     |
| 14-350-3 | .135 | .084 | 3/32 | TA234-195-30 | TP190-160 |
| 14-350-4 | .172 | .113 | 1/8  |              |           |
| 14-350-5 | .195 | .145 | 5/32 |              |           |
| 14-350-6 | .230 | .171 | 3/16 |              |           |

## 10-453-X-01

MATERIAL: BRASS  
FINISH: SILVER

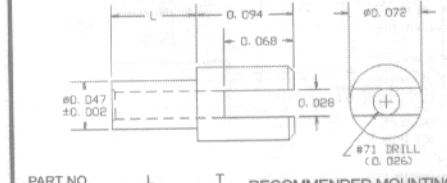

RECOMMENDED MOUNTING HOLE .052 DIA. (#55 DRILL)

| PART NO.  | L    | T    | TOOLS    |         |
|-----------|------|------|----------|---------|
| 10-453-11 | .035 | 1/64 | ANVIL    | PUNCH   |
| 10-453-1  | .051 | 1/32 | TA10-453 | TP47-26 |
| 10-453-2  | .082 | 1/16 |          |         |
| 10-453-3  | .113 | 3/32 |          |         |
| 10-453-4  | .145 | 1/8  |          |         |
| 10-453-6  | .207 | 3/16 |          |         |
| 10-453-8  | .270 | 1/4  |          |         |

## 10-332-4A-04

MATERIAL: BRASS  
FINISH: ELECTRO-TIN

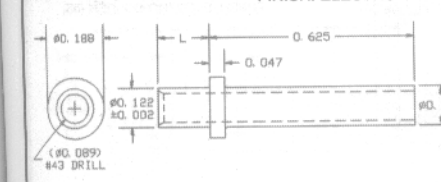

RECOMMENDED MOUNTING HOLE .125 DIA. (1/8 DRILL)

| PART NO.  | L    | T    | TOOLS        |          |
|-----------|------|------|--------------|----------|
| 10-332-4A | .156 | 7/64 | ANVIL        | PUNCH    |
|           |      |      | TA188-122-47 | TP125-90 |

## 12-464-X-01

MATERIAL: BRASS  
FINISH: SILVER

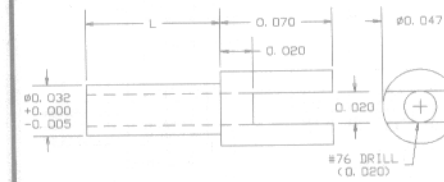

RECOMMENDED MOUNTING HOLE .196 DIA. (#9 DRILL)

| PART NO.  | L    | T    | TOOLS    |         |
|-----------|------|------|----------|---------|
| 12-464-11 | .037 | 1/64 | ANVIL    | PUNCH   |
| 12-464-1  | .053 | 1/32 | TA10-464 | TP30-20 |
| 12-464-2  | .084 | 1/16 |          |         |
| 12-464-3  | .115 | 3/32 |          |         |
| 12-464-4  | .147 | 1/8  |          |         |

## 10-413-X-01

MATERIAL: BRASS  
FINISH: SILVER

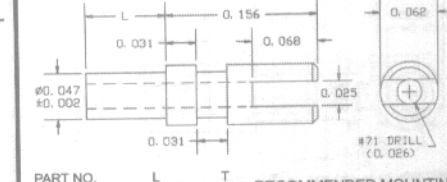

RECOMMENDED MOUNTING HOLE .052 DIA. (#55 DRILL)

| PART NO.  | L    | T    | TOOLS    |         |
|-----------|------|------|----------|---------|
| 10-413-11 | .035 | 1/64 | ANVIL    | PUNCH   |
| 10-413-1  | .051 | 1/32 | TA10-413 | TP47-26 |
| 10-413-2  | .082 | 1/16 |          |         |
| 10-413-3  | .113 | 3/32 |          |         |
| 10-413-4  | .145 | 1/8  |          |         |
| 10-413-6  | .207 | 3/16 |          |         |
| 10-413-8  | .270 | 1/4  |          |         |

FOR ADDITIONAL SIZES AND MATERIALS, CONTACT FACTORY

e-mail : [info@concord-elex.com](mailto:info@concord-elex.com)  
800-847-4162 (outside N.Y.S.)  
212-777-6571 • fax. 212-995-0161

