

TERMINALS

10-133-X-01

MATERIAL: BRASS
FINISH: SILVER

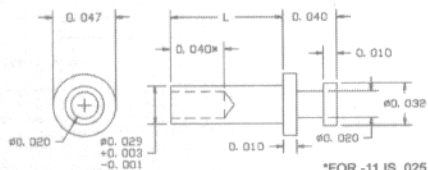

RECOMMENDED MOUNTING HOLE .033 DIA. (#66 DRILL)

PART NO.	L	T	TOOLS	
10-133-11	.037	1/64		
10-133-1	.053	1/32	ANVIL	PUNCH
10-133-2	.084	1/16	TA47-32-10	TP30-20
10-133-3	.115	3/32		

10-121-X-05

MATERIAL: BRASS
FINISH: ELECTRO-SOLDER

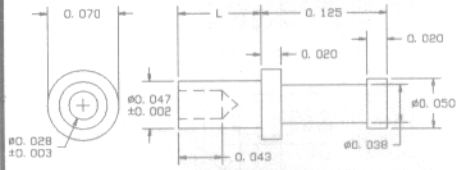

RECOMMENDED MOUNTING HOLE .052 DIA. (#55 DRILL)

PART NO.	L	T	TOOLS	
10-121-1	.051	1/32		
10-121-2	.082	1/16	ANVIL	PUNCH
			TA70-50-20	TP47-26

10-107-X-01

MATERIAL: BRASS
FINISH: SILVER

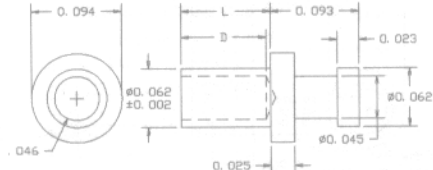

RECOMMENDED MOUNTING HOLE .067 DIA. (#51 DRILL)

PART NO.	L	T	D	TOOLS	
10-107-11	.025	1/64	.020		
10-107-1	.045	1/32	.040		
10-107-2	.094	1/16	.089	ANVIL	PUNCH
10-107-3	.125	3/32	.089	TA94-62-20	TP62-44
10-107-4	.156	1/8	.089		

10-115-X-044

MATERIAL: BRASS
FINISH: BRIGHT TIN

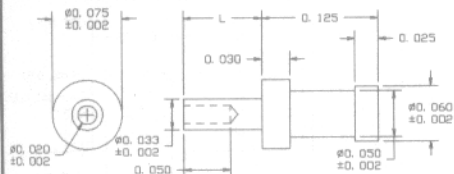

RECOMMENDED MOUNTING HOLE .037 DIA. (#63 DRILL)

PART NO.	L	T	TOOLS	
10-115-1	.051	1/32		
10-115-2	.084	1/16	ANVIL	PUNCH
10-115-2B	.096	1/16	TA75-60-30	TP30-20

10-120-X-01

MATERIAL: BRASS
FINISH: SILVER

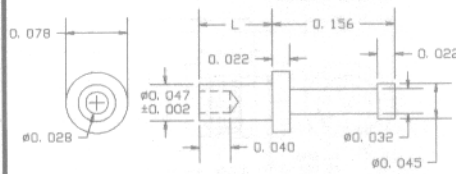

RECOMMENDED MOUNTING HOLE .052 DIA. (#55 DRILL)

PART NO.	L	T	TOOLS	
10-120-2	.094	1/16		
			ANVIL	PUNCH
			TA78-45-22	TP47-26

12-117-X-01

MATERIAL: BRASS
FINISH: SILVER

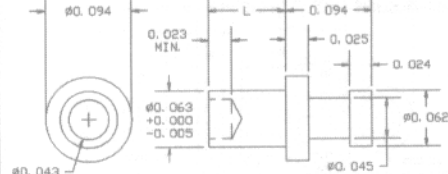

RECOMMENDED MOUNTING HOLE .067 DIA. (#51 DRILL)

PART NO.	L	T	D	TOOLS	
12-117-11	.037	1/64	.067 DIA. (#51 DRILL)		
12-117-1	.053	1/32		ANVIL	PUNCH
12-117-2	.084	1/16		TA94-62-20	TP62-44
12-117-3	.115	3/32			
12-117-4	.147	1/8			

10-136-X-05

MATERIAL: BRASS
FINISH: ELECTRO-SOLDER

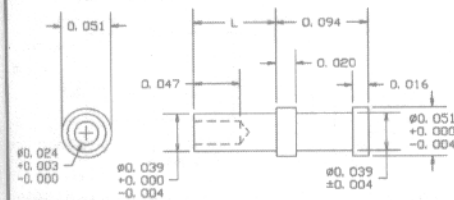

RECOMMENDED MOUNTING HOLE .041 DIA. (#60 DRILL)

PART NO.	L	T	TOOLS	
10-136-1	.055	1/32		
10-136-2	.084	1/16	ANVIL	PUNCH
			TA53-53-94	TP40-25

10-127-1-XX

MATERIAL: BRASS
FINISH: SILVER (01)
FINISH: ELECTRO-SOLDER (05)

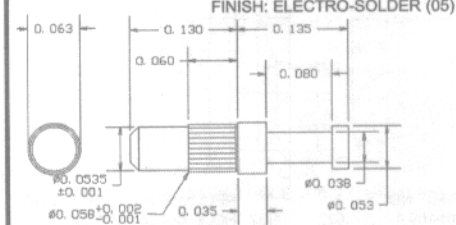

RECOMMENDED MOUNTING HOLE .055 DIA. (#54 DRILL)

PART NO.	L	T	TOOLS	
10-127-1	.130	.062 TO .094		

10-138-X-XX

MATERIAL: BRASS
FINISH: SILVER (01)
FINISH: ELECTRO-TIN (04)

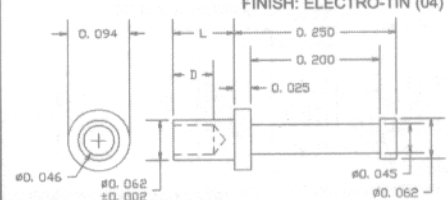

RECOMMENDED MOUNTING HOLE .067 DIA. (#51 DRILL)

PART NO.	L	T	D	TOOLS	
10-138-1	.045	1/32	.040		
10-138-2	.094	1/16	.062		
10-138-3	.125	3/32	.062	ANVIL	PUNCH
10-138-4	.156	1/8	.062	TA94-62-20	TP62-44

12-114-X-01

MATERIAL: BRASS
FINISH: SILVER

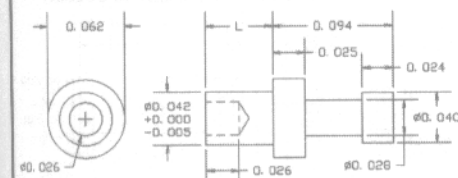

PART NO.	L	T	TOOLS	
12-114-11	.037	1/64		
12-114-1	.053	1/32		
12-114-2	.084	1/16	ANVIL	PUNCH
12-114-3	.115	3/32	TA62-40-25	TP40-25
12-114-4	.147	1/8		

10-129-2-04

MATERIAL: BRASS
FINISH: ELECTRO-TIN

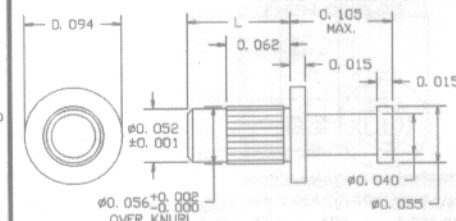

RECOMMENDED MOUNTING HOLE .055 DIA. (#54 DRILL)

PART NO.	L	T	TOOLS	
10-129-2	.100	.062		

10-101-X-XX

MATERIAL: BRASS
FINISH: SILVER (01)
FINISH: ELECTRO-SOLDER (05)

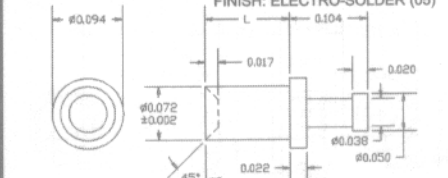

RECOMMENDED MOUNTING HOLE .076 DIA. (#48 DRILL)

PART NO.	L	T	TOOLS	
10-101-1	.051	1/32		
10-101-2	.082	1/16		
10-101-3	.113	3/32	ANVIL	PUNCH
10-101-4	.145	1/8	TA94-50-20	TP71-43
10-101-6	.207	3/16		
10-101-8	.270	1/4		

10-104-X-XX

MATERIAL: BRASS
FINISH: SILVER (01)
GOLD (03)

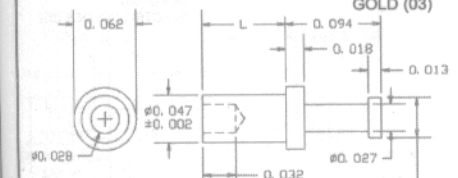

PART NO.	L	T	TOOLS	
10-104-11	.035	1/64		
10-104-1	.051	1/32		
10-104-2	.082	1/16	ANVIL	PUNCH
10-104-3	.113	3/32	TA62-40-18	TP47-26
10-104-4	.145	1/8		

13-108-X-01

MATERIAL: BRASS
FINISH: SILVER

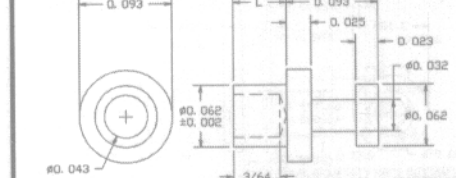

PART NO.	L	T	TOOLS	
13-108-11	.037	1/64		
13-108-1	.053	1/32		
13-108-2	.084	1/16	ANVIL	PUNCH
13-108-3	.115	3/32	TA94-62-20	TP62-44
13-108-4	.147	1/8		

12-105-X-01

MATERIAL: BRASS
FINISH: SILVER

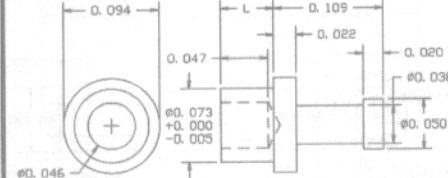

PART NO.	L	T	TOOLS	
12-105-11	.037	1/64		
12-105-1	.053	1/32		
12-105-2	.084	1/16	ANVIL	PUNCH
12-105-3	.115	3/32	TA94-50-20	TP71-43
12-105-4	.147	1/8		

FOR ADDITIONAL SIZES AND MATERIALS, CONTACT FACTORY

