

- 1. MATING CONNECTOR REFER TO DRAWING 2400957
- △ CODING VARIANT
- △ MOUNTING SPACE FOR HEADER
- △ SEALING AREA AND BURR, TOOL PARTING, SHRINKAGE, CAVITIES AND GATE MARKS PERMITTED. SURFACE ROUGHNESS: Ra=1.6
- △ DRAFT ANGLE UP TO 0.5° PERMITTED
- △ MOUNTING SCREW M5 (RECOMMENDED SCREW PLATING: ZINC-NICKEL) SCREW TYPE UP TO MANUFACTURER
- △ MATERIAL: CORROSION RESISTANT, ELECTROCONDUCTIVE
- △ SCREW M6 FOR BUSBAR CONNECTION
- △ ALL THREAD HOLES ARE BLIND HOLES
- △ INTERFACE PANEL CODE SEE SHEET 4
- △ POSITION NUMBER
- △ LUBRICANT APPLIED ON THE RADIAL SEAL AREA AND CPA AREA
- △ ASSEMBLY PN: X-XXXXXXX-X
- △ ASSEMBLY REV.: X
- △ DATE CODE: DWYY

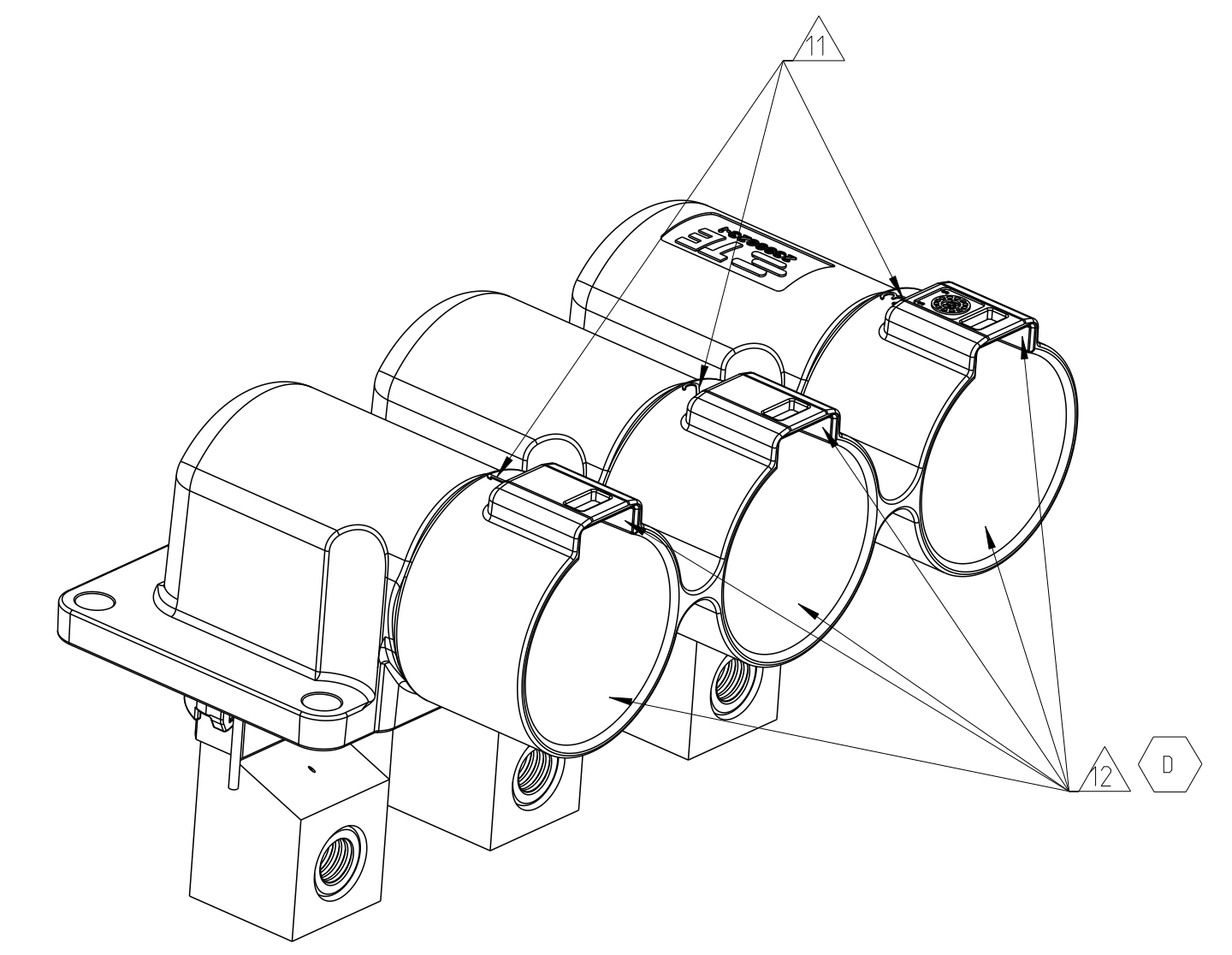
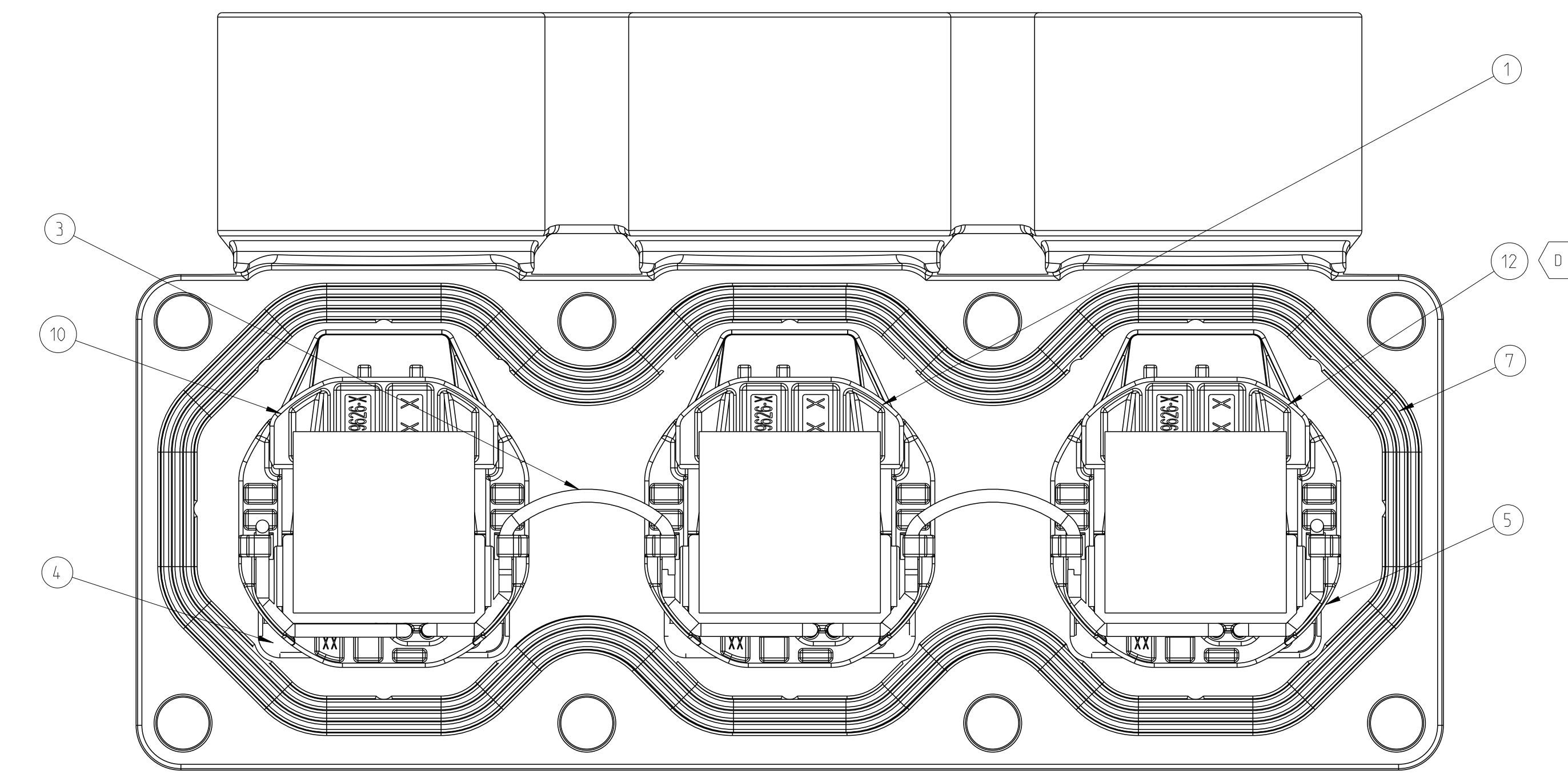

TE-ASSY-NO	TE REV.	CODE	DESCRIPTION	DESCRIPTION	CODE	MATERIAL	SURFACE COLOR/TREATMENT	WEIGHT (g)	QTY	ITEM
2399611-4	D	K/L/M	3POS.PIN DIA 14.0 HDR ASSY.90DEG	CODE HOUSING	M	PA66-GF	AQUA RED	-	1	12
				CODE HOUSING	L	PA66-GF	AQUA BROWN	-	1	11
				CODE HOUSING	K	PA66-GF	AQUA GREEN	(925)	1	10
				FOLLOW 2399611-1	-	-	-	-	1-9	-
2399611-3	D	G/H/J	3POS.PIN DIA 14.0 HDR ASSY.90DEG	CODE HOUSING	J	PA66-GF	ORANGE	-	1	12
				CODE HOUSING	H	PA66-GF	YELLOW	(925)	1	11
				CODE HOUSING	G	PA66-GF	RED	-	1	10
				FOLLOW 2399611-1	-	-	-	-	1-9	-
2399611-2	D	D/E/F	3POS.PIN DIA 14.0 HDR ASSY.90DEG	CODE HOUSING	F	PA66-GF	BROWN	-	1	12
				CODE HOUSING	E	PA66-GF	GREEN	(925)	1	11
				CODE HOUSING	D	PA66-GF	PURPLE	-	1	10
				FOLLOW 2399611-1	-	-	-	-	1-9	-
2399611-1	D	A/B/C	3POS.PIN DIA 14.0 HDR ASSY.90DEG	CODE HOUSING	C	PA66-GF	BLUE	-	1	12
				CODE HOUSING	B	PA66-GF	NATURE	-	1	11
				CODE HOUSING	A	PA66-GF	BLACK	(925)	1	10
				HEADER TPA	-	PA66-GF	RED	-	3	9
				FINGER PROTECTION CAP	-	PA66-GF	BLACK	-	3	8
				FACE SEAL	-	SILICONE	RED	-	1	7
				BUSBAR OVERMOLD,FRONT SIDE	-	-	-	-	3	6
				OUTER HOUSING	-	PA66-GF	BLACK	-	3	5
				INNER HOUSING	-	PA66-GF	BLACK	-	3	4
				HVIL W IRE(LEONI MOCAR 180 E 0.5SDMM.W/HT ACCORDING TO LV112) WITH TERMINAL2	-	-	-	-	2	3
				HVIL W IRE(LEONI MOCAR 180 E 0.5SDMM.W/HT ACCORDING TO LV112) WITH TERMINAL1	-	-	-	-	2	2
				HEADER HOUSING 90DEG.3POS	-	AL-ALLOY	PASSIVATION	(925)	1	1

THIS DRAWING IS A CONTROLLED DOCUMENT. DATE: 29DEC2021. DRAWN BY: S.TAN. CHECKED BY: J.L.L. APPROVED BY: J.L.VIN. PRODUCT SPEC: 3POS.PIN DIA 14.0.HDR ASSY.90DEG HVP-HD1400. APPLICATION SPEC: 114-160222. WEIGHT: SEE TABLE. CUSTOMER DRAWING. SCALE: 2:1. SHEET 1 OF 4. REV. 0.

REVISIONS			
REV	DATE	DESCRIPTION	BY
1	29DEC2021	SEE SHEET 1	

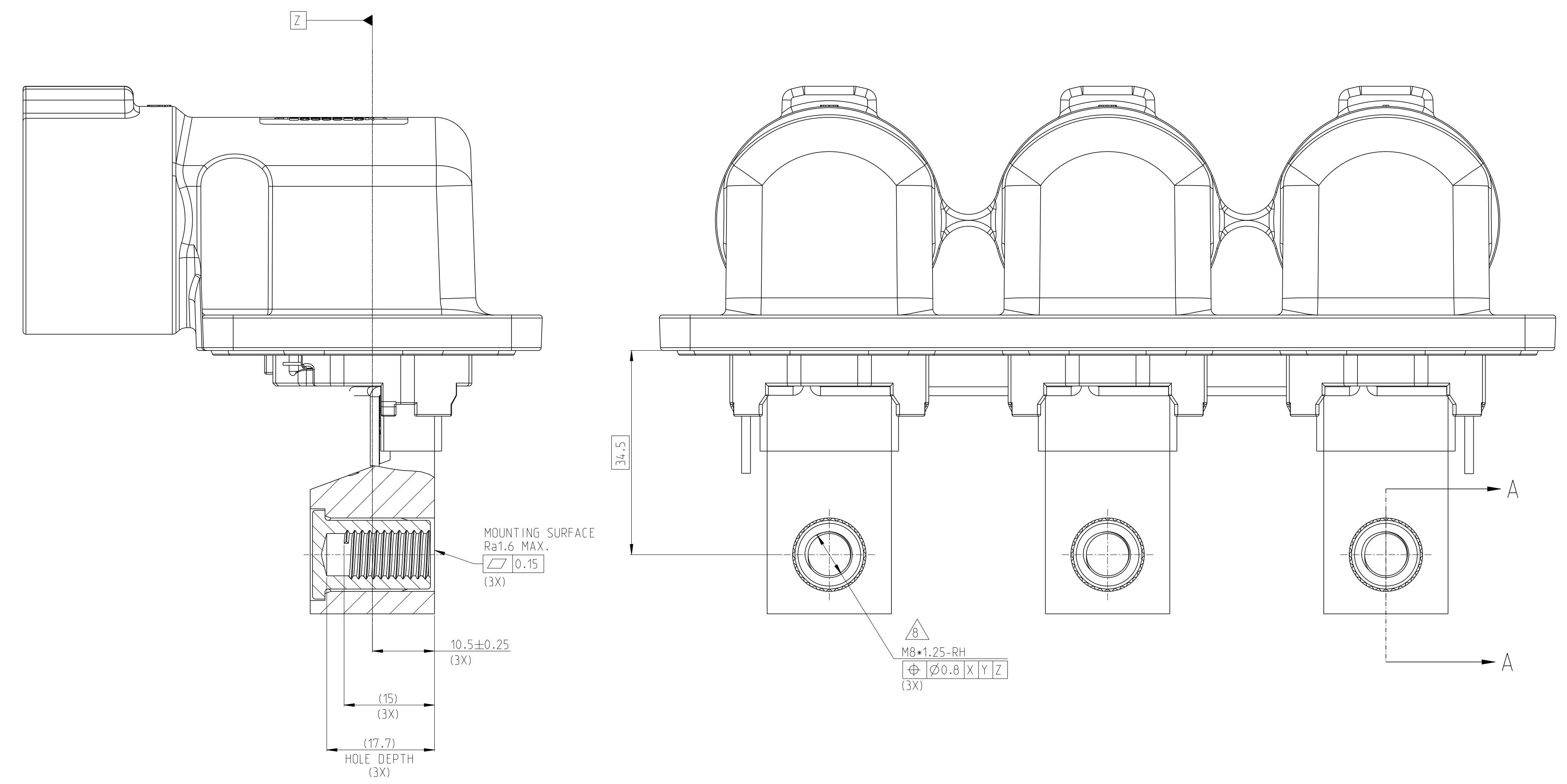

SECTION A-A

1. MISSING DIMENSIONS ACC. TO 2399611-1

TE-ASSY-NO	TE REV.	CODE	DESCRIPTION	DESCRIPTION	CODE	MATERIAL	SURFACE COLOR / TREATMENT	WEIGHT (g)	QTY	ITEM
1-2399611-4	D	K/L/M	3POS,PIN DIA 14.0 HDR ASSY,90DEG	CODE HOUSING	M	PA66-GF	AQUA RED	(925)	1	12
				CODE HOUSING	L	PA66-GF	AQUA BROWN		1	11
				CODE HOUSING	K	PA66-GF	AQUA GREEN		1	10
				FOLLOW 1-2399611-1	-	-	-		-	1-9
1-2399611-3	D	G/H/J	3POS,PIN DIA 14.0 HDR ASSY,90DEG	CODE HOUSING	J	PA66-GF	ORANGE	(925)	1	12
				CODE HOUSING	H	PA66-GF	YELLOW		1	11
				CODE HOUSING	G	PA66-GF	RED		1	10
				FOLLOW 1-2399611-1	-	-	-		-	1-9
1-2399611-2	D	D/E/F	3POS,PIN DIA 14.0 HDR ASSY,90DEG	CODE HOUSING	F	PA66-GF	BROWN	(925)	1	12
				CODE HOUSING	E	PA66-GF	GREEN		1	11
				CODE HOUSING	D	PA66-GF	PURPLE		1	10
				FOLLOW 1-2399611-1	-	-	-		-	1-9
1-2399611-1	D	A/B/C	3POS,PIN DIA 14.0 HDR ASSY,90DEG	CODE HOUSING	C	PA66-GF	BLUE	(925)	1	12
				CODE HOUSING	B	PA66-GF	NATURE		1	11
				CODE HOUSING	A	PA66-GF	BLACK		1	10
				HEADER TPA	-	PA66-GF	RED		3	9
				FINGER PROTECTION CAP	-	PA66-GF	BLACK		3	8
				FACE SEAL	-	SILICONE	RED		1	7
				BUSBAR OVERMOLD, BACK SIDE	-	-	-		3	6
				OUTER HOUSING	-	PA66-GF	BLACK		3	5
				INNER HOUSING	-	PA66-GF	BLACK		3	4
				HVIL W IRE(LEONI) MOCAR 180 E 0.55QMM,WHITE ACCORDING TO LV112) WITH TERMINAL2	-	-	-		2	3
HVIL W IRE(LEONI) MOCAR 180 E 0.55QMM,WHITE ACCORDING TO LV112) WITH TERMINAL1	-	-	-	2	2					
HEADER HOUSING 90DEG,3POS	-	AL-ALLOY	PASSIVATION	1	1					

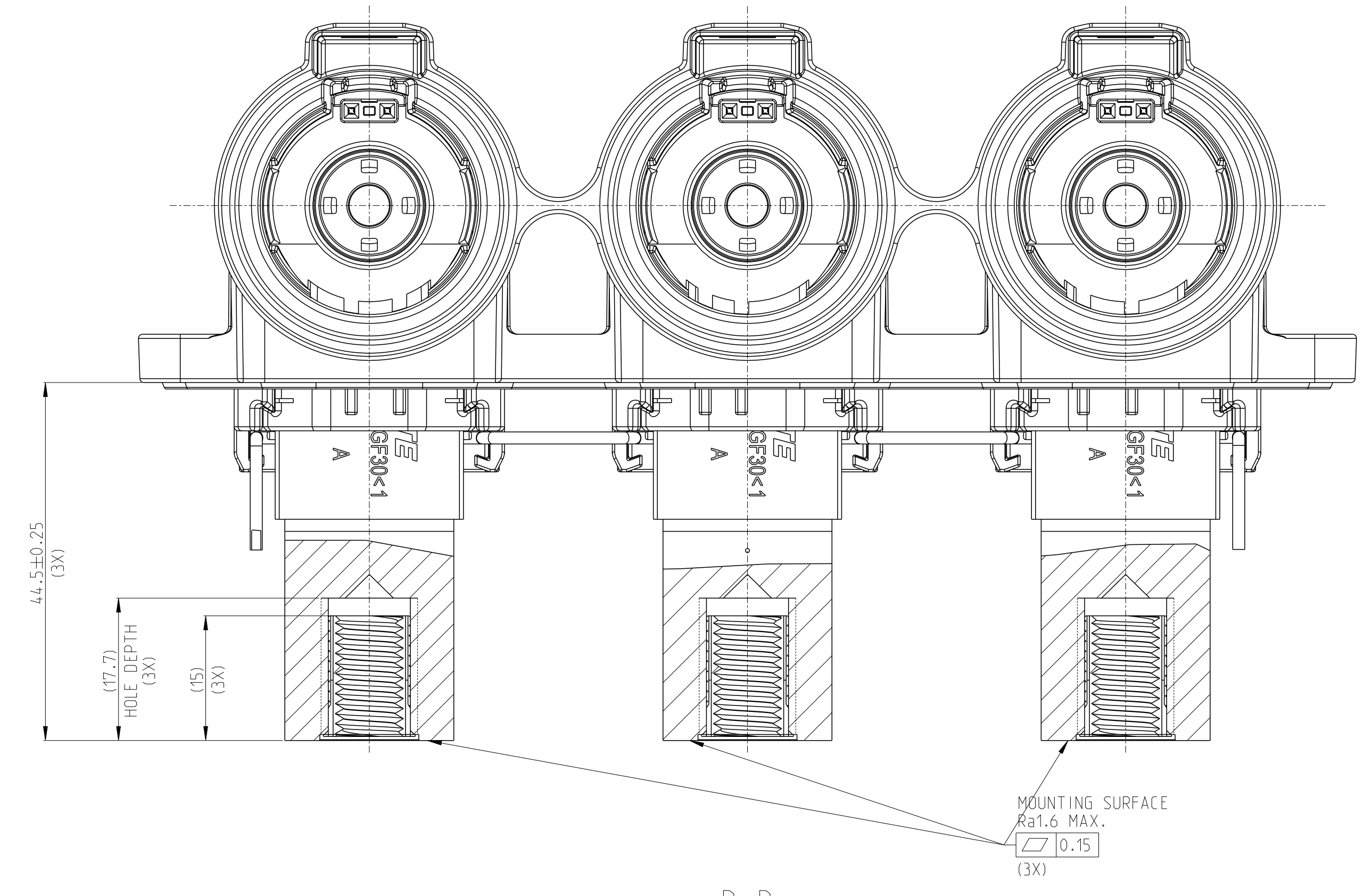

SECTION B-B

1. MISSING DIMENSIONS ACC. TO 2399611-1

TE-ASSY-NO	TE REV.	CODE	DESCRIPTION	DESCRIPTION	CODE	MATERIAL	SURFACE COLOR / TREATMENT	WEIGHT (g)	QTY	ITEM
2-2399611-4	D	K/L/M	3POS,PIN DIA 14.0 HDR ASSY,90DEG	CODE HOUSING	M	PA66-GF	AQUA RED	(925)	1	12
				CODE HOUSING	L	PA66-GF	AQUA BROWN		1	11
				CODE HOUSING	K	PA66-GF	AQUA GREEN		1	10
				FOLLOW 2-2399611-1	-	-	-		-	1-9
2-2399611-3	D	G/H/J	3POS,PIN DIA 14.0 HDR ASSY,90DEG	CODE HOUSING	J	PA66-GF	ORANGE	(925)	1	12
				CODE HOUSING	H	PA66-GF	YELLOW		1	11
				CODE HOUSING	G	PA66-GF	RED		1	10
				FOLLOW 2-2399611-1	-	-	-		-	1-9
2-2399611-2	D	D/E/F	3POS,PIN DIA 14.0 HDR ASSY,90DEG	CODE HOUSING	F	PA66-GF	BROWN	(925)	1	12
				CODE HOUSING	E	PA66-GF	GREEN		1	11
				CODE HOUSING	D	PA66-GF	PURPLE		1	10
				FOLLOW 2-2399611-1	-	-	-		-	1-9
2-2399611-1	D	A/B/C	3POS,PIN DIA 14.0 HDR ASSY,90DEG	CODE HOUSING	C	PA66-GF	BLUE	(925)	1	12
				CODE HOUSING	B	PA66-GF	NATURE		1	11
				CODE HOUSING	A	PA66-GF	BLACK		1	10
				HEADER TPA	-	PA66-GF	RED		3	9
				FINGER PROTECTION CAP	-	PA66-GF	BLACK		3	8
				FACE SEAL	-	SILICONE	RED		1	7
				BUSBAR OVERMOLD, TOP SIDE	-	-	-		3	6
				OUTER HOUSING	-	PA66-GF	BLACK		3	5
				INNER HOUSING	-	PA66-GF	BLACK		3	4
				HVIL W IRE(LEONI) MOCAR 180 E 0.55QMM,WHITE ACCORDING TO LV112) WITH TERMINAL2	-	-	-		2	3
HVIL W IRE(LEONI) MOCAR 180 E 0.55QMM,WHITE ACCORDING TO LV112) WITH TERMINAL1	-	-	-	2	2					
HEADER HOUSING 90DEG,3POS	-	AL-ALLOY	PASSIVATION	1	1					

THIS DRAWING IS A CONTROLLED DOCUMENT.

DATE: 29DEC2021  
 CHK: L.L.  
 APPR: J.V.  
 PRODUCT SPEC: 108-160407  
 APPLICATION SPEC: 114-160222  
 WEIGHT: SEE TABLE  
 CUSTOMER DRAWING

TE Connectivity  
 3POS,PIN DIA 14.0 HDR ASSY,90DEG  
 HVP-HD14.00

SCALE: 2:1  
 SHEET: 2 of 4  
 REV: 0



REVISIONS			
REV	DATE	DESCRIPTION	BY
-	-	SEE SHEET 1	-

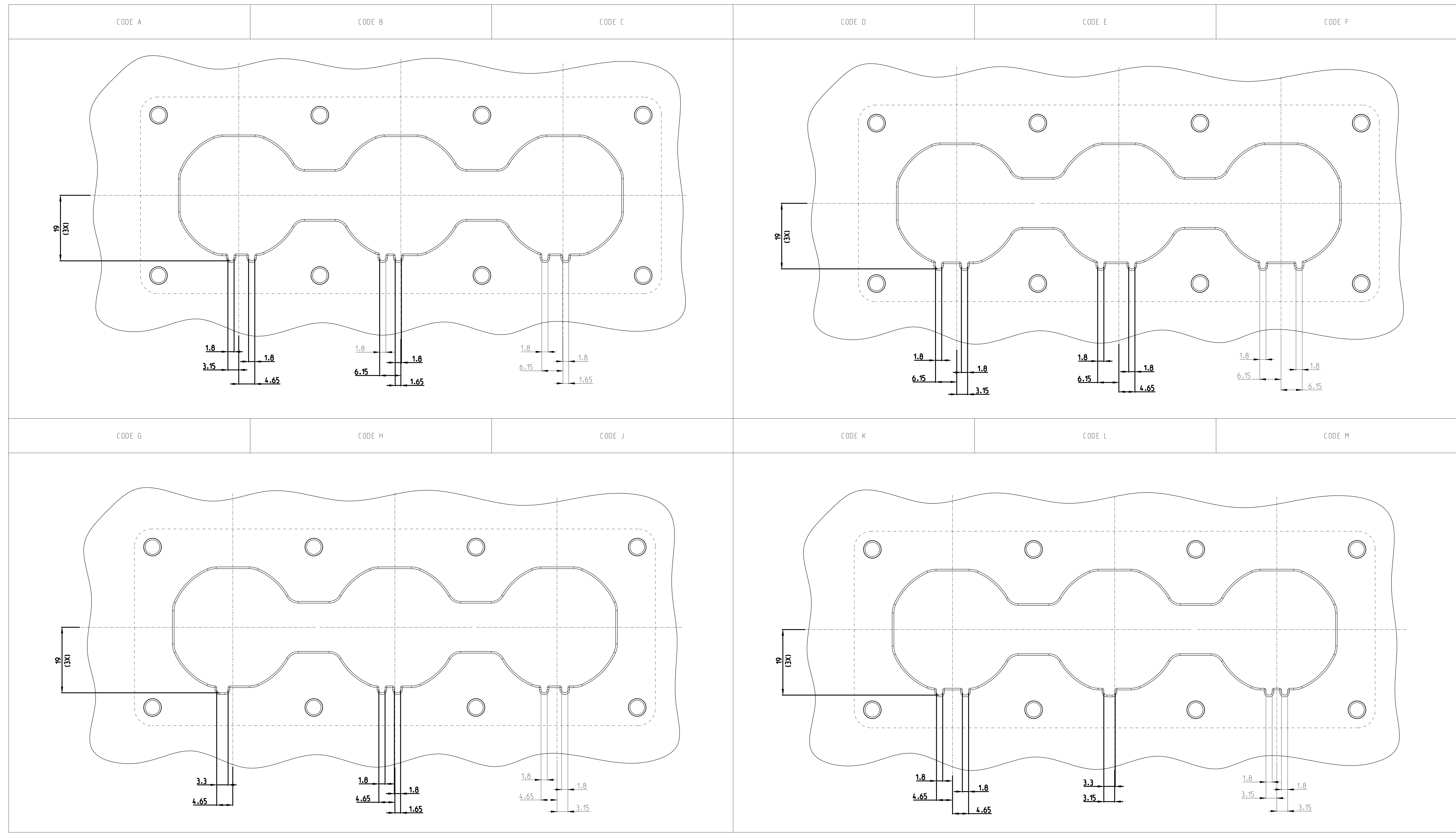

THIS DRAWING IS A CONTROLLED DOCUMENT.

DATE	29DEC2021	BY	S. TAN
CHK	L.L.	APPROV	29DEC2021
REV	1	DATE	29DEC2021
DESCRIPTION	3POS. PIN DIA 14.0.HDR ASSY.90DEG HVP-HD14.00		
PRODUCT SPEC	108-1604.07		
APPLICATION SPEC	114-160222		
WEIGHT	SEE TABLE	SCALE	2:1
MATERIAL	SEE TABLE	CUSTOMER DRAWING	SCALE 2:1 SHEET 4 OF 4 REV D

STC TE Connectivity