

# 1-2007637-5 Product Details

Share | Print | Email

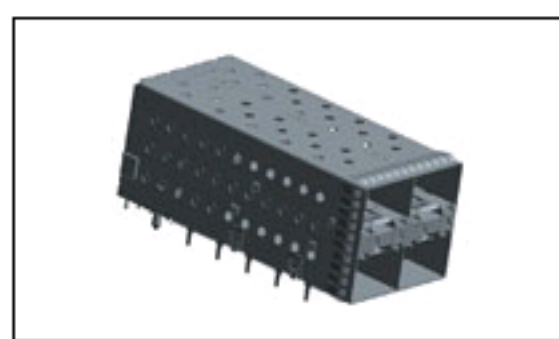

1-2007637-5

TE Internal Number: 1-2007637-5  
Active

## Pluggable Connectors, Cages & Accessories

Always EU RoHS/ELV Compliant (Statement of Compliance)

### Product Highlights:

- SFP+ Product Line
- Cage Assembly with Integrated Connector
- SFP+ Enhanced EMI Application
- Connector Style = Receptacle
- Cage Type = Stacked

[View all Features](#)

### Quick Links

- Pricing & Availability
- Search for Tooling
- Product Feature Selector
- Contact Us About This Product

[Add to My Part List](#) | [Request Sample](#) | [Find Similar Products](#) | [Buy Product](#)

Feedback

Documentation & Additional Information	
<p><b>Product Drawings:</b></p> <ul style="list-style-type: none"> <li>CAGE AND PT CONNECTOR ASSEMBLY, WITH EMI SPRINGS, PR... (PDF, English)</li> </ul> <p><b>Catalog Pages/Data Sheets:</b></p> <ul style="list-style-type: none"> <li>None Available</li> </ul> <p><b>Product Specifications:</b></p> <ul style="list-style-type: none"> <li>SFP+ Stacked Connector and Cage Assemblies (PDF, English)</li> </ul> <p><b>Application Specifications:</b></p> <ul style="list-style-type: none"> <li>Stacked Small Form-Factor Pluggable (SFP+) Connector... (PDF, English)</li> </ul> <p><b>Instruction Sheets:</b></p> <ul style="list-style-type: none"> <li>None Available</li> </ul> <p><b>CAD Files:</b></p> <ul style="list-style-type: none"> <li>None Available</li> </ul>	<p><b>Related Products:</b></p> <ul style="list-style-type: none"> <li>Tooling</li> </ul>

[List all Documents](#)

Product Features (Please use the Product Drawing for all design activity)	
<p><b>Product Type Features:</b></p> <ul style="list-style-type: none"> <li>Product Line = SFP+</li> <li>Product Type = Cage Assembly with Integrated Connector</li> </ul> <p><b>Mechanical Attachment:</b></p> <ul style="list-style-type: none"> <li>PCB Mount = Single Sided</li> </ul> <p><b>Electrical Characteristics:</b></p> <ul style="list-style-type: none"> <li>Data Signal Rate (Gb/s) = Up to 16</li> </ul> <p><b>Termination Features:</b></p> <ul style="list-style-type: none"> <li>Termination Method to PC Board = Through Hole - Press Fit</li> </ul> <p><b>Dimensions:</b></p> <ul style="list-style-type: none"> <li>Tail Length (mm [in]) = 3 [0.118]</li> <li>PCB Thickness, Recommended (mm [in]) = 1.50 [0.059]</li> <li>Length (X-Axis) (mm [in]) = 63.25 [2.490]</li> <li>Width (Z-Axis) (mm [in]) = 28.91 [1.138]</li> <li>Profile Height (Y-Axis) (mm [in]) = 25.50 [1.0039]</li> </ul> <p><b>Body Features:</b></p> <ul style="list-style-type: none"> <li>Integrated Light Pipes = Yes</li> </ul> <p><b>Contact Features:</b></p> <ul style="list-style-type: none"> <li>Contact Plating, Mating Area, Material = Gold or Gold Flash over Palladium Nickel</li> <li>Contact Base Material = Copper Alloy</li> </ul> <p><b>Housing Features:</b></p> <ul style="list-style-type: none"> <li>Connector Style = Receptacle</li> <li>Cage Type = Stacked</li> <li>Housing Material = Liquid Crystal Polymer (LCP)</li> <li>Housing Color = Black</li> <li>Cage Material = Nickel Silver</li> </ul>	<p><b>Configuration Features:</b></p> <ul style="list-style-type: none"> <li>Port Configuration = 2x2</li> <li>Lightpipe = With</li> <li>Lightpipe Configuration = All Four</li> <li>EMI Containment = External Springs</li> </ul> <p><b>Industry Standards:</b></p> <ul style="list-style-type: none"> <li>RoHS/ELV Compliance = RoHS compliant, ELV compliant</li> <li>Lead Free Solder Processes = Not relevant for lead free process</li> <li>RoHS/ELV Compliance History = Always was RoHS compliant</li> <li>UL Flammability Rating = UL 94V-0</li> </ul> <p><b>Conditions for Usage:</b></p> <ul style="list-style-type: none"> <li>Applies To = Printed Circuit Board</li> </ul> <p><b>Operation/Application:</b></p> <ul style="list-style-type: none"> <li>Application = SFP+ Enhanced EMI</li> </ul> <p><b>Packaging Features:</b></p> <ul style="list-style-type: none"> <li>Packaging Method = Box/Carton</li> </ul> <p><b>Other:</b></p> <ul style="list-style-type: none"> <li>Brand = TE Connectivity</li> </ul>

### Corporate Information

- [About TE](#)
- [Investors](#)
- [News Room](#)
- [Supplier Portal](#)
- [Careers](#)
- [Terms & Conditions](#)
- [Privacy Policy](#)

### Quick Links

- [Distributor Inventory](#)
- [Product Cross Reference](#)
- [Documents & Drawings](#)
- [Product Compliance Support Center](#)
- [Site Map](#)

### Customer Support

- [Email or Chat With Us](#)
- [Find a Phone Number](#)
- [Knowledge Base](#)
- [Manage Your Account](#)

### Keep Me Informed

