

THIS DRAWING IS UNPUBLISHED.

RELEASED FOR PUBLICATION

© COPYRIGHT BY -

ALL RIGHTS RESERVED.

LOC DW

DIST -

REVISIONS

P	LTR	DESCRIPTION	DATE	DWN	APVD
E4		REVISED PER ECR-13-019943	28MAR14	S.C.	H.L.

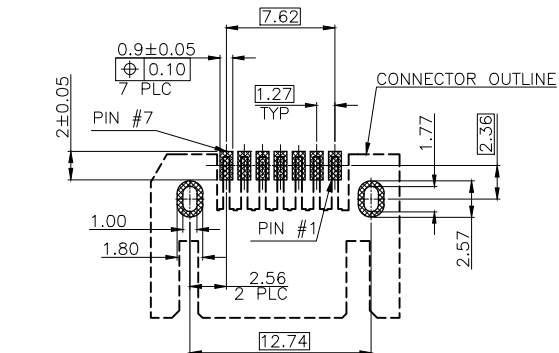
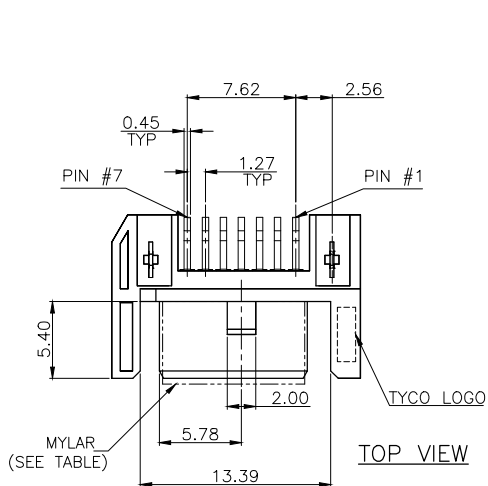

■ SOLDER AREA
 PCB TOLERANCE: ±0.05, THICKNESS: 1.2mm
 RECOMMEND PCB LAYOUT (TOP VIEW)

NOTES:

- MATERIAL:
 HOUSING: LCP WITH 30% GF, UL 94V-0, BLACK COLOR.
 CONTACT: BRASS.
 BOARDLOCK: BRASS.
 MYLAR: PET, LXW=5.8X10.0, T=0.22mm
- FINISH:
 CONTACT: (SEE TABLE) GOLD PLATED ON CONTACT AREA, 2.54µm [100µ"] MIN. MATTE-TIN ON SOLDER TAIL, WITH ENTIRE CONTACT UNDERPLATED 1.27µm [50µ"] MIN. NICKEL.
 BOARDLOCK: 2.54µm [100µ"] MIN. MATTE-TIN PLATING OVER 1.27µm [50µ"] MIN. NICKEL UNDERPLATING OVERALL.
- REFLOW SOLDER CAPABLE TO 260°C PER TEC-109-201, CONDITION B.
- PACKING: (SEE TABLE)

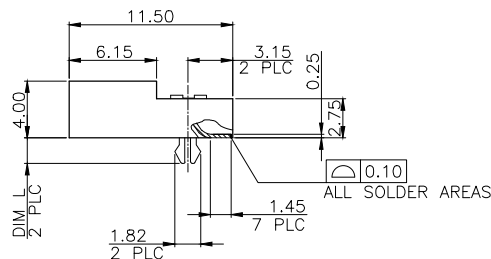
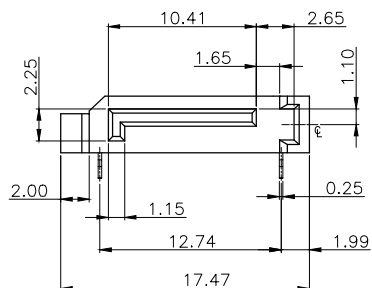
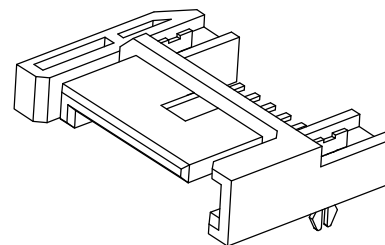

PIN DEFINITION (SIGNAL SEGMENT)		
NAME	TYPE	DESCRIPTION
S1	GND	
S2	A+	DIFFERENTIAL SIGNAL PAIR A
S3	A-	
S4	GND	
S5	B-	DIFFERENTIAL SIGNAL PAIR B
S6	B+	
S7	GND	

DIM L (BOARDLOCK)	MYLAR	PACKAGING TYPE	MIN. GOLD THICKNESS	PART NUMBER
0.90	W	TAPE & REEL (SEE SHEET 3)	GOLD FLASH	1-1734698-4
1.80	W	TAPE & REEL (SEE SHEET 3)	0.762µm [30µ"]	1-1734698-3
1.80	W	TAPE & REEL (SEE SHEET 3)	0.381µm [15µ"]	1-1734698-2
OBSOLETE	W	TAPE & REEL (SEE SHEET 3)	GOLD FLASH	1-1734698-1
OBSOLETE	W/O	TUBE (SEE SHEET 2)	0.762µm [30µ"]	1734698-3
OBSOLETE	W/O	TUBE (SEE SHEET 2)	0.381µm [15µ"]	1734698-2
OBSOLETE	W/O	TUBE (SEE SHEET 2)	GOLD FLASH	1734698-1

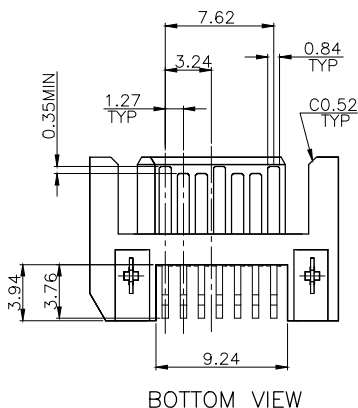

THIS DRAWING IS A CONTROLLED DOCUMENT.		DWN A. WU 19JUN2008		
DIMENSIONS: MM		CHK S. CHIEN 19JUN2008		
TOLERANCES UNLESS OTHERWISE SPECIFIED:		APVD W. KODAMA 19JUN2008	NAME	
0 PLC ± - 1 PLC ± 0.3 2 PLC ± 0.25 3 PLC ± 0.2 4 PLC ± - ANGLES ± 3°		PRODUCT SPEC 108-57469	SERIAL ATA CONNECTOR, 7 POSITION, PLUG, RIGHT ANGLE, SMT TYPE	
MATERIAL SEE NOTE		APPLICATION REVISION	SIZE	CAGE CODE
FINISH SEE NOTE		WEIGHT 0.6 GRAMS	DRAWING NO. A3100779	RESTRICTED TO -
		CUSTOMER DRAWING	©=1734698	SCALE - SHEET 1 of 3 REV E4

THIS DRAWING IS UNPUBLISHED.

RELEASED FOR PUBLICATION

© COPYRIGHT - BY -

ALL RIGHTS RESERVED.

LOC DW

DIST

REVISIONS

P	LTR	DESCRIPTION	DATE	DWN	APVD
		SEE SHEET 1.			

NOTES:

- DIMENSION :
 TUBE: L= 465mm, W= 8.1mm, H= 13.4mm.
 INNER CARTON: L= 485mm, W= 86mm, H= 72mm.
 SHIPPING BOX: L= 500mm, W= 187mm, H= 169mm.
- QUANTITY:
 25 PCS/TUBE.
 25 TUBES/SHEAF.
 2 SHEAFS/INNER CARTON.
 4 INNER CARTONS/SHIPPING BOX.
 5000 PCS/SHIPPING BOX.
- WEIGHT:
 NET WEIGHT: 3 kg
 GORSS WEIGHT: 4 kg

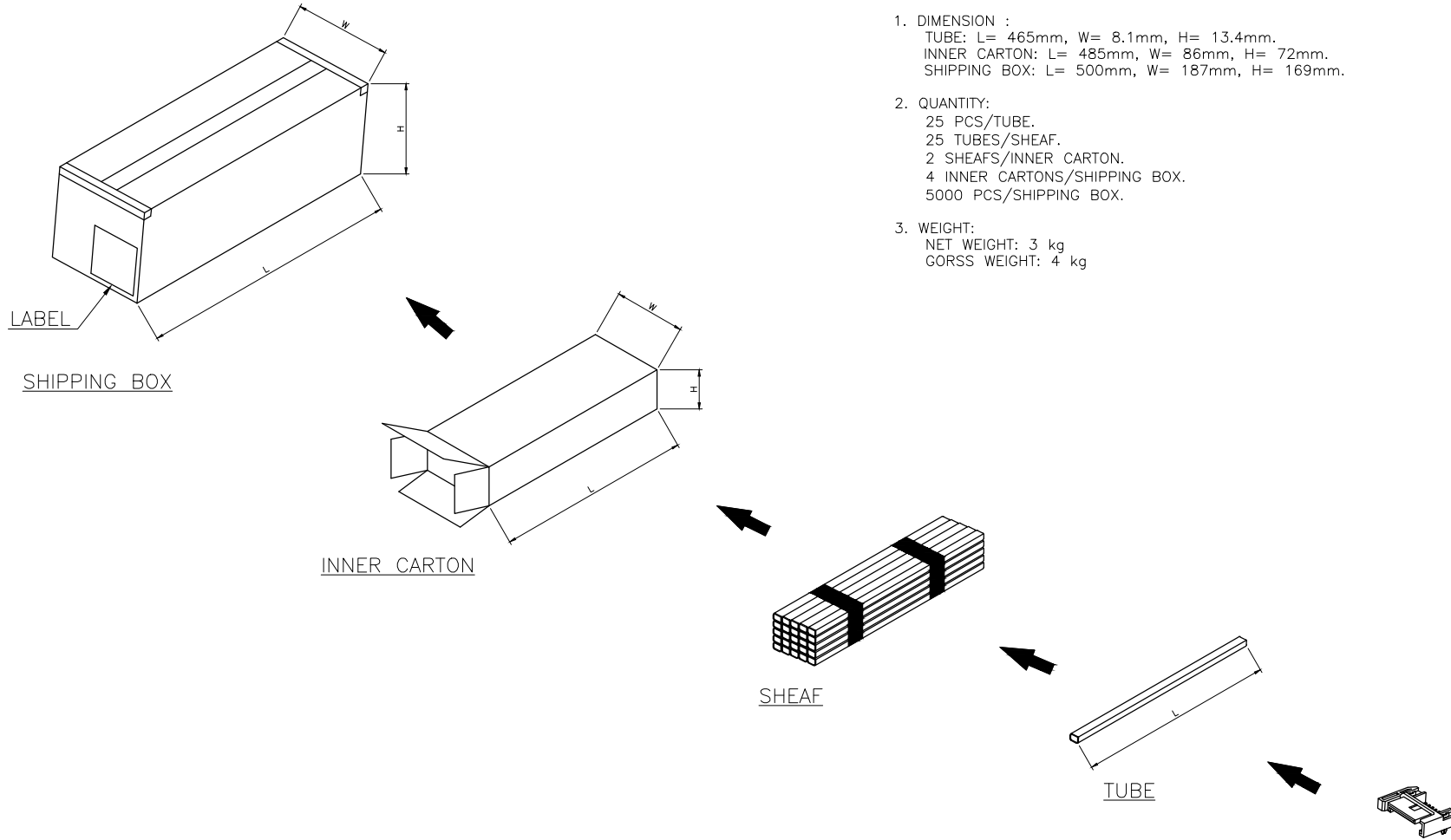

THIS DRAWING IS A CONTROLLED DOCUMENT.		DWN	STE TE Connectivity	
DIMENSIONS: MM		CHK		
TOLERANCES UNLESS OTHERWISE SPECIFIED:		APVD	NAME	
0 PLC ± -		PRODUCT SPEC	SERIAL ATA CONNECTOR, 7 POSITION, PLUG, RIGHT ANGLE, SMT TYPE	
1 PLC ± -		APPLICATION SPEC	SIZE	RESTRICTED TO
2 PLC ± -		WEIGHT	A3	
3 PLC ± -			CAGE CODE	DRAWING NO
4 PLC ± -			00779	C=1734698
ANGLES ± -				
MATERIAL	FINISH	CUSTOMER DRAWING		SCALE
		SHEET 2 of 3		REV E4

THIS DRAWING IS UNPUBLISHED.

RELEASED FOR PUBLICATION

© COPYRIGHT BY ALL RIGHTS RESERVED.

LOC DW

DIST

REVISIONS

P	LTR	DESCRIPTION	DATE	DWN	APVD
		SEE SHEET 1.			

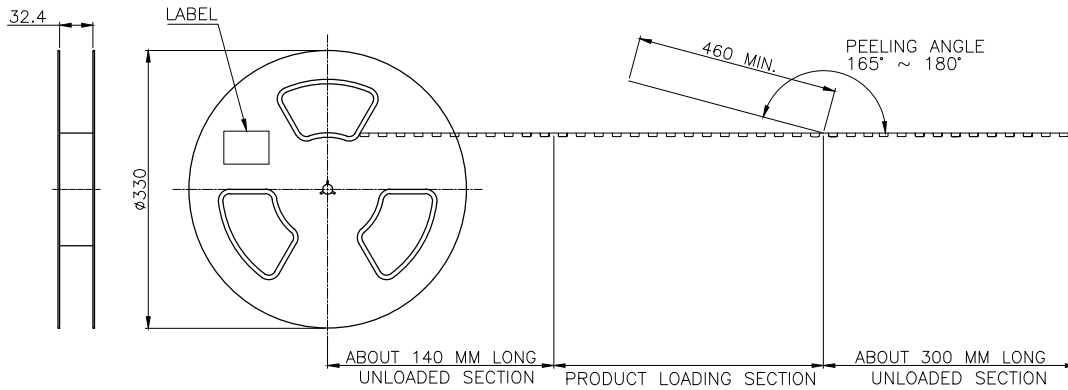

NOTES:

- MATERIAL:
 - EMBOSS CARRIER: PS.
 - COVER TAPE: PS.
 - SHIPPING BOX: CORRUGATED FIBER.
- DIMENSION:
 - REEL: W= 32.0mm.
 - SHIPPING BOX: L= 345mm, W= 345mm, H= 210mm.
- QUANTITY:
 - PRIMARY PACKING: 450 PCS/TAPE.
 - SECONDARY PACKING: 5 REEL/SHIPPING BOX (2250 PCS).
- WEIGHT:
 - NET WEIGHT: 0.27kg/REEL, 1.75kg/SHIPPING BOX.
 - GROSS WEIGHT: 0.72kg/REEL, 4.42kg/SHIPPING BOX.
- PEELING RESISTANCE: 30.0gf~120.0gf.
(PEELING SPEED: 300 mm/min)

USER DIRECTION OF UNREELING

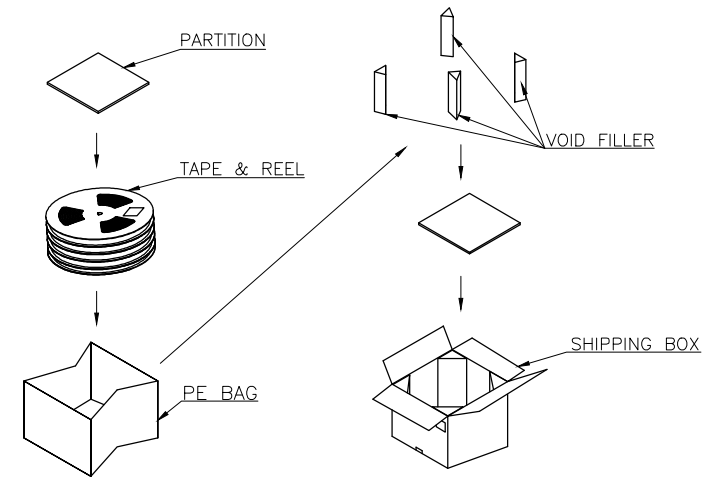
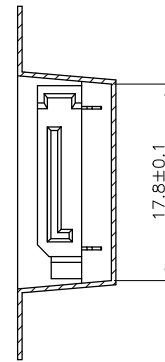
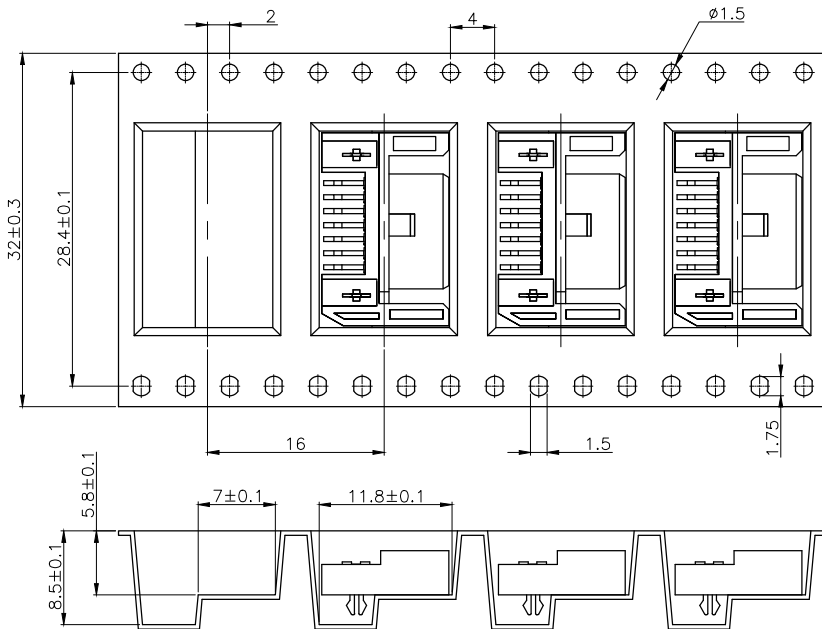

THIS DRAWING IS A CONTROLLED DOCUMENT.		DWN	STE TE Connectivity		
DIMENSIONS: MM		CHK			
TOLERANCES UNLESS OTHERWISE SPECIFIED:		APVD	NAME		
0 PLC ± -		PRODUCT SPEC	SERIAL ATA CONNECTOR, 7 POSITION, PLUG, RIGHT ANGLE, SMT TYPE		
1 PLC ± -		APPLICATION SPEC	SIZE	CAGE CODE	DRAWING NO
2 PLC ± -		WEIGHT	A3	00779	C=1734698
3 PLC ± -			RESTRICTED TO		
4 PLC ± -			SCALE		
ANGLES ± -			SHEET 3 of 3		
MATERIAL			REV E4		
FINISH			CUSTOMER DRAWING		