

DATE	SYM	REVISION RECORD	AUTH.	DR.	CK.
2/11/98	-	ISSUED		NT	MM
4/27/01	A	SHOULDER WIDTH .015±.005 WAS .010		NT	DG
4/30/02	A1	UPDATE PLATING SPEC.		NT	DG

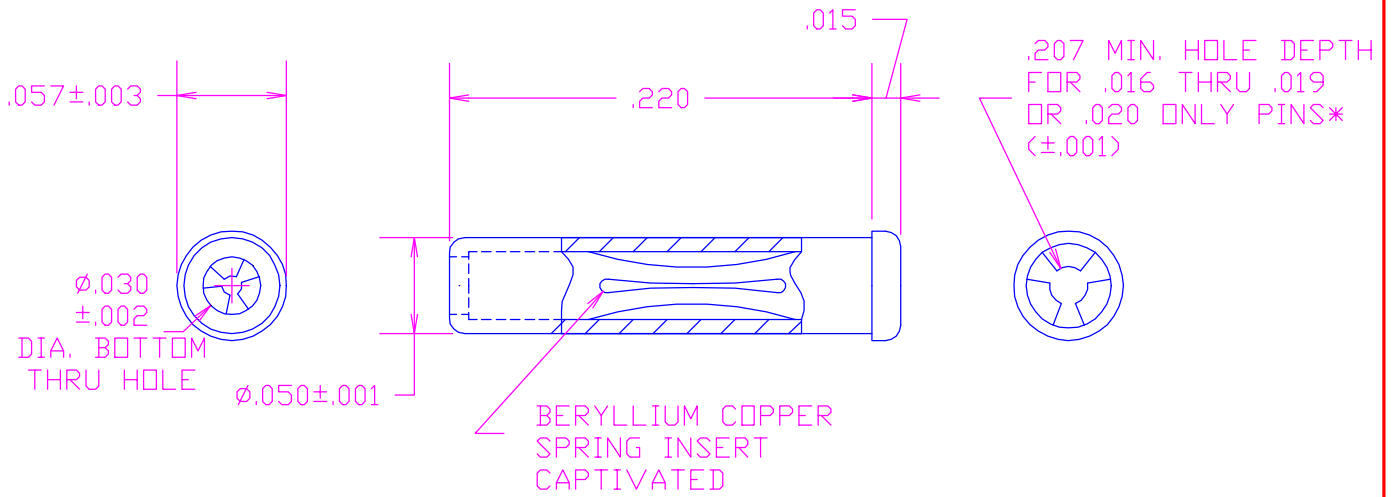

ACCEPTS .016 THRU .019 OR .020 ONLY PINS
 * ONCE AN .020 PIN IS INSERTED, THE USE OF .016 THRU .019 PINS IS NO LONGER RECOMMENDED
 RECOMMENDED MOUNTING HOLE .052±.001 DIA.(#55 DRILL)
 BOARD THICKNESS .031 TO .188

FINISH CODE	COMPONENT	MATERIAL	FINISH
03	BODY	BRASS PER ASTM B16	.000010" GOLD PER ASTM B 488, TYPE 3, CODE C, OVER .0001" NICKEL PER AMS-QQ-N-290
	SPRING	BERYLLIUM COPPER PER ASTM B194	.000030" GOLD PER ASTM B 488, TYPE 3, CODE C OVER .0001" NICKEL PER AMS-QQ-N-290
04	BODY	BRASS PER ASTM B16	.0001" ELECTRO-TIN PER MIL-T-1027 OVER .0001" NICKEL
	SPRING	BERYLLIUM COPPER PER ASTM B194	.0002" BRIGHT ELECTRO-TIN PER MIL-T-1027, TYPE I OVER .000050" NICKEL
06	BODY	BRASS PER ASTM B16	.0001" ELECTRO-TIN PER MIL-T-1027 OVER .0001" NICKEL
	SPRING	BERYLLIUM COPPER PER ASTM B194	.000030" GOLD PER ASTM B 488, TYPE 3, CODE C OVER .0001" NICKEL PER AMS-QQ-N-290

ACTUAL SIZE



TOLERANCES (EXCEPT AS NOTED)	CONCORD ELECTRONICS CORPORATION		
DECIMAL + .010 - .010	P/N	SCALE 10:1	30 GREAT JONES ST. NEW YORK N.Y. 10012
FRACTIONAL + 1/64 - 1/64	TITLE P.C.JACK FOR .016 THRU .019 OR .020 PINS		
ANGULAR + 5° - 5°	DATE 2-7-96	DRAWING NUMBER 09-9026-2-XX	