

Base strip - DFK-MSTB 2,5/ 3-GF - 0710031

Please be informed that the data shown in this PDF Document is generated from our Online Catalog. Please find the complete data in the user's documentation. Our General Terms of Use for Downloads are valid (<http://phoenixcontact.com/download>)



Plug component, Nominal current: 12 A, Rated voltage (III/2): 320 V, Number of positions: 3, Pitch: 5 mm, Connection method: Solder/Slip-on connection, Color: green, Contact surface: Tin, Assembly: Direct mounting

The figure shows a 10-position version of the product

Product Features

- Can be fixed in housing panels up to 6 mm thick using two M3 x 10 screws
- Outside: plug-in connection for corresponding MSTB 2,5 or FKC 2,5 plugs
- Inside: solder or 2.8 mm slip-on plug-in connection that can be combined
- Headers for assembly in a device/housing panel



Key commercial data

| | |
|--------------------------------------|---|
| Packing unit | 1 pc |
| GTIN |  4 017918 005061 |
| Weight per Piece (excluding packing) | 4.8 GRM |
| Custom tariff number | 85366990 |
| Country of origin | Germany |

Technical data

Dimensions

| | |
|-------------|-------|
| Pitch | 5 mm |
| Dimension a | 10 mm |

General

| | |
|-----------------------------|---------------------|
| Range of articles | DFK-MSTB 2,5/...-GF |
| Insulating material group | I |
| Rated surge voltage (III/3) | 4 kV |

Base strip - DFK-MSTB 2,5/ 3-GF - 0710031

Technical data

General

| | |
|---|---------------------|
| Rated surge voltage (III/2) | 4 kV |
| Rated surge voltage (II/2) | 4 kV |
| Rated voltage (III/3) | 320 V |
| Rated voltage (III/2) | 320 V |
| Rated voltage (II/2) | 630 V |
| Connection in acc. with standard | EN-VDE |
| Nominal current I _N | 12 A |
| Nominal cross section | 2.5 mm ² |
| Maximum load current | 12 A |
| Insulating material | PA |
| Inflammability class according to UL 94 | V2 |
| Number of positions | 3 |

Connection data

| | |
|--|---------------------|
| Conductor cross section solid min. | 0.2 mm ² |
| Conductor cross section solid max. | 2.5 mm ² |
| Conductor cross section stranded min. | 0.2 mm ² |
| Conductor cross section stranded max. | 2.5 mm ² |
| Conductor cross section AWG/kcmil min. | 24 |
| Conductor cross section AWG/kcmil max | 12 |

Classifications

eCl@ss

| | |
|------------|----------|
| eCl@ss 4.0 | 272607xx |
| eCl@ss 4.1 | 27260701 |
| eCl@ss 5.0 | 27260701 |
| eCl@ss 5.1 | 27141190 |
| eCl@ss 6.0 | 27260704 |
| eCl@ss 7.0 | 27440402 |
| eCl@ss 8.0 | 27440402 |

ETIM

| | |
|----------|----------|
| ETIM 3.0 | EC001283 |
| ETIM 4.0 | EC001283 |
| ETIM 5.0 | EC001283 |

Base strip - DFK-MSTB 2,5/ 3-GF - 0710031

Classifications

UNSPSC

| | |
|---------------|----------|
| UNSPSC 6.01 | 30211810 |
| UNSPSC 7.0901 | 39121409 |
| UNSPSC 11 | 39121409 |
| UNSPSC 12.01 | 39121409 |
| UNSPSC 13.2 | 39121409 |

Approvals

Approvals

Approvals

CSA / UL Recognized / VDE Gutachten mit Fertigungsüberwachung / cUL Recognized / IECCE CB Scheme / GOST / GOST / CSA / CCA / cULus Recognized

Ex Approvals

Approvals submitted

Approval details

| | | | |
|-----|--------------------|-------|-------|
| CSA | B | D | |
| | Nominal current IN | 15 A | 10 A |
| | Nominal voltage UN | 300 V | 300 V |

| | | | |
|---------------|--------------------|-------|-------|
| UL Recognized | B | D | |
| | Nominal current IN | 15 A | 10 A |
| | Nominal voltage UN | 300 V | 300 V |

Base strip - DFK-MSTB 2,5/ 3-GF - 0710031

Approvals

VDE Gutachten mit Fertigungsüberwachung 

| | |
|--------------------|-------|
| Nominal current IN | 12 A |
| Nominal voltage UN | 250 V |

cUL Recognized 

| | B | D |
|--------------------|-------|-------|
| Nominal current IN | 15 A | 10 A |
| Nominal voltage UN | 300 V | 300 V |

IECEE CB Scheme 

| | |
|--------------------|-------|
| Nominal current IN | 12 A |
| Nominal voltage UN | 250 V |

GOST 

GOST 

CSA 

| | B | D |
|--------------------|-------|-------|
| Nominal current IN | 10 A | 10 A |
| Nominal voltage UN | 300 V | 300 V |

Base strip - DFK-MSTB 2,5/ 3-GF - 0710031

Approvals

| | |
|--------------------------------|-------|
| CCA | |
| Nominal current I _N | 12 A |
| Nominal voltage U _N | 250 V |

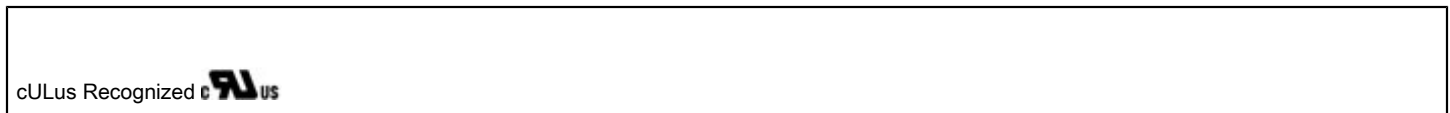

Drawings

Drilling diagram

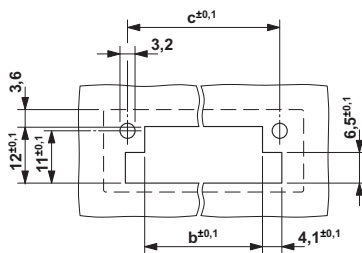

Dimensioned drawing

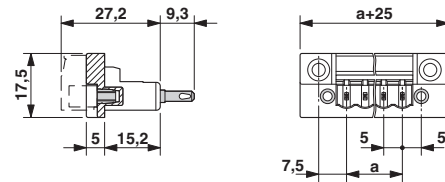

Dimension b: 2.7 mm + (no. of pos. x 5.0 mm)
 Dimension c: Dim. b + 7.3 mm